

国家高新技术企业
江西省固体制剂制造装备工业设计中心
制药固体制剂成套装备及信息系统供应商

National High-tech Enterprise
Jiangxi Solid Preparation Manufacturing Equipment Industrial Design Center
Pharmaceutical Solid Preparation Equipment And Information System Supplier



宜春万申制药机械有限公司

YICHUN WANSHEN PHARMACEUTICAL MACHINERY CO., LTD.

公司地址

COMPANY ADDRESS

江西宜春市经济技术开发区春风路28号
NO.28 Chunfeng Road, Yichun Economic & Technological
Development Zone, Jiangxi Province, China
www.wonsen.com.cn

国内业务部

DOMESTIC BUSINESS DEPARTMENT

Tel: 0086-795-2197988
Mobile: 0086-13617058788
E-mail: xiaoshou@wonsen.com.cn

国际业务部

INTERNATIONAL BUSINESS DEPARTMENT

Tel: 0086-795-2196639
Mobile: 0086-15207950627
E-mail: sales@wonsen.com.cn

售后服务部

AFTER SALES SERVICE

Tel: 0086-795-2197988
Fax: 0086-795-2197987

◆万申企业 (WONSEN ENTERPRISE)版权所有
◆采用生态纸印刷 ADOPT THE ECOLOGICAL PAPER FOR PRINTING

万申企业



宜春万申制药机械有限公司
制药固体制剂成套装备解决方案

WONSEN ENTERPRISE

Pharmaceutical solid preparation equipment solutions

Wonsen 万申企业



万申企业 WONSEN ENTERPRISE

现代工业园
Modern industrial park

企业简介

BRIEF INTRODUCTION

宜春万申制药机械有限公司成立于2010年9月，是一家专注于制药装备及智能信息系统研发、制造、销售、服务于一体的国家级高新技术企业。万申为全球客户提供片剂、胶囊剂、颗粒剂、粉体等固体制剂成套装备和信息系统集成解决方案，是国内制药装备+互联网技术应用的开拓者和践行者，现已成为国内重要的固体制剂装备和智能信息系统产业基地。

公司占地面积93000平方米(其中建筑面积60000平方米)，拥有行业领先的工业设计中心和按欧盟GMP标准建设的数字化试验体验中心，并先后与浙江大学、湖南大学、江西中医药大学、南昌大学开展产学研合作。万申不断探索制药固体制剂未来发展的关键技术与突破装备制造的瓶颈问题，引领国内固体制剂装备及互联网技术应用赶超世界先进水平。

公司实施智能信息化管理和精益生产现场管理，弘扬“以人为本、自强不息、唯实创新、不断超越”的企业精神，倡导“追求高品质，为客户创造价值，为公司创造效益”的经营理念，秉承“勤勉、务实、守信、图强”的企业作风，致力于将万申企业打造具有国际领先水平的百年企业集团。

Yichun Wanshen Pharmaceutical Machinery Co., Ltd. was founded in September 2010. Wonsen are the state-level high-tech enterprise, specializing in the research, development, production, sales and service of pharmaceutical equipment and intelligent information system. It provides the global customers with turn-key solution of solid dosage equipment and information management system to make powder, granule, capsule, tablet, etc. Wonsen takes the initiative to combine the solid preparation equipment with the Internet technology. And now Wonsen has become an important industrial base for solid preparation equipment and intelligent information system in China.

Our company covers an area of 93,000 square meters, including construction area of 60,000 square meters, with industry-leading industrial design centers and digital test experience centers built according to EU GMP standard. It has successively cooperated with Zhejiang University, Hunan University, Jiangxi University of Traditional Chinese Medicine and Nanchang University. Wonsen constantly explores the key technologies and breaks through the equipment bottlenecks in the future development of pharmaceutical solid preparations. It aims to lead domestic solid preparation equipment and Internet technology applications to catch up with the world's advanced level.

Our company takes intelligent information management and lean production site management, carries forward the enterprise spirit of "being humanistic, unrelenting, pragmatic, innovative, and keeping exceeding", and advocates the business philosophy of "pursuing high quality, creating value for customers and creating benefits for our company". Adhering to the enterprise style of diligence, pragmatism, trustworthiness and striving for success, Wonsen is committed to build a century-old enterprise group up to international leading level.



万申企业 WONSEN ENTERPRISE

丰富的经验
专业的技术
提供全方位的服务
为您解决一切难题

Experienced
Professional
All-round service
Problem solver

办公环境

OFFICE ENVIRONMENT

为员工提供创造财富和幸福生活的平台；尊重每一位员工，坚持人才是公司第一财富的理念；以业绩为导向，通过公平、公正的竞争，帮助员工实现自我价值；以人性化的企业管理、良好的企业文化形态，营造充满和谐友爱的工作氛围。

Wonsen offers employees a platform for creating wealth and happy life. Wonsen respects every employee and holds the concept that talents are the first wealth of our company. Oriented by performance, Wonsen helps employees realize self-value through fair and just competition. Wonsen has created a harmonious and friendly working atmosphere with humanistic enterprise management and sound corporate culture.





企业资质和荣誉

ENTERPRISE HONORS



国家高新技术企业
国家两化融合管理体系认证
国家科技部中小企业技术创新承担单位
中国中药设备工程技术委员会副理事长单位
国家制药装备行业协会成员
江西省重大科研专项承担单位
江西省固体制剂制造装备工业设计中心
江西省制药固体制剂装备工程技术研究中心
江西省中药固体制剂装备工程研究中心
江西省服务型制造示范企业

中药固体制剂制造智能化信息管理解决方案示范单位
江西省重点创新产业化升级工程项目
浙江大学自动化制药装备联合研究中心
湖南大学江西省高效节能制药装备对外联合研究中心
江西中医药大学现代中药智能制药装备联合实验室
江西省双千计划创新领军人才项目单位
江西省科学技术发明奖
宜春市科学技术发明奖
中国制药装备行业协会技术创新奖
江西省名牌产品

万申企业 WONSEN ENTERPRISE

诚信构建和谐
诚信取得荣誉

Sincerity constructs harmony
and wins honors.

创新团队 INNOVATIVE TEAM

创新是企业生存和发展的源动力，是万申企业文化精神的基石。万申企业一贯努力建设创新环境，引进竞争机制，增强员工创新意识，不断提高员工创新能力。企业重视信息导向，将新知识高科技应用于产品改造与技术革新，研发能力日益增强，新产品、新工艺层出不穷，企业活力充沛，生机无限。与此同时，创新不仅仅停留在产品层次，因为我们深深懂得产品只是客户需求的一部分，绝不是全部！因此，我们致力于管理制度改革与服务模式更新，规范管理制度，重视项目的每一个环节与细节。

Innovation is the engine for survival and development of enterprise and is the base of corporate cultural spirit of Wonsen. Wonsen is always striving to build an innovative environment, introduce a competition system, enhance innovative conception and improve innovative ability of employees. Our enterprise pays much attention to information orientation, and applies new knowledge and advanced technology into updating product. The research and development ability has been increasingly enhanced, and Wonsen has been more vigorous with new products and technology emerging. Furthermore, innovation does not merely rest on the product level, because Wonsen knows deeply that the product is only one part, not all of customer requirements! Therefore, we have been devoted to the management system reform and service mode renovation to standardize the management system and focus on every chain and detail of projects.

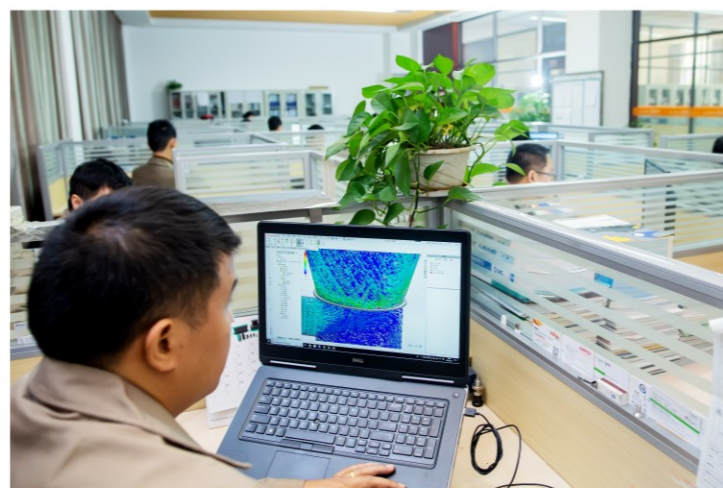

万申企业 WONSEN ENTERPRISE

工程师为整个行业
创造核心技术同时
提供更多解决方案

The engineers are providing more solutions while creating core technologies for the industry.

销售团队

SALES TEAM

销售中心拥有一支高素质的、具有团队精神的专业服务队伍，并按照现代企业制度的要求，建立了高效运作的组织机构。面向二十一世纪，销售中心将全面导入CS(顾客满意)系统，以更完善的管理和服务体系，以顾客满意度作为衡量我们工作的标准，竭诚为国内外客商、用户提供最优质的服务。

Wonsen sales center has a contingent of professional service personnel who are well-trained teamwork players. Furthermore, we have also established organizations running in a highly efficient way according to the modern enterprise system. Facing the 21st century, our sales center will fully introduce the CS (customer satisfaction) system and sincerely provide the most excellent service for merchants and users at home and abroad with perfect management and service systems by regarding customer satisfaction as the standard of evaluating our work.



万申企业 WONSEN ENTERPRISE

销售团队协作
缔造完美品质
Good teamwork leads
to exquisite product

员工风采

VERSATILE STAFF



万申企业 WONSEN ENTERPRISE

管理是企业的灵魂
人才是企业的根本

Management is the soul of Wonsen,
and talents are the foundation of it.



完善的制度，高效、严谨的运行机制，是公司良好的管理决策和稳健的业务发展的坚实基础。多年来，员工各种行为规范、准则不断提高，企业管理向科学化、正规化、专业化的层次迈进。目前，企业拥有一大批能适应现代企业管理和生产需要的高素质员工，为企业今后的发展打下了坚实的基础。

The perfect system, highly efficient and strict operation system are the solid foundation for sound management decision and stable business development of our enterprise. Over the years, the behavior standards and rules of employees are continuously improving, and the enterprise management is moving towards a scientific, standard and professional level. Now, our company has a contingent of well-trained employees who can meet the needs for modern enterprise management and production, laying a firm foundation for future development of our company.



生产车间 WORKSHOP

严格实行车间现场管理和6S定位规定，遵守各项安全生产操作规程，成为万申的发展动力。万申日益加强核心技术的研发和创新，不断追求卓越，精益求精，以先进的生产设备，严格的质量管理体系，精密的生产检测流程，保证了每一款产品的优良性能。

The strict workshop site management, 6S location management and various operation rules for safe production have become driving force for the development of Wonsen. Wonsen are continuously intensifying the research, development and innovation of core technology, pursuing prominence and keeping improving, ensuring the excellent performance of every single product by advanced production equipment, strict quality control and precise production and inspection procedures.

精益管理 Lean management





万申企业 WONSEN ENTERPRISE

雄厚的技术
精良的装备
Strong technology and
exquisite equipment

生产设施

PRODUCTION FACILITIES

市场竞争的基础，离不开生产实力，离不开完善的硬件设施和先进的管理理念。深知硬件和软件的重要性的万申，在同行业率先引进国内外先进生产设备和ISO9001质量管理体系认证，生产出符合FDA、CGMP、GMP标准的高端优质产品，完全满足并引领工业现代化的需求。

Market competition is closely associated with production strength, state-of-the-art hardware facilities as well as advanced management philosophy. Deeply understanding the importance of hardware facilities, Wonsen took the lead among its peers in introducing advanced production equipment at home and abroad and ISO9001 quality management system, so as to produce high quality products conforming to FDA, CGMP and GMP standards and fully meet the requirements for industrial modernization.



合作交流

COOPERATION AND EXCHANGES

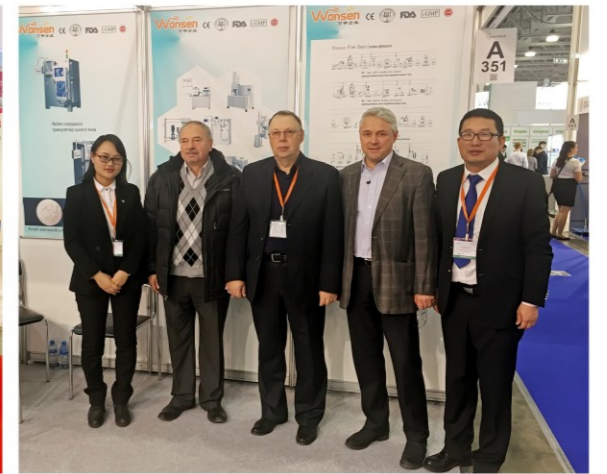

万申企业经过多年的发展，累积了众多的人才与丰富的经验，专业的技术和精细的品质也吸引了大量的国内外客商。在与他们合作交流中，万申更多的意识到品质精于微、服务极于细的重要性，合作的过程也是万申学习、成长的过程，我们力求做到更好！

Wonsen has accumulated a large number of talents and abundant experience after many years of development. With professional technology and exquisite quality, Wonsen has attracted many domestic and overseas customers. During the cooperation and communication with them, Wonsen has become more aware of the importance of excellent quality and considerate service. The process of cooperation is also a process of accumulating our experience of growing and learning. Wonsen are striving to be better.

万申企业 WONSEN ENTERPRISE

万申是您最值得
信赖的合作伙伴

Wonsen is your most
trustworthy partner



客户案例

CUSTOMERS

广大忠实的客户，是万申企业赖以生存的基石。“诚实、守信、开拓、进取”是万申企业信奉的经营理念，与客户共同进步则是我们追求的目标。多年来，本公司始终坚持灵活多样的市场营销策略，积极开展以客户为中心的营销策划工作，实施地区销售战略。

Faithful customers are the base for Wonsen to survive. "Being sincere, faithful, pioneering and enterprising" is the marketing concept Wonsen always abides by, and it is our goal to seek for mutual progress with customers. Over the years, by consistently adhering to diversified marketing strategies, Wonsen is actively developing marketing activities revolving around customers and executing the regional sales strategy.

工程案例

ENGINEERING CASES

万申提供一流的专业工程安装经验和管理经验，本着精益求精的工作态度，为用户提供良好的售后服务，竭诚满足用户的需求。专业人员是良好服务的基础，我们的专业人员具备设备使用及维护的实际经验及系统培训，真正掌握了专业知识和现场处理方法。

Wonsen provides top-ranking professional project installation experience and management experience. By holding the work attitude of keeping improving, Wonsen provides users with good after-sales service and meets customer requirements. Professional personnel are the guarantee for good service. Our professional personnel have practical experience in equipment use and maintenance and receive systemic trainings, mastering professional knowledge and site treatment modes.



PROCESS FLOW CHART

万申企业 WONSEN ENTERPRISE

科学/专业/精雕细琢
完美演绎每一道工序

Scientific, professional and elaborate
manufacturing is perfectly expressed
in every procedure.

湿法制粒生产线
Wet type granulation production line

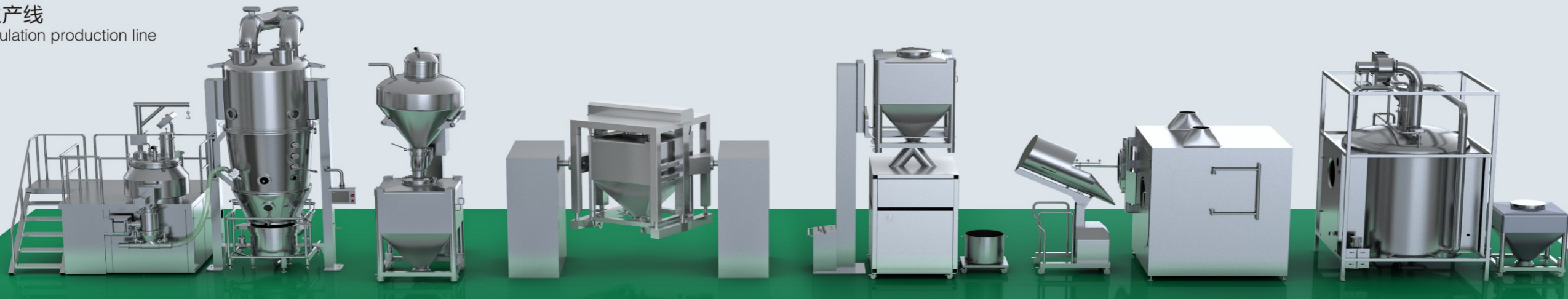

干法制粒生产线
Dry type granulation production line



无尘配料生产线
Dust-free batching production line



PRODUCT CONTENTS

固体制剂制粒生产线 Solid preparation granulation production line

28 密闭制粒线 Closed granulation line

湿法系列 Wet type series

- 30 SHLG 高位湿法混合制粒机 High shear wet type granulator
- 32 SHL 湿法混合制粒机 Wet type granulator
- 34 SHLS 实验型湿法混合制粒机 Laboratory wet type granulator

流化床系列 Fluidized bed series

- 36 FL 沸腾制粒机 Fluid bed granulator
- 38 FG 沸腾干燥机 Fluid bed dryer
- 40 DPL 多功能流化床 Multifunctional fluid bed granulator
- 42 DPLS 实验型多功能沸腾制粒机 Laboratory multifunctional fluid bed granulator

整粒系列 Cone mill series

- 44 JTZ 提升翻转整粒机 Lifting turnover dry mill
- 46 ZLZ 提升真空整粒机 Lifting vacuum dry mill
- 48 FZM 门式整粒机 Grinding dry mill

干法系列 Dry method series

- 50 LG 干法制粒机 Roller compactor



混合系列 Blender series

- 52 ZTH 全自动提升混合机 Automatic lifting bin blender
- 54 HLT 单立柱提升料斗混合机 Single-column lifting bin blender
- 56 HF 方锥混合机 Square cone blender
- 58 HLS 实验型料斗混合机 Laboratory bin blender

包衣系列 Coating series

- 60 BGB-F 新型高效包衣机+片剂翻斗加料机 High-efficiency coating machine + tablet tipping feeder
- 62 BGB-D 高效包衣机 Auto coating machine with CIP
- 64 BGB-C 高效包衣机 Auto coating machine
- 66 BGB-F 实验型包衣机 Laboratory coating machine
- 68 BGB-M 高密闭包衣机 Containment coating machine
- 70 WH 全自动丸化包衣机 Automatic pill coating machine

提升系列 Lifting series

- 72 ATG 全自动提升加料机 Automatic lifting feeder
- 74 YTG 固定提升机 Fixed lifting machine
- 76 YTY 移动提升机 Moveable lifting machine
- 78 CT 层间提升机 Lifting machine among floors

清洗系列 Cleaning series

- 80 ZLXHD 多功能料斗清洗机 Multifunctional bin cleaning machine
- 82 ZLXHS 双腔料斗清洗机 Double chamber bin cleaning machine
- 84 QXY 移动清洗机 Moveable cleaning machine
- 86 ZQX 在线清洗系统 CIP Cleaning system

料斗系列 Bin series

- 88 周转料斗 IBC bins
- 89 配件 Accessories

密闭制粒线
Closed granulation line

用途

密闭制粒线主要应用在制药、食品、化工等行业的粉体制粒，可以抑制物料在转序的过程中产生的粉尘外泄和污染，对人和环境造成威胁。采用密闭输送的方式保证了制粒、干燥、整粒工艺的输送效率更加的科学和合理，减少了设备的占用空间，使生产工艺更加符合GMP要求。

Application

The Closed granulation line is mainly used in the powder granules of the pharmaceutical, food, chemical and other industries, which can inhibit the dust leakage and pollution generated during the process of material transfer, posing a threat to people and the environment. The closed conveying method ensures that the conveying efficiency of granulation, drying and granulation process is more scientific and reasonable, reduces the space occupied by the equipment, and makes the production process more applicable to the GMP requirements.

特点

密闭制粒线充分考虑系统之间设备的配套性，可根据用户实际产能及剂型设计，使整个工序产能达到最佳的合理配置，以保证生产的连续性和稳定性。通过工业平板电脑控制系统可对工艺数据分别进行储存、采集与打印，集中式控制多台设备的参数设定与监控，实时反映工作状态、数据统计，故障自诊断，使得工艺过程完全自动化、智能化，保证工艺的稳定性。

设备可独立操作，亦可系统操作，实现设备的最优的参数化工艺控制，减少停顿及滞留时间，设备的智能配合让制粒过程最佳程度，从而得到高效的制粒成品率和一致性。可根据用户需求设置自动伸缩清洗喷头，使CIP在位清洗得到可靠保证。

Features

The Closed granulation line fully considers the compatibility of the equipment between the systems. According to the actual production capacity and dosage form design of the user, the production capacity of the whole processes can be optimally configured to ensure the continuity and stability of production. By the industrial tablet computer, automation control system can store, collect and print the process data separately, centrally control the parameter setting and monitoring of multiple devices, reflect the working status, data statistics and fault self-diagnosis in real time, making the process more stable, fully automated and intelligent.

The equipment can be operated independently or controlled by system to realize the optimal parameterized process control of the equipment, reducing the pause and dwell time, and the intelligent cooperation of the equipment makes the granulation process optimal, thus obtaining efficient granulation yield and consistency. Automatic telescopic cleaning nozzles can be set according to user requirements, so that CIP cleaning can be reliably guaranteed.

工作原理

- ▲控制过程
基于先进的工业平板电脑自动化控制，提供了成套过程控制及各类参数控制，包括图形操作界面、在线监控、趋势图表、配方处理、批量管理、条码处理、CIP控制、自诊断处理。按照行业标准通讯网络协议控制策略和工厂范围的监控系统，管理系统完全兼容。
- ▲过程分析
FDA的PAT(过程分析技术)能够将其设备的设计功能和工艺工程专业知识结合起来，将在线(PAT)分析仪集成到系统中，从而能够真实的了解过程的运行，帮助客户实现关键产品品质目标，以便可以主动控制产品的关键质量特征。
- ▲密闭控制
独特的密闭控制在于整合稳定的密闭技术对药品固体制剂设施完整的解决方案，密切关注质量和GMP标准应用于客户现场，为各种规格和复杂项目提供定制的高效解决方案。
- ▲安全与环境
为了完全符合国家、地方的各类法规，对于排放控制，以及溶剂的回收系统，出口过滤器和全密闭设备，可根据需要提供符合防爆和抗压标准的设备。

Work principle

- ▲Process control
Based on advanced industrial tablet computer automation control, it provides complete process control and various parameter control, including graphical operation interface, online monitoring, trend chart, recipe processing, batch management, barcode processing, CIP control, and self-diagnosis processing. The management system is fully compatible according to industry standard communication network protocol control strategy and factory-wide monitoring system.
- ▲Process analysis
FDA's PAT (Process Analysis Technology) combines the design capabilities of its equipment with process engineering expertise to integrate an online (PAT) analyzer into the system to provide a true understanding of the process and help customers achieve key product quality objective so that you can actively control the key quality characteristics of your product.
- ▲Closed control
The unique Closed control consists of integrating stable sealing technology into a complete solution for pharmaceutical solids facilities, closely monitoring the quality and GMP standards applied to the customer's site, providing customized and efficient solutions for a wide range of specifications and complex projects.
- ▲Safety and environment
In order to fully comply with national and local regulations, for emission control, as well as the recycling the solvent, the exit filter and the fully enclosed equipment can be provided as needed according to the explosion-proof and anti-pressure standards.

技术参数 Technical parameter

项目 Item	型号 Model	60	120	200
生产能力 Production capacity (kg/批batch)		15-60	50-120	120-200

注：本公司可按用户要求定制生产
Note: Our company can customize products according to user requirements.



SHLG 高位湿法混合制粒机
High shear wet type granulator



用途

此设备是制药工业固体制剂生产中普遍使用的工艺设备之一。它具有混合、制粒等多种功能，广泛应用于制药、食品、化工等行业。

工作原理

物料通过真空上料机或提升上料机加入到制粒锅内，经过搅拌桨离心力作用，压力供液系统将粘合剂通过喷枪注入，同时切割刀高速旋转，物料在锅中凝结成空心颗粒，制粒结束后出料到下一工序（整粒或干燥）。

Application

The machine is a process machine widely applied for solid preparation production in the pharmaceutical industry. It has such functions as mixing, granulating, etc. It has been widely used in such industries as medicine, food, chemical industry, etc.

Work principle

The materials are fed into the mixing vessel through the vacuum feeder or lifting feeder. Through rotation and push by the mixing paddle at the bottom, they first move under a fluidizing status and get sufficient mixing. Then the adhesive is injected through the pressure spray gun to turn the dry powders into wet and soft materials. Meanwhile, they are made into even wet granules under the double actions of the mixing paddle and the high-speed cutter on the side wall. After granulation, the materials are discharged to the next procedure (milling or drying).

特点

- ▲整机采用优质不锈钢制造；
- ▲设有特制搅拌桶，锥柱复合型结构，内壁转角光滑过渡，镜面抛光，不沾料，易清洗；
- ▲物料在密闭搅拌桶中，一步即可完成混合制粒工序；
- ▲采用PLC控制，搅拌制粒电机变频调速，全部操作分手动和自动；
- ▲装有联锁保护装置，操作更安全；
- ▲配有打印机，可自动打印所有工艺参数，原始记录与实际相符；
- ▲可配湿法整粒机和摇摆颗粒机，与沸腾干燥机连线，组成全封闭的制粒生产线。

Features

- ▲The whole machine is made of high quality stainless steel.
- ▲It is provided with special mixing barrel and conical column of a compound structure. The corners on the inner wall are subjected to smooth transition and mirror polishing with easy cleaning and without material sticking.
- ▲The mixing and granulating procedure can be completed in one step with the materials in the closed mixing barrel.
- ▲It adopts PLC control. The mixing and granulating motors are subjected to variable frequency speed adjustment. All operations can be carried out automatically or manually.
- ▲It is provided with interlocking protection device to ensure safer operation.
- ▲It is equipped with printer to automatically print all process parameters, with the original records conforming to the actual ones.
- ▲It can be equipped with wet type milling machine and swing granulator and connect with fluid bed dryer to form a fully closed granulating production line.

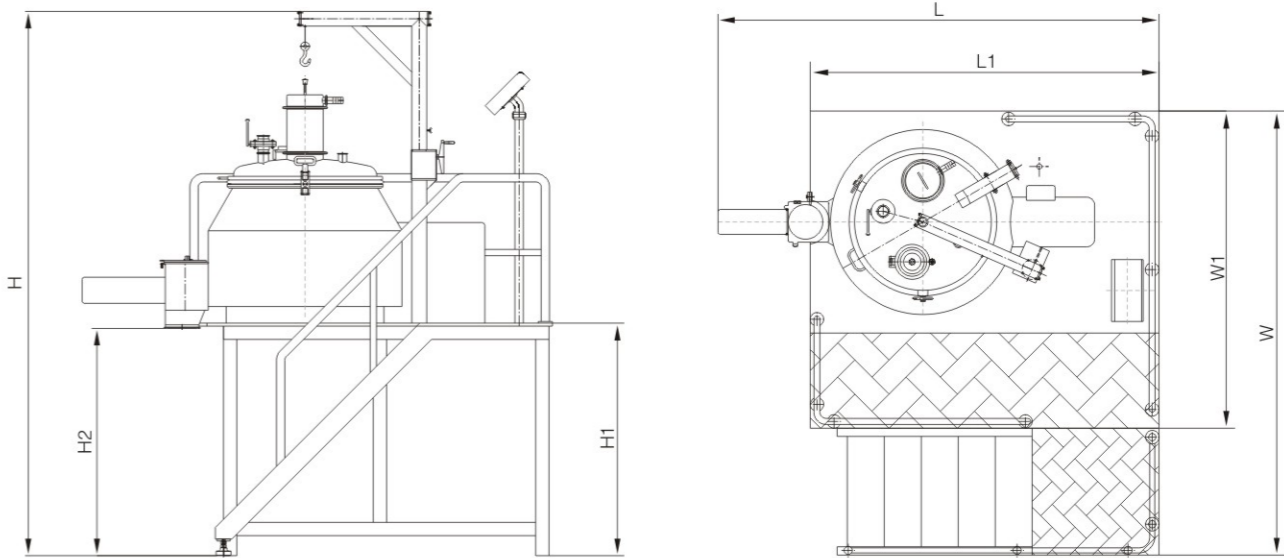

技术参数 Technical parameter

项目 Item	型号 Model	SHLG-100	SHLG-150	SHLG-200	SHLG-300	SHLG-400	SHLG-500	SHLG-600	SHLG-800	SHLG-1000
生产能力 Production capacity (kg/批batch)		20-40	30-60	40-80	60-120	80-160	100-200	120-240	160-320	200-400
搅拌电机功率 Mixing motor power(KW)		11	15	22	30	30	37	45	55	55
搅拌桨转速 Mixing paddle rotation speed(rpm)		0-200	0-200	0-200	0-200	0-200	0-170	0-170	0-150	0-120
制粒电机功率 Granulating motor power(KW)		4	5.5	5.5	7.5	7.5	7.5	7.5	11	11
制粒刀转速 Granulating knife rotation speed(rpm)		0-2900	0-2900	0-2900	0-2900	0-2900	0-2900	0-2900	0-2900	0-2900
整粒功率 Miller Power(Kw)		2.2	2.2	3	4	4	5.5	5.5	5.5	5.5
整粒转速 Impeller Speed(rpm)		0-900	0-900	0-900	0-900	0-900	0-900	0-900	0-900	0-900
压缩空气耗量 Compressed air consumption(m³/min)		0.4	0.4	0.6	0.6	0.6	1	1	1	1
压缩空气压力 Compressed air pressure(MPa)		0.3-0.6	0.3-0.6	0.3-0.6	0.3-0.6	0.3-0.6	0.3-0.6	0.3-0.6	0.3-0.6	0.3-0.6
设备重量 Equipment weight(kg)		1200	1500	1800	2000	2200	2500	3000	3500	4000
外形尺寸 Outline dimensions	L	2200	2365	2580	2580	2605	2780	2780	2980	3180
	L1	1800	1800	2000	2000	2000	2200	2280	2480	2680
	W	2300	2400	2400	2600	2600	2800	2800	2900	3100
	W1	1500	1600	1600	1800	1800	2000	2000	2100	2300
	H	2600	2600	3050	3050	3050	3050	3050	3250	3350
	H1	1400	1400	1400	1400	1400	1400	1400	1600	1600
	H2	1360	1360	1360	1360	1360	1370	1370	1570	1570

注：本公司可按用户要求定制生产
Note: Our company can customize products according to user requirements.

SHL 湿法混合制粒机
Wet type granulator

用途

此设备是制药工业固体制剂生产中普遍使用的工艺设备之一。它具有混合、制粒等多种功能，广泛应用于制药、食品、化工等行业。

工作原理

物料通过真空上料机或提升上料机加入到制粒锅内，经过搅拌桨离心力作用，压力供液系统将粘合剂通过喷枪注入，同时切割刀高速旋转，物料在锅中凝结成空心颗粒，制粒结束后出料到下一工序（整粒或干燥）。



Application

The machine is a process machine widely applied for solid preparation production in the pharmaceutical industry. It has such functions as mixing, granulating, etc. It is widely used in such industries as medicine, food, chemical industry, etc.

Work principle

The materials are fed into the mixing vessel through the vacuum feeder or lifting feeder. Through rotation and push by the mixing paddle at the bottom, they first move under a fluidizing status and get sufficient mixing. Then the adhesive is injected through the pressure spray gun to turn the dry powders into wet and soft materials. Meanwhile, they are made into even wet granules under the double actions of the mixing paddle and the high-speed cutter on the side wall. After granulation, the materials are discharged to the next procedure (milling or drying).

特点

- ▲整机采用优质不锈钢制造；
- ▲设有特制搅拌桶，锥柱复合型结构，内壁转角光滑过渡，镜面抛光，不沾料，易清洗；
- ▲物料在密闭搅拌桶中，一步即可完成混合制粒工序；
- ▲采用PLC控制，搅拌制粒电机变频调速，全部操作分手动和自动；
- ▲装有联锁保护装置，操作更安全；
- ▲配有打印机，可自动打印所有工艺参数，原始记录与实际相符；

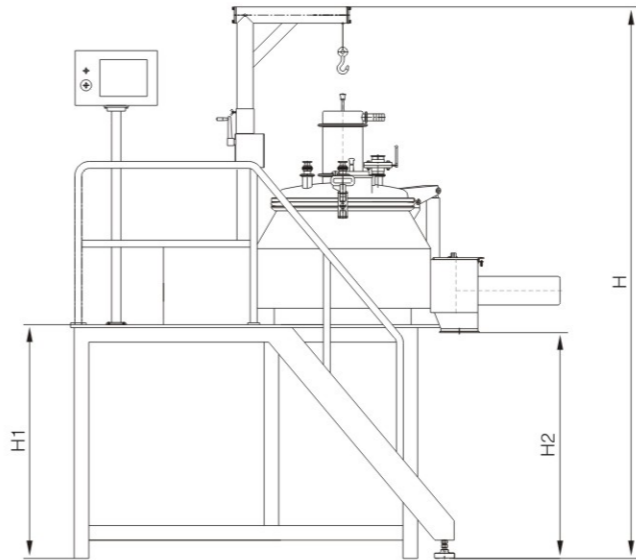

Features

- ▲The whole machine is made of high quality stainless steel.
- ▲It is provided with special mixing barrel and conical column of a compound structure. The corners on the inner wall are subjected to smooth transition and mirror polishing with easy cleaning and without material sticking.
- ▲The mixing and granulating procedure can be completed in one step with the materials in the closed mixing barrel.
- ▲It adopts PLC control. The mixing and granulating motors are subjected to variable frequency speed adjustment. All operations can be carried out automatically or manually.
- ▲It is provided with interlocking protection device to ensure safer operation.
- ▲It is equipped with printer to automatically print all process parameters, with the original records conforming to the actual ones.

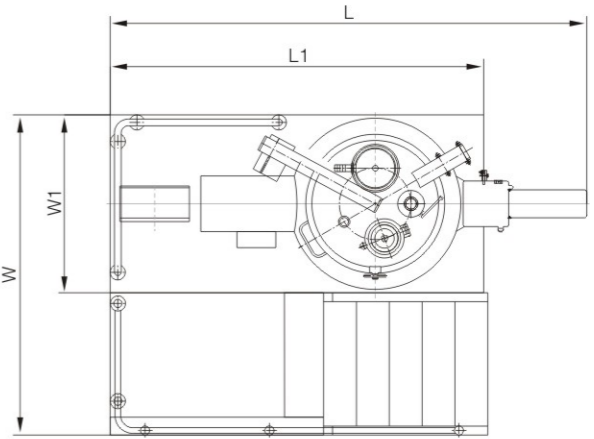

技术参数 Technical parameter

项目 Item	型号 Model	SHL-100	SHL-150	SHL-200	SHL-300	SHL-400	SHL-500	SHL-600	SHL-800
生产能力 Production capacity (kg/批batch)		20-40	30-60	40-80	60-120	80-160	100-200	120-240	160-320
搅拌电机功率 Mixing motor power(KW)		11	15	22	30	30	37	45	55
搅拌桨转速 Mixing paddle rotation speed(rpm)		0-200	0-200	0-200	0-200	0-200	0-170	0-170	0-150
制粒电机功率 Granulating motor power(KW)		4	5.5	5.5	7.5	7.5	7.5	7.5	11
制粒刀转速 Granulating knife rotation speed(rpm)		0-2900	0-2900	0-2900	0-2900	0-2900	0-2900	0-2900	0-2900
压缩空气耗量 Compressed air consumption(m³/min)		0.4	0.4	0.6	0.6	0.6	1	1	1
压缩空气压力 Compressed air pressure(MPa)		0.3-0.6	0.3-0.6	0.3-0.6	0.3-0.6	0.3-0.6	0.3-0.6	0.3-0.6	0.3-0.6
设备重量 Equipment weight(kg)		1000	1300	1600	1800	2000	2200	2700	3200
外形尺寸 Outline dimensions	L	2300	2465	2580	2680	2705	2880	2880	3080
	L1	1900	1900	2000	2100	2100	2300	2300	2580
	W	1600	1600	1800	1800	2000	2150	2150	2200
	W1	900	900	1000	1000	1200	1350	1350	1400
	H	2500	2550	2930	2930	2930	3050	3050	3250
	H1	1050	1050	1280	1280	1280	1400	1400	1600
	H2	1010	1010	1240	1240	1240	1370	1370	1570

注：本公司可按用户要求定制生产
Note: Our company can customize products according to user requirements.

SHLS 实验型湿法混合制粒机
Laboratory wet type granulator

用途

此设备主要适用于实验室中小批量制粒工艺，粉体物料与粘合剂在湿法缸中的底部混合浆高速混合搅拌，再由侧置高速粉碎桨切割成均匀的湿颗粒，从而达到制粒的目的，是制药工业固体制剂生产中普遍使用的工艺设备之一，广泛应用于制药、食品、化工等行业。

工作原理

粉状物料通过人工加到混合容器中，先经底部搅拌桨旋转推动做流化态运动，并得到充分混合，然后经压力喷枪注入粘合剂，使干粉变成湿润软材，同时在搅拌桨和侧壁高速切刀的双作用下制成均匀湿颗粒。制粒结束后出料到下一工序(整粒或干燥)。



Application

The machine is mainly suitable for small batch granulation process in the laboratory. The powder material and the adhesive are mixed at high speed in the bottom mixing paddle of the wet cylinder, and then cut into uniform wet granules by the side high speed cutter. The purpose of the granules is one of the process equipment commonly used in the production of solid preparations in the pharmaceutical industry, and is widely used in the pharmaceutical, food, chemical and other industries.

Work principle

The powder materials are fed into the mixing vessel manually. Through rotation and push by the mixing paddle at the bottom, they first move under a fluidizing status and get sufficient mixing. Then the adhesive is injected through the pressure spray gun to turn the dry powders into wet and soft materials. Meanwhile, they are made into even wet granules under the double actions of the mixing paddle and the high-speed cutter on the side wall. After granulation, the materials are discharged to the next procedure (milling or drying).

特点

- ▲整机采用优质不锈钢制造，带脚轮，移动方便；
- ▲物料在密闭搅拌桶中混合制粒，一步即可完成混合制粒工序；
- ▲采用PLC控制，搅拌和制粒电机变频调速，全部操作分手动和自动；
- ▲装有安全联锁装置，操作更安全。
- ▲配有打印机，可自动打印所有工艺参数，原始记录与实际相符。

Features

- ▲The whole machine is made of high quality stainless steel and is convenient to move with castors.
- ▲The mixing and granulating procedure can be completed in one step with the materials mixed and granulated in the closed mixing barrel.
- ▲It adopts PLC control. The mixing and granulating motors are subjected to variable frequency speed adjustment. All operations can be carried out automatically or manually.
- ▲It is provided with interlocking protection device to ensure safe operation.
- ▲It is equipped with printer to automatically print all process parameters, with the original records conforming to the actual ones.

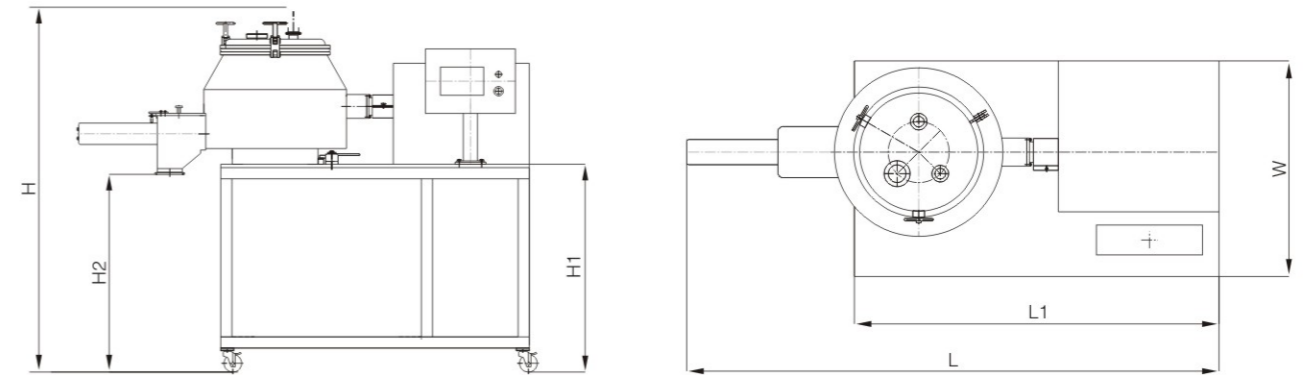

技术参数 Technical parameter

项目 Item	型号 Model	SHLS-3	SHLS-6	SHLS-10	SHLS-15	SHLS-25	SHLS-50
生产能力 Production capacity (kg/batch)(kg/批)		0.6-1.2	1.2-2.4	2-4	3-6	5-10	10-20
搅拌电机功率 Mixing motor power(KW)		1.5	1.5	1.5	4	4	4
搅拌桨转速 Mixing paddle rotation speed(rpm)		0-400	0-400	0-400	0-220	0-220	0-220
制粒电机功率 Granulating motor power(KW)		1.1	1.1	1.1	2.2	2.2	2.2
制粒刀转速 Granulating knife rotation speed(rpm)		0-2900	0-2900	0-2900	0-2900	0-2900	0-2900
压缩空气耗量 Compressed air consumption(m³/min)		0.1	0.1	0.1	0.3	0.3	0.3
压缩空气压力 Compressed air pressure(MPa)		0.3-0.6	0.3-0.6	0.3-0.6	0.3-0.6	0.3-0.6	0.3-0.6
设备重量 Equipment weight(kg)		250	270	300	400	430	450
外形尺寸 Outline dimensions	L	1400	1425	1450	1525	1550	1600
	L1	1000	1000	1000	1100	1100	1100
	W	700	700	700	750	750	750
	H	1110	1120	1140	1250	1300	1350
	H1	750	750	750	750	750	750
	H2	730	730	730	720	720	720

注：本公司可按用户要求定制生产
Note: Our company can customize products according to user requirements.

FL 沸腾制粒机
Fluid bed granulator

用途

此设备是制药工业固体制剂生产中普遍使用的工艺设备之一。它具有混合、干燥、制粒等多种功能。同时在制药、化工、食品等行业广泛使用。

工作原理

空气经净化加热后，由引风机从沸腾制粒干燥机下部吸入，穿过物料料仓的分布板，使物料粉末粒子或是湿颗粒在原料容器中呈沸腾流化状态，受到经过净化后的加热空气预热和混合，制粒时将粘合剂溶液雾化喷入，使若干粒子聚集成含有粘合剂的团粒，由于热空气对物料的不断干燥，使团粒中水份蒸发，粘合剂凝固，此过程不断重复进行，形成理想的、均匀的多微孔球状颗粒。

沸腾制粒方法是喷雾技术和流化技术的综合运用，它使传统的混合，制粒，干燥过程在同一台设备内完成，实现一步制粒。

Application

The machine is a process machine widely applied for solid preparation production in the pharmaceutical industry. It has such functions as mixing, drying, granulation functions etc. It is also widely used in such industries as medicine, chemical industry, food, etc.

Work principle

After purified and heated, the air sucked from the bottom of the fluid bed granulator by the induced draft fan, and then passes through the air flow distribution plate of the material silo, so that the material powder particles or wet granules under boiling and fluidizing status in the raw material container. After the granules are preheated by the purified and heated air and mixed, the adhesive solution is atomized and sprayed during granulating to make several particles agglomerate into granules containing the adhesive. Because the material are continuously dried by hot air, the moisture in the granules is evaporated, and the adhesive is solidified. This process will be carried out continuously and repetitively to form ideal and even micro-porous ball granules. The Fluid bed granulating method is a comprehensive application of spraying technology and fluidizing technology. It completes the traditional mixing, granulating and drying processes in a machine to realize one-step granulation.



特点

- ▲设备具备密闭取样功能；
- ▲进风加热系统可选用电加热或蒸汽加热两种方；
- ▲一台主机可以配有多个料仓使用；
- ▲采用PLC 全自动控制系统；
- ▲整机配备先进的CIP清洗系统；
- ▲符合药品生产的GMP要求。

Features

- ▲This machine is provided with the closed sampling function.
- ▲The air intake heating system can adopt two heating modes such as electric heating or steam heating.
- ▲One machine can be equipped with many silos.
- ▲Adopt PLC automatic control system.
- ▲Equipped with the advanced CIP cleaning system.
- ▲Meet GMP requirements.

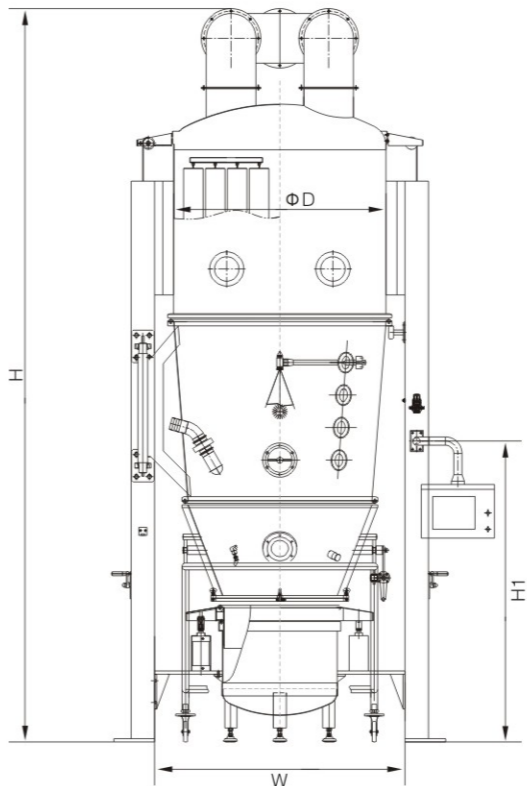

技术参数 Technical parameter

项目 Item	型号 Model	FL-15	FL-30	FL-60	FL-120	FL-200	FL-300	FL-500
容器容积 Vessel volume(L)		45	100	220	330	577	980	1530
生产能力 Production capacity(kg/批batch)		5-15	15-30	30-60	60-120	120-200	200-300	300-500
风机功率 Fan power(KW)		7.5	11	18.5/22	22/30	30/37	37/45	75
电加热功率 Electric heating power(KW)		30	30	30	45	80	90	120
蒸汽压力 Steam pressure(MPa)		0.4-0.6	0.4-0.6	0.4-0.6	0.4-0.6	0.4-0.6	0.4-0.6	0.4-0.6
蒸汽耗量 Steam consumption(kg/h)		180	180	300	360	420	480	677
压缩空气压力 Compressed air pressure(MPa)		0.4-0.6	0.4-0.6	0.4-0.6	0.4-0.6	0.4-0.6	0.4-0.6	0.4-0.6
压缩空气耗量 Compressed air consumption(m³/min)		0.4	0.9	0.9	1.0	1.0	1.5	1.8
主机重量 Weight of main machine(kg)		800	1000	1200	1400	2000	2500	3500
外形尺寸 Outline dimensions	H	3000	3234	3953	4508	4640	5165	5812
	H1	1850	1850	1850	1850	1850	1850	1850
	ΦD	806	806	1106	1306	1306	1608	2008
	W	984	984	1340	1540	1540	1840	2240

注：本公司可按用户要求定制生产
Note: Our company can customize products according to user requirements.

FG 沸腾干燥机
Fluid bed dryer



用途

此设备是制药工业固体制剂生产中普遍使用的工艺设备之一。它具有混合、干燥等多种功能。同时在制药、化工、食品等行业广泛使用。

工作原理

空气经净化加热后，由引风机从沸腾制粒干燥机下部吸入，穿过物料料仓的分布板，使物料粉末粒子或是湿颗粒在原料容器中呈沸腾流化状态，受到经过净化后的加热空气预热和混合，制粒时将粘合剂溶液雾化喷入，使若干粒子聚集成含有粘合剂的团粒，由于热空气对物料的不断干燥，使团粒中水份蒸发，粘合剂凝固，此过程不断重复进行，形成理想的、均匀的多微孔球状颗粒。

Application

The machine is a process machine widely applied for solid preparation production in the pharmaceutical industry. It has such functions as mixing, drying, etc. It is also widely used in such industries as medicine, chemical industry, food, etc.

Work principle

After purified and heated, the air sucked from the bottom of the fluid bed granulator by the induced draft fan, and then passes through the air flow distribution plate of the material silo, so that the material powder particles or wet granules under boiling and fluidizing status in the raw material container. After the granules are preheated by the purified and heated air and mixed, their moisture is evaporated. This process will be carried out continuously and repetitively to form ideal and uniform dry granules.



特点

- ▲设备具备密闭取样功能；
- ▲进风加热系统可选用电加热或蒸汽加热两种方；
- ▲一台主机可以配有多个料仓使用；
- ▲采用PLC 全自动控制系统
- ▲整机配备先进的CIP清洗系统；
- ▲符合药品生产的GMP要求。

Features

- ▲This machine is provided with the closed sampling function.
- ▲The air intake heating system can adopt two heating modes such as electric heating or steam heating.
- ▲One machine can be equipped with many silos.
- ▲Adopt PLC automatic control system.
- ▲Equipped with the advanced CIP cleaning system.
- ▲Meet GMP requirements.

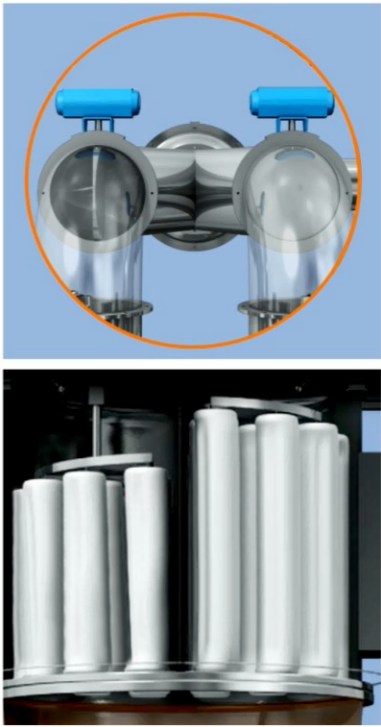
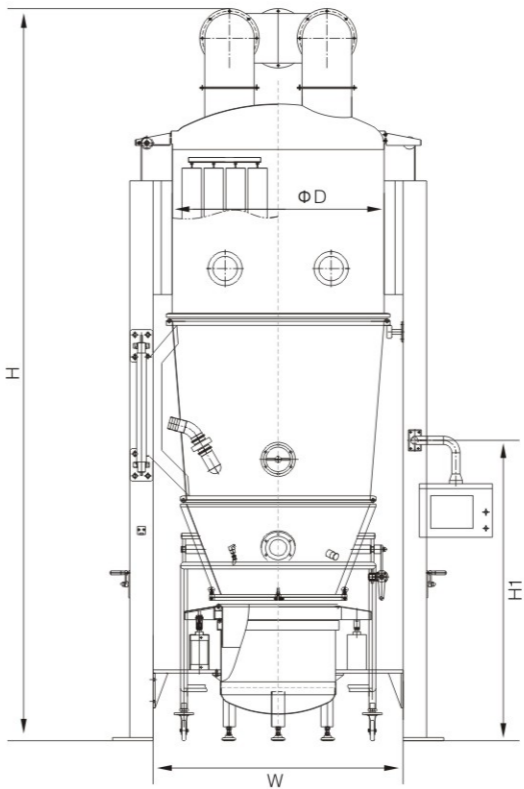

技术参数 Technical parameter

项目 Item	型号 Model	FG-15	FG-30	FG-60	FG-120	FG-200	FG-300	FG-500
容器容积 Vessel volume(L)		45	100	220	330	577	980	1530
生产能力 Production capacity(kg/批batch)		5-15	15-30	30-60	60-120	120-200	200-300	300-500
风机功率 Fan power(KW)		7.5	11	18.5/22	22/30	30/37	37/45	75
电加热功率 Electric heating power(KW)		30	30	30	45	80	90	120
蒸汽压力 Steam pressure(MPa)		0.4-0.6	0.4-0.6	0.4-0.6	0.4-0.6	0.4-0.6	0.4-0.6	0.4-0.6
蒸汽耗量 Steam consumption(kg/h)		180	180	300	360	420	480	677
压缩空气压力 Compressed air pressure(MPa)		0.4-0.6	0.4-0.6	0.4-0.6	0.4-0.6	0.4-0.6	0.4-0.6	0.4-0.6
压缩空气耗量 Compressed air consumption(m³/min)		0.4	0.9	0.9	1.0	1.0	1.5	1.8
主机重量 Weight of main machine(kg)		800	1000	1200	1400	2000	2500	3500
外形尺寸 Outline dimensions	H	3000	3234	3953	4508	4640	5165	5812
	H1	1850	1850	1850	1850	1850	1850	1850
	ΦD	806	806	1106	1306	1306	1608	2008
	W	984	984	1340	1540	1540	1840	2240

注：本公司可按用户要求定制生产
Note: Our company can customize products according to user requirements.

DPL 多功能流化床
Multifunctional fluid bed granulator



用途

此设备是制药工业固体制剂生产中普遍使用的工艺设备之一。它具有混合、干燥、制粒、包衣等多种功能。同时在制药、化工、食品等行业广泛使用。

工作原理

该机由顶喷系统、底喷系统、空气处理系统、加热系统、控制系统、排风除尘系统等组成。顶喷为制粒干燥功能，底喷为包衣功能，以上功能都在同一台沸腾制粒机上实现，用户可按实际生产工艺选配功能要求。

顶喷原理：

空气经净化加热后，由引风机从流化床下部吸入，穿过物料料仓的分布板，使物料粉末粒子或是湿颗粒在原料容器中呈沸腾流化状态；颗粒经过预热和混合，使颗粒中水份蒸发，此过程不断重复进行，行程理想的、均匀的干燥颗粒。

底喷包衣原理：

流化床包衣时，净化的空气穿过物料料仓的气流分布板，使物料在原料容器内呈流化状态，同时将包衣液雾化喷入，包裹在物料表面，反复包衣干燥至所需工艺要求。

Application

This machine is one of the process equipment commonly used in the production of solid preparations in the pharmaceutical industry. It has many functions such as mixing, drying, granulating and coating. it is also widely used in the pharmaceutical, chemical, food and other industries.

Work principle

The machine is composed of a top spray system, a bottom spray system, an air treatment system, a heating system, a control system, an exhaust dust removal system and the like. The top spray is a granulation drying function, and the bottom spray is a coating function. The above functions are all realized on the same boiling granulator, and the user can select the functional requirements according to the actual production process.

Top spray principle:

After purified and heated, the air is distributed through the lower part of the fluid bed dryer through the air blower, so that the material powder particles or wet granules under boiling and fluidizing status in the raw material container. After the granules are preheated by the purified and heated air and mixed, their moisture is evaporated. This process will be carried out continuously and repetitively to form ideal and even dry granules.

Bottom spray coating principle:

When the fluidized bed is coated, the purified air process through the air distribution plate of the material silo, causing the material to be fluidized in the raw material container while atomizing the coating liquid into the package, wrapped on the surface of the material. Dry to the required process requirements.

特点

- ▲可实现一台设备集顶喷制粒，底喷包衣功能；
- ▲设备具备密闭取样功能；
- ▲进风加热系统可选用电加热或蒸汽加热两种方；
- ▲进风系统配有稳定的温度控制系统，控制在±1.5℃以内；
- ▲可有效的控制静电现象；
- ▲采用PLC 全自动控制系统；
- ▲完全符合药品生产的GMP要求。

Features

- ▲That one machine is able to process granulation by top spray and coating by bottom spray.
- ▲This machine is provided with the closed sampling function.
- ▲The air intake heating system can adopt two heating modes such as electric heating or steam heating.
- ▲Reliable temperature control system in inlet air handling system, deviation is with ± 1.5℃.
- ▲Equipped with the advanced CIP cleaning system.
- ▲It adopted PLC automatic control system.
- ▲Meet GMP requirements .

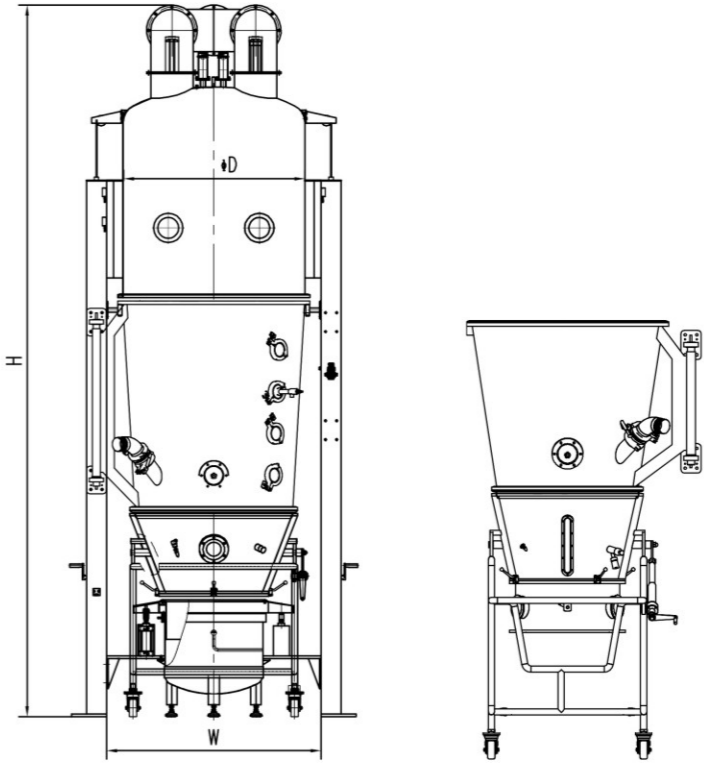

技术参数 Technical parameter

项目 Item		型号 Model	DPL-30	DPL-60	DPL-120	DPL-200	DPL-300
容器容积 Vessel volume(L)	底喷 Bottom spray		80	150	330	417	765
	顶喷 Top spray		100	220	330	577	980
生产能力 Production capacity (kg/批batch)	底喷 Bottom spray		15-20	15-30	30-60	60-90	100-200
	顶喷 Top spray		10-30	30-60	60-120	120-200	200-300
风机功率 Fan power(KW)			11	18.5/22	22/30	30/37	37/45
电加热功率 Electric heating power(KW)			30	30	45	80	90
蒸汽压力 Steam pressure(MPa)			0.4	0.4	0.4	0.4	0.4
蒸汽耗量 Steam consumption(kg/h)			180	300	360	420	481
压缩空气压力 Compressed air pressure(MPa)			0.4-0.6	0.4-0.6	0.4-0.6	0.4-0.6	0.4-0.6
压缩空气耗量 Compressed air consumption(m³/min)			0.6	0.9	1	1	1.5
主机重量 Weight of main machine(kg)			1200	1600	1800	2300	2500
外形尺寸 Outline dimensions (mm)	H		3374	4353	4908	5040	5865
	ΦD		806	1106	1306	1306	1608
	W		984	1340	1540	1540	1840

注：本公司可按用户要求定制生产
Note: Our company can customize products according to user requirements.

DPLS 实验型多功能沸腾制粒机
Laboratory multifunctional fluid bed granulator

用途

此设备是集顶喷、底喷、侧喷等功能于一体的多功能制粒机。它主要适用于实验室中小批量加工工艺，根据工艺需要可实现物料混合、干燥、制粒、包衣、制微丸等。广泛应用于制药、食品、化工等行业。

工作原理

该机由进风系统、流化床系统、顶喷系统、底喷系统、侧喷系统、排风除尘系统等组成。顶喷为制粒功能；底喷为微丸包衣功能；侧喷为制微丸功能。以上功能都在同一台多功能沸腾制粒机上实现。用户按实际生产工艺选配功能要求。

Application

The machine is a multi-functional granulator integrating top spray, bottom spray and side spray. It is mainly suitable for small batch processing in the laboratory. According to the process requirements can be realized material mixing, drying, granulation, coating, pelleting, etc. Widely used in pharmaceutical, food, chemical and other industries.

Work principle

The machine is composed of air inlet system, fluid bed system, top spray system, bottom spray system, side spray system and exhaust and dust filter system. The top spray provides the granulating function, the bottom spray provides the pellet coating function and the side spray provides the pelletizing function. The above functions are realized in one machine. Users can select the optional functions according to actual process requirements.

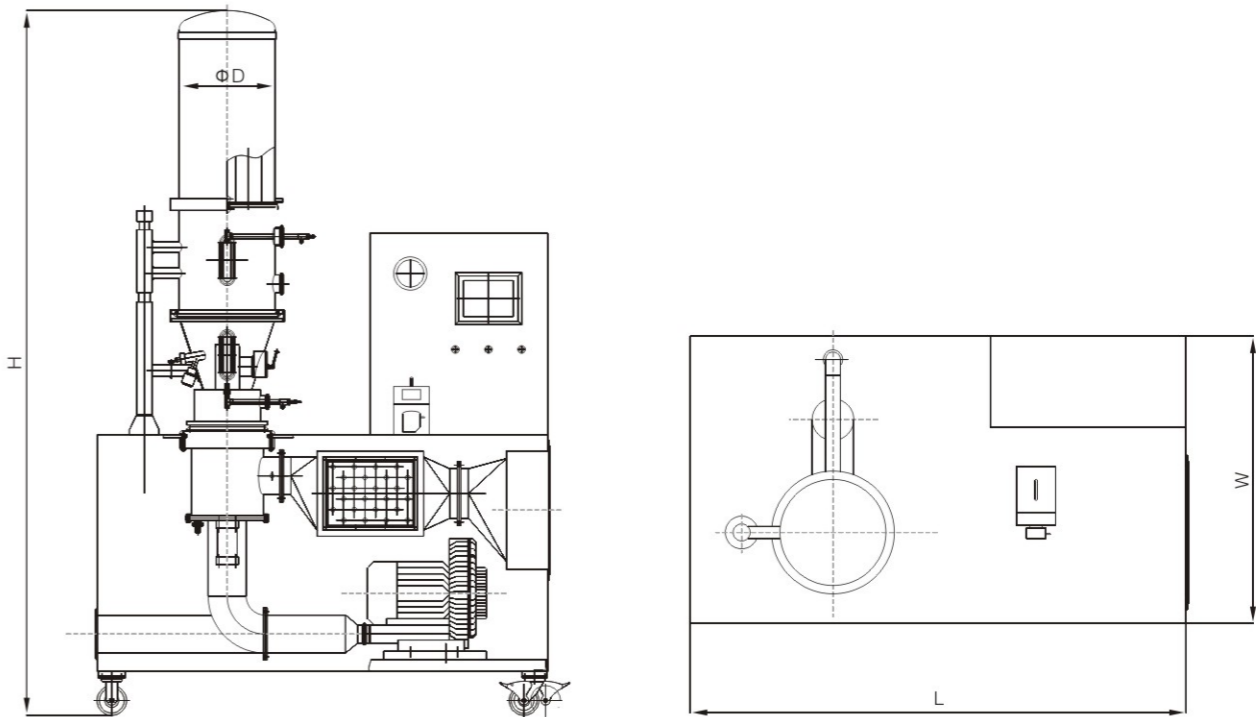

技术参数 Technical parameter

项目 Item	型号 Model	DPLS-0.2	DPLS-0.5	DPLS-1	DPLS-2	DPLS-3	DPLS-5
容积 Volume(L)	顶喷 Top spray	1.25	3	5.6	5.8	9	38
	底喷 Bottom spray	1.25	3	14	16	9	22
	侧喷 Side spray	-	-	5.9	7	8.5	15
生产能力 Production capacity(kg/h)	顶喷 Top spray	0.2	0.5	1.5	2	3	3-5
	底喷 Bottom spray	0.2	0.3	1.2	2	2	1-3
	侧喷 Side spray	-	-	1	1	2	2.4
压缩空气 Compressed air	压力 Pressure(Mpa)	0.4-0.6					
	耗气量(m³/min) Air consumption	0.15	0.15	0.15	0.15	0.8	1
电加热功率 Electric heating power(KW)		2	3	4	4.5	9	12
热风调温范围 Hot air temperature adjusting range(℃)		室温~120 Room temperature to 120					
热空气过滤精度 Hot air filtering precision		亚高效或高效 Sub-efficient or effective					
风机功率 Fan power(kw)		0.75	1.75	2.2	4	4	5.5
外形尺寸 Outline dimensions	W	700	855	855	855	885	1100
	H	900	1815	2220	2275	2520	2825
	L	1000	1200	1600	1800	1800	1900
	ΦD	159	214	256	300	300	400
设备重量 Equipment weight(kg)		600	650	700	750	800	850

注：本公司可按用户要求定制生产
Note: Our company can customize products according to user requirements.



JTZ 提升翻转整粒机

Lifting turnover dry mill

用途

JTZ系列提升翻转整粒机可直接将沸腾制粒仓内的物料制成所需的颗粒进入总混料桶。

工作原理

该机由固定提升转料机和整粒机组成。工作时，将锥斗与所配机型的料仓扣合。提升料仓，翻转料仓；水平旋转立柱至要求位置，下降料仓到工作高度，开启整粒机，打开蝶阀，使物料转移至下一工序。



Application

The JTZ series lifting dry mill can directly make the materials in the fluid bed granulating silo into desired granules and send them into the mixing barrel.

Work principle

The machine is composed of the fixed lifting transferring machine and milling machine. During operation, the conical hopper is assembled onto the silo. The silo is lifted, turned and the column is rotated horizontally to the required position. The silo is lowered to the work height, the milling machine is started, and with the opening of the butterfly valve, the materials are transferred to the next procedure.

特点

- ▲该机采用了电、液集成控制技术，性能稳定，安全可靠；使用摇杆操作系统，使用方便灵活；
- ▲转序过程在密闭状态下工作，避免粉尘飞扬，无污染；
- ▲整粒机可更换不同规格的筛网；
- ▲符合药品生产的GMP要求；

Features

- ▲The machine adopts electrically and hydraulically integrated control technology to realize stable and reliable ,safe performance. It uses the rocker operation system, which makes the use convenient and flexible.
- ▲The granules milling machine can be lowered to any work height together with the conical copper for the convenience of connection with the next procedure.
- ▲Procedure transferring is carried out under the closed status, avoiding dust and causing no pollution.
- ▲Different specification of screen can be replaced for the milling machine.
- ▲Meet GMP requirements.

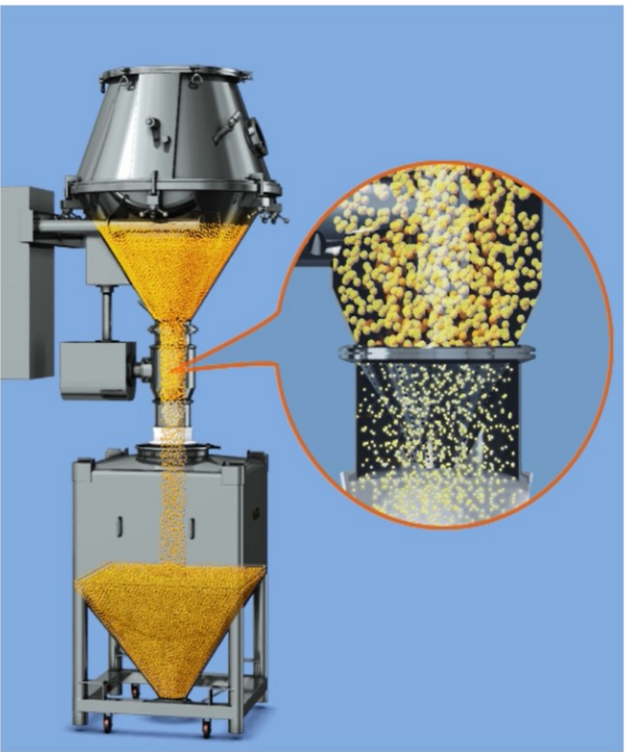
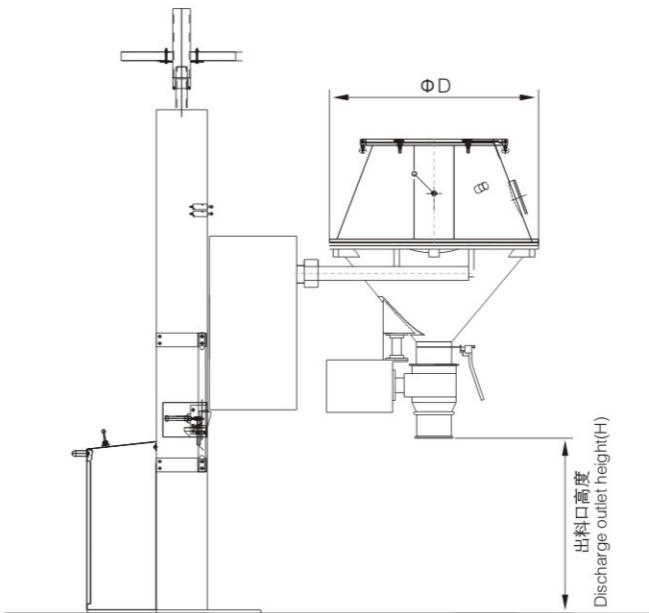

技术参数 Technical parameter

项目 Item	型号 Model	JTZ-120	JTZ-200	JTZ-300	JTZ-500
净负载 Net load(kg)		120	200	300	500
提升电机功率 Lifting motor power(kw)		2.2	3.0	3.0	3.0
翻转电机功率 Turning motor power(kw)		0.75	1.1	1.1	1.1
整粒电机功率 Granule sizing motor power(kw)		3.0	3.0	3.0	4.0
筛网规格 Screen specification(mm)		d0.6-3	d0.6-3	d0.6-3	d0.6-3
产能 Production capacity(kg/h)		450	450	450	700
重量 Weight(kg)		1000	1100	1200	1600
外形尺寸 Outline dimensions	ΦD	1204	1478	1580	1700
	H	根据工艺要求设计 Designed according to process requirements			

注：本公司可按用户要求定制生产
Note: Our company can customize products according to user requirements.

ZLZ 提升真空整粒机

Lifting vacuum dry mill

用途

此设备主要应用于制药工业中将制粒后结团的颗粒，根据工艺要求整粒成均匀的颗粒。同时在制药、化工、食品等行业中广泛使用。

工作原理

通过真空上料机把物料抽到缓冲罐中，开机工作，颗粒由缓冲罐流到整粒机的腔体内，由腔体内的整粒刀使颗粒经过撞击、挤压、剪切后通过筛网孔排出腔体，经导流筒的出料口流到料斗。在密闭前提下完成物料传输，整粒工序。

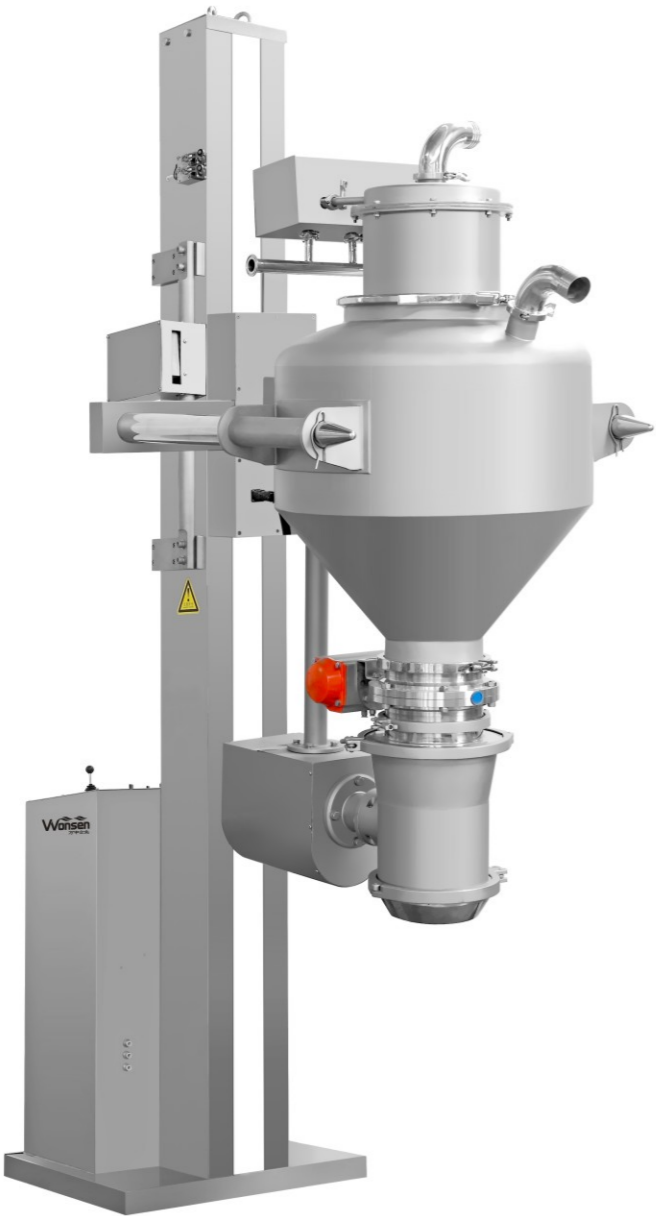

Application

The machine is mainly used in the pharmaceutical industry to pellet the granules after granulation, and milling into uniform granules according to the process requirements. It is also widely used in such industries as medicine, chemical industry, food, etc.

Work principle

During operation, the materials are sucked into the buffer tank through the vacuum feeder. The granules flow from the buffer tank to the cavity of the granulator, and the granules in the cavity are subjected to impact, extrusion, shearing, and then discharged through the screen hole, and flow through the discharge port of the guide tube to the hopper. In the closed premise to complete the material transfer, the whole process



特点

- ▲整粒机的高度根据生产工艺需要可以提升或下降，满足用户的生产工艺需要；
- ▲整个工序在密闭状态下完成，避免粉尘飞扬，无污染；
- ▲符合药品生产的GMP要求。

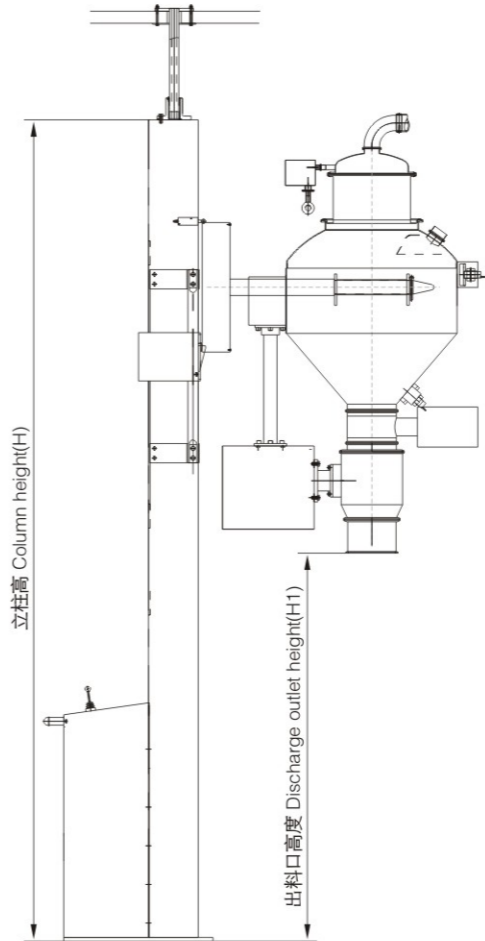

Features

- ▲The machine height of lifting or falling. Meet clients' requirements.
- ▲The whole process in a closed state to complete,to avoid dust flying,no pollution.
- ▲Meet GMP requirements.

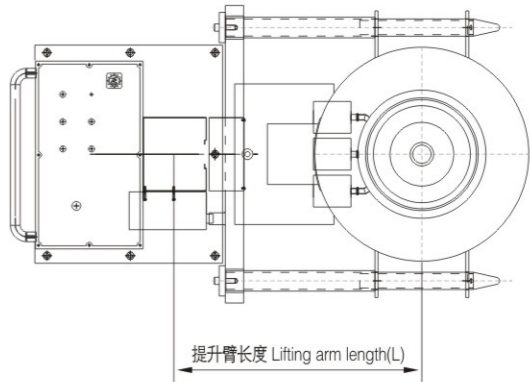

技术参数 Technical parameter

项目 Item	型号 Model	ZLZ-100	ZLZ-200	ZLZ-300	ZLZ-500	ZLZ-700
提升电机功率 Lifting motor power(kw)		1.5	2.2	2.2	3.0	3.0
整粒功率 Granule sizing power(KW)		1.1	3.0	3.0	3.0	4.0
筛网规格 Screen specification(mm)		d0.6-3	d0.6-3	d0.6-3	d0.6-3	d0.6-3
产能 Production capacity(kg/h)		100	450	450	450	700
外形尺寸 Outline dimensions	H	根据用户要求设计 Designed according to user requirements				
	H1					
	L					

注：本公司可按用户要求定制生产
Note: Our company can customize products according to user requirements.

FZM 门式整粒机
Grinding dry mill

用途

制药：原料粉碎；湿料制粒；干料整粒；不合要求的药品，需回收利用的可按颗粒度的大小要求进行整粒；食品：饼干粉碎回收利用；其他：粗状原料的粉碎和整粒块状原料的粉碎和整粒。

工作原理

将加工的原料加入粉碎机料斗，经插板阀调节落入锥形工作室，由旋转整粒刀对原料起旋流作用，并以离心力将颗粒甩向筛网面同时由于回转刀的高速旋转与筛网面产生剪切作用，颗粒在回转刀与筛网间被粉碎成小颗粒并经筛网孔排出。粉碎的颗粒大小，由筛网的目数，回转刀与筛网之间的间距以及回转速度的快慢来调节。



Application

Pharmaceutical: raw material pulverization; wet material milling; dry material milling; unqualified drugs which need to be recycled, can be granulated according to the size of the granules; Food: biscuit crushing and recycling; pulverization of coarse raw materials, the pulverization and granulation of the whole granulated raw material.

Work principle

The raw material is added to the hopper of the pulverizer, and is adjusted to fall into the conical working chamber through the plug-in valve. The rotary granulating knife acts on the raw material to swirl, and the centrifugal force is used to smash the granules toward the screen surface. And at the same time, due to the high speed rotation of the rotary knife and the shearing on the screen surface, and the granules are pulverized into small granules and discharged through the mesh holes. The size of the pulverized granules is adjusted by the mesh of the screen, the distance between the rotary knives and the screen and the speed of the slewing.

特点

- ▲彻底解决了摇摆颗粒机筛网磨损碎屑污染物料的难题；
- ▲控制粒度容易；
- ▲无滞留死角，无物料过热弊病；
- ▲粉尘少、无振动，噪音低；
- ▲高效节能，生产能力大；
- ▲造型美观，便于清洗；
- ▲移动方便，使用面广。

Features

- ▲It thoroughly solves the problem of scraps polluting materials due to the wear of the screen in the oscillating granulator.
- ▲The granule size is easy to control.
- ▲There is no retention dead corner,easy to clean and no overheating of materials.
- ▲Little dust, no vibration and low noise.
- ▲High efficiency, energy saving and high production capacity.
- ▲With beautiful appearance, it is easy to clean.
- ▲With convenient movement, widely application range.

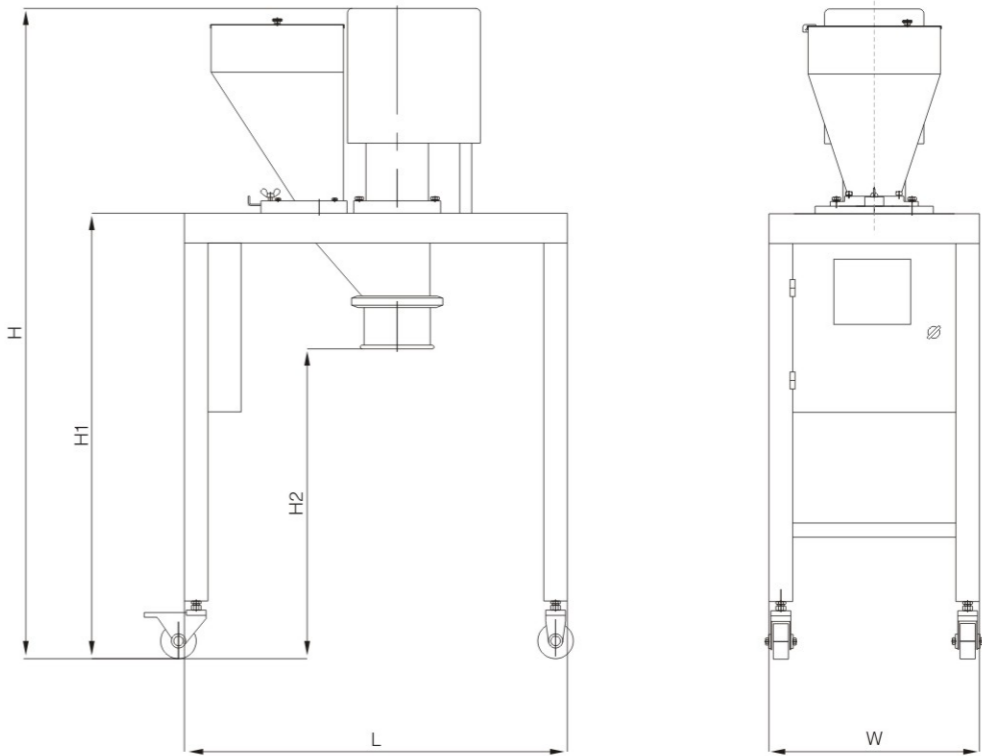

技术参数 Technical parameter

项目 Item	型号 Model	FZM-300	FZM-450	FZM-700	FZM-1000
电机功率 Motor Power(Kw)		2.2	3.0	4.0	5.5
筛网规格 Screen specification(mm)		d0.6-3	d0.6-3	d0.6-3	d0.6-3
产能 Production capacity(kg/h)		300	450	700	1000
外形尺寸 Outline dimensions	H	1300	1450	1650	1875
	H1	897	954	1104	1254
	H2	650	650	700	700
	L	810	920	1000	1100
	W	445	445	500	600

注：本公司可按用户要求定制生产
Note: Our company can customize products according to user requirements.



LG 干法制粒机
Roller compactor

用途

干法制粒机采用连续进料、出料，集挤压、破碎和制粒功能于一体，直接将粉状物料压制成药粒。特别适用于遇湿、遇热、易分解失效或结块的物料进行造粒。已广泛用于制药、食品、化工等行业。在制药工业中，干法制粒机制成的颗粒可以直接压片或灌装胶囊。

工作原理

干法制粒机是将混合好的干粉物料，通过真空上料机加入到上料斗内，经螺旋送料器输送到压力室，两个高压挤压力轮将物料压制成药片，再通过整粒系统制成粒径符合要求的颗粒，完成制粒过程。

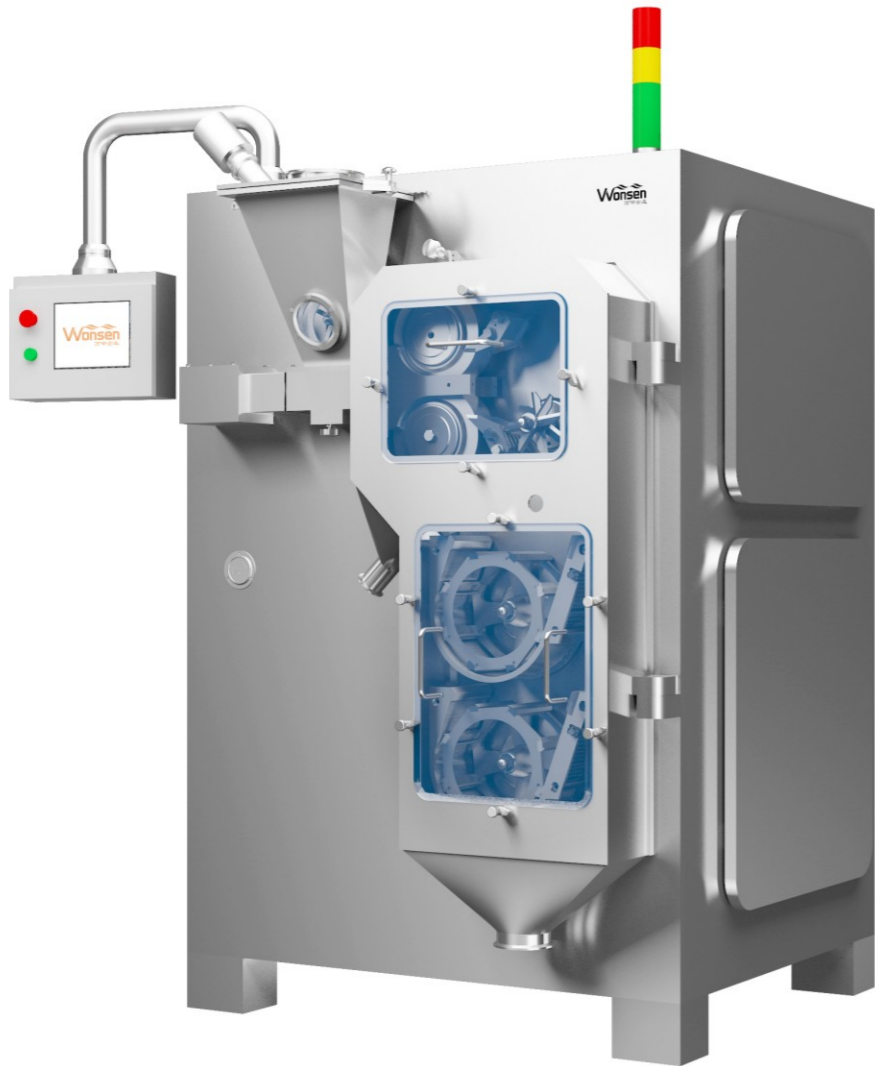

Application

Roller compactor adopts continuous feeding and discharging, integrates the extrusion, crushing and granulating functions, directly makes powder into granules. It is especially suitable for granulation of materials which are wet, hot, easily broken down or agglomerated. It has been widely used in pharmaceutical, food, chemical and other industries. In the pharmaceutical industry, granules made by the roller compactor can be directly pressed into tablets or filled into capsules.

Work principle

Mixed with the ingredients of the dry powder material, by the vacuum feeder to the soli material, through the screw conveyor to the pressure chamber, the two high-pressure extrusion wheel to press the material into sheet with the required density and thickness, then through the milling system to make granules meet requirements to complete the granulation process.

特点

- ▲干式造粒：将粉末压片、切碎、整粒三个制程设计成一体；
- ▲造粒过程较简单，不必加水或溶剂，不用干燥，造粒后可得到稳定的颗粒；
- ▲压轮带有水冷系统，确保压轮与物料温度，不高于工艺要求；
- ▲整体模块式设计，结构紧凑，提高空间利用率；
- ▲动力区与工作区分开，防止交叉污染；
- ▲水平送料结构，挤压系统外露式安装，方便清洁与维护；
- ▲符合GMP要求。

Features

- ▲3 functions in one unit. These are compress.
- ▲Simplified process to obtain highly stable granules. No water or other liquid is added and no need drying, so the loss of active ingredients due to decomposition can be eliminated.
- ▲Pressure rollers with a water cooling system.
- ▲Overall modular design, compact structure, better space utilization.
- ▲The power area is separated from the work area to prevent cross contamination.
- ▲Horizontal feeding structure, exposed installation of extrusion system, easy to clean and maintain.
- ▲Meet GMP requirements.

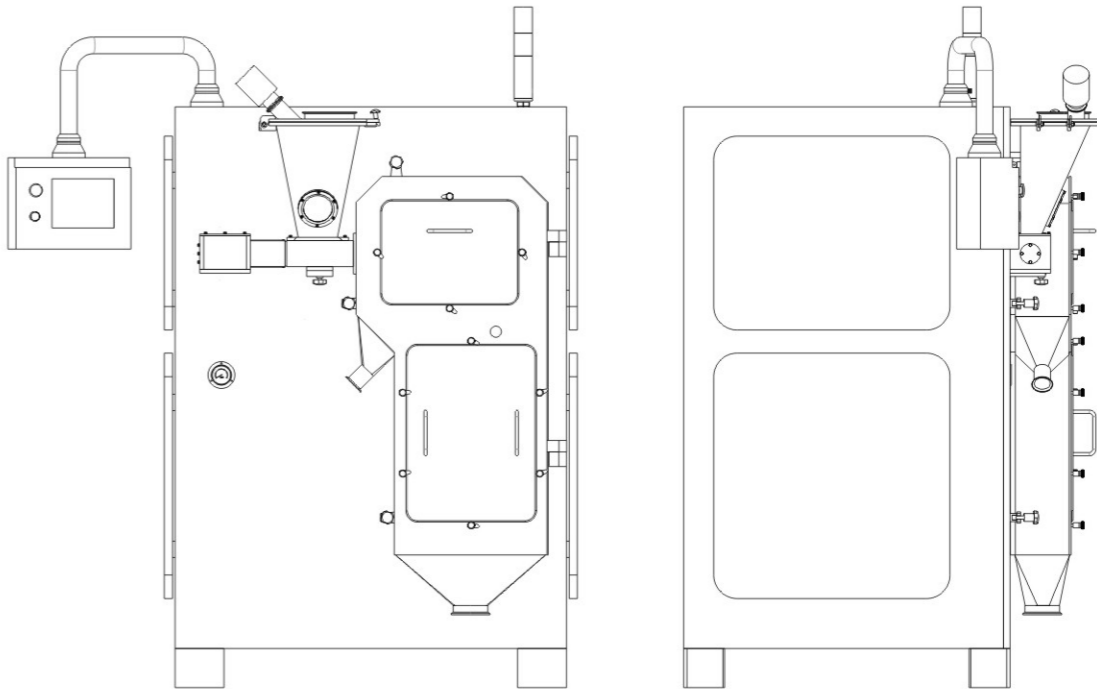

技术参数 Technical parameter

项目 Item	型号 Model	LG-5	LG-15	LG-50	LG-100	LG-200
送料电机功率 Feeding motor power(kw)		0.37	0.55	0.75	2.2	4
挤压机功率 Extruding motor power(kw)		0.55	0.75	1.5	3	5.5
整粒电机功率 Granulating motor power(kw)		0.37	0.37	0.55	1.1	1.5
油泵电机功率 Oil pump motor power(kw)		0.55	0.55	0.55	0.55	0.55
冷水机功率 Water cooler power(kw)		2.2	2.2	2.2	2.2	2.2
产能 Production capacity(kg/h)		5	15	50	100	200
重量 Weight(kg)		500	700	900	1100	2000

注：本公司可按用户要求定制生产
Note: Our company can customize products according to user requirements.

ZTH 全自动提升混合机
Automatic lifting bin blender

用途

此设备能完成自动提升、混合、下降等功能。配一台料斗混合机及多个不同规格的混合料斗,就能满足大小批量、多品种的混合要求,是药厂总混的理想设备。同时在制药、化工、食品等行业广泛使用。

工作原理

该机由两个机座、回转架、回转系统、升降系统、控制系统等部件组成。将混合料斗推入回转架内并完成定位,启动控制系统,将回转架提升到混合高度并可靠夹紧。驱动系统按设定的时间、转速等数据进行自动混合。混合作业结束,回转架垂直停止,料斗自动下降到地面,整机停止,并打印工艺数据。将料斗推出转到下一工序。

Application

The machine is provided with such functions as automatic lifting, mixing, lowering, etc. A bin mixer and variety mixing bin of different specifications ,it can meet the mixing requirements of different batches and diversified varieties of products. It is an ideal machine for mixing in pharmaceutical plants. It is also widely used in such industries as medicine, chemical industry, food, etc.

Work principle

The machine is composed of two machine bases, rotation frame, rotation system, lifting system, control system, etc. Push the mixing bin into the rotation frame and complete the positioning. Start the control system to lift the rotation frame to the mixing height and clamp it reliably. The driving system will carry out automatic mixing according to the set time, rotation speed and other data. After the mixing operation is finished, the rotation frame will stop vertically, the bin will automatically fall to the ground, the machine will stop and process data will be printed. The bin is transferred to the next procedure.

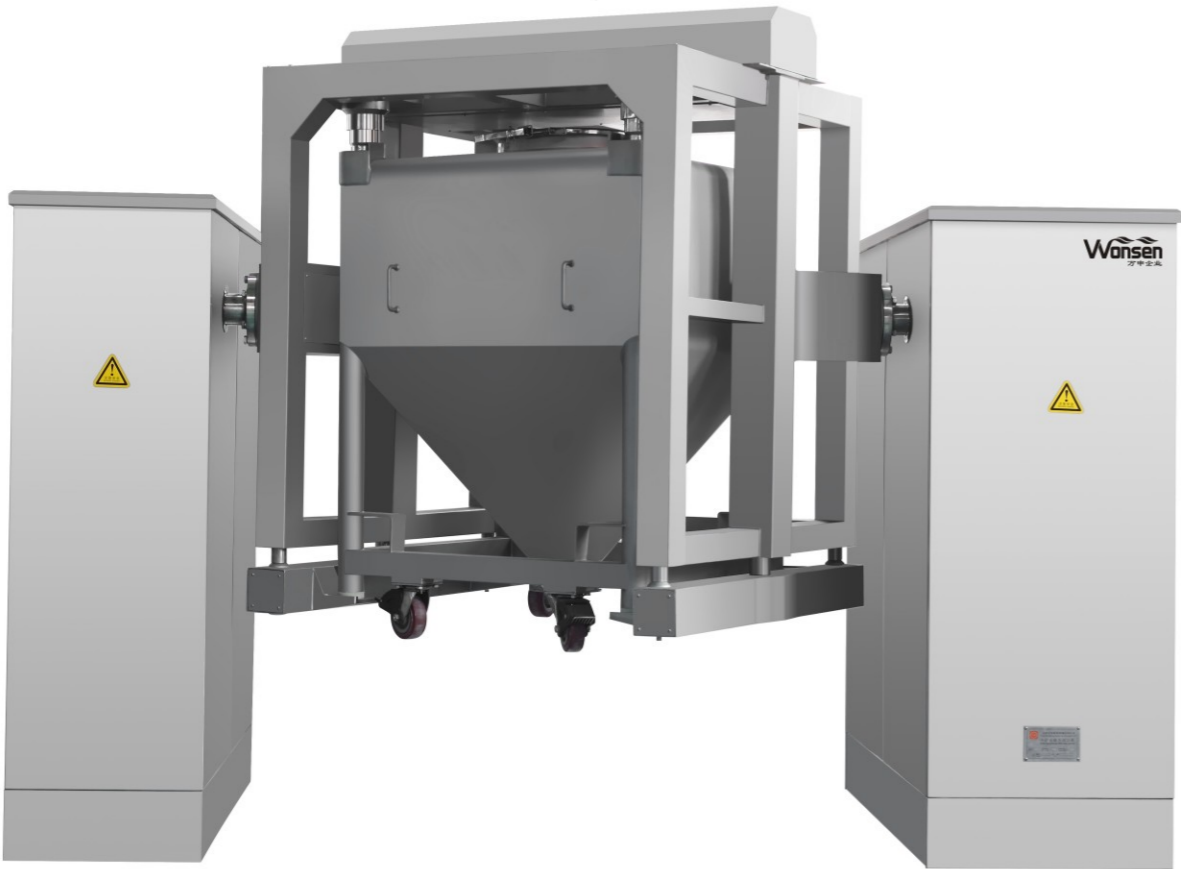

特点

- ▲该机是我司广泛吸收、消化国外先进技术,结合国情研发成功的新机型。结构合理,性能稳定,操作方便;
- ▲回转体(混合料斗)一对称平面,与回转轴线成30° 夹角,混合料斗中的物料随回转体翻动外,同时沿斗壁做切向运动,产生强烈的翻转和高速的切向运动,从而达到最佳的混合效果;
- ▲采用PLC全自动控制,并设置红外线安全装置及防误操作装置的出料蝶阀,确保生产安全;
- ▲单机可配多种规格和数量的料斗;
- ▲本机设有九重安全互锁机构;
- ▲有效地控制粉尘与交叉污染,减少物料的损失,控制物料的分层,优化了生产工艺;
- ▲完全符合药品生产的GMP要求。

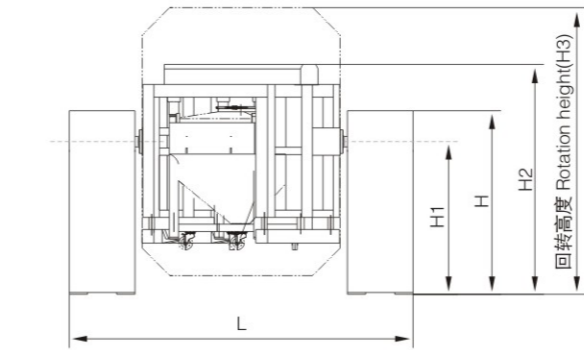

Features

- ▲This machine is a new model that our company has extensively absorbed and digested foreign advanced technology, successfully developed in combination with national conditions. Reasonable structure, stable performance, convenient operation, no dead corners, and no exposed bolts.
- ▲The rotating body (mixing bin) symmetry plane is at an angle of 30° to the rotation axis. The materials in the mixing bin rotate along with the rotating body and make tangential movement along the hopper walls, producing strong turning and high-speed tangential movement and achieving the best mixing effect.
- ▲It adopts PLC automatic control . It is provided with the infrared safety device and the discharging butterfly valve with the misoperation preventer to ensure safe production.
- ▲One machine can be equipped with bins of various specifications and quantities.
- ▲The machine effectively controls dust pollution and cross contamination, reduces loss of materials, controls material layering, optimizes production processes.
- ▲Meet GMP requirements.

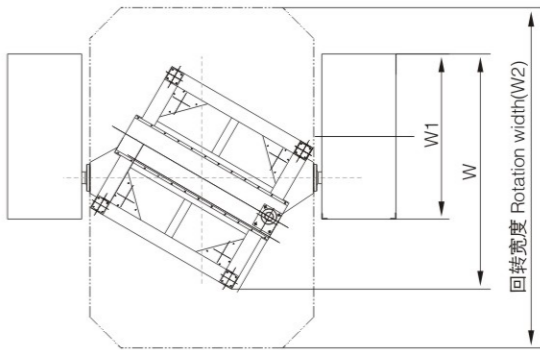

技术参数 Technical parameter

项目 Item	型号 Model	ZTH-400	ZTH-600	ZTH-800	ZTH-1000	ZTH-1200	ZTH-1500	ZTH-2000
料斗容积 Bin volume(L)		400	600	800	1000	1200	1500	2000
最大装料容积 Maximum loading volume(L)		320	480	640	800	960	1200	1600
最大装料重量 Maximum loading weight(kg)		200	300	400	500	600	750	1000
主轴转速 Spindle rotation speed(rpm)		3-20	3-20	3-20	3-15	3-15	3-15	3-15
回转电机功率 Rotation motor power(kW)		5.5	5.5	5.5	5.5	5.5	7.5	11.0
提升电机功率 Lifting motor power(kW)		1.5	1.5	1.5	2.2	3.0	4	4
整机重量 Machine weight(kg)		1800	2500	2800	3000	3200	3600	4200
外形尺寸 Outline dimensions	H	1780	1780	1880	2070	2150	2240	2410
	H1	1390	1390	1590	1730	1800	1900	2070
	H2	2260	2260	2460	2660	2800	2970	3320
	H3	2710	2710	2940	3200	3350	3500	3810
	L	3290	3290	3290	3660	3710	3910	4010
	W	2150	2150	2150	2300	2300	2300	2300
	W1	1650	1650	1650	1650	1650	1650	1650
	W2	2360	2360	2700	2940	3100	3200	3480

注: 本公司可按用户要求定制生产
Note: Our company can customize products according to user requirements.



HLT 单立柱提升料斗混合机
Single-column lifting bin blender

用途

HLT系列单立柱提升料斗混合机广泛应用于制药工业生产工序中不同成分的粉体与粉体、粉体与颗粒、颗粒与颗粒的混合。该机具有自动提升混合下降等功能，可配多种规格料斗进行混料作业，适用于大中型制药企业，单机对多品种不同批量的物料按工艺要求进行混合，实现一机多用。

工作原理

工作时，将料仓推入叉架；将混合料斗推入回转臂并锁紧螺母，启动控制系统，将料仓提升到混合高度；控制系统按设定的时间、转速等数据进行自动混合；混合作业结束，定位在水平位置，料斗自动下降到地面，整机停止，并打印工艺数据；松开回转臂的锁紧螺母，将料斗推出转到下一工序。



Application

The HLT single-column lifting bin mixer is widely used for mixing different components of powders with powders, powders with granules and granules with granules in the production procedure in the pharmaceutical industry. The machine is provided with such functions as automatic lifting, mixing, falling, etc. It can be equipped with various specifications of bin for mixing operation. It is suitable for mixing materials of different varieties and different batches in large and medium-sized pharmaceutical enterprises according to process requirements. Multiple purposes can be realized in one machine.

Work principle

Push the mixing bin into the gyrator arm and lock the nut. Start the control system will carry out automatic mixing according to the set time, rotation speed and other data. After the mixing operation is finished, it is positioned at the horizontal position. The bin will automatically fall to the ground, the machine will stop and process data will be printed. Loosen the locknut of the gyrator arm, and push the bin out and transfer it to the next procedure.

特点

- ▲采用PLC控制自动化系统；控制简便，工艺参数调整方便。
- ▲控制系统灵敏、整机结构紧凑、运转稳定可靠。
- ▲单机可配多种规格的料斗，提高混合机的使用效率，避免物料交叉污染。
- ▲混合均匀度99%以上、体积装料系数达0.80，桶体内外光洁、无死角。

完全符合药品生产的GMP要求。

Features

- ▲It adopted PLC automatic control; easy control and convenient adjustment of process parameters.
- ▲A single machine can be equipped with bins of different specifications. Improve the efficiency of bin blender, avoid cross contamination
- ▲The mixing barrel can serve both as the dispensing barrel for the previous procedure and as the feeding bin for the next procedure (tablet pressing, filling).
- ▲The mixing uniformity is over 99%, the volume loading coefficient is 0.80 and the barrel is clean, no dead corner .Meet GMP requirements.

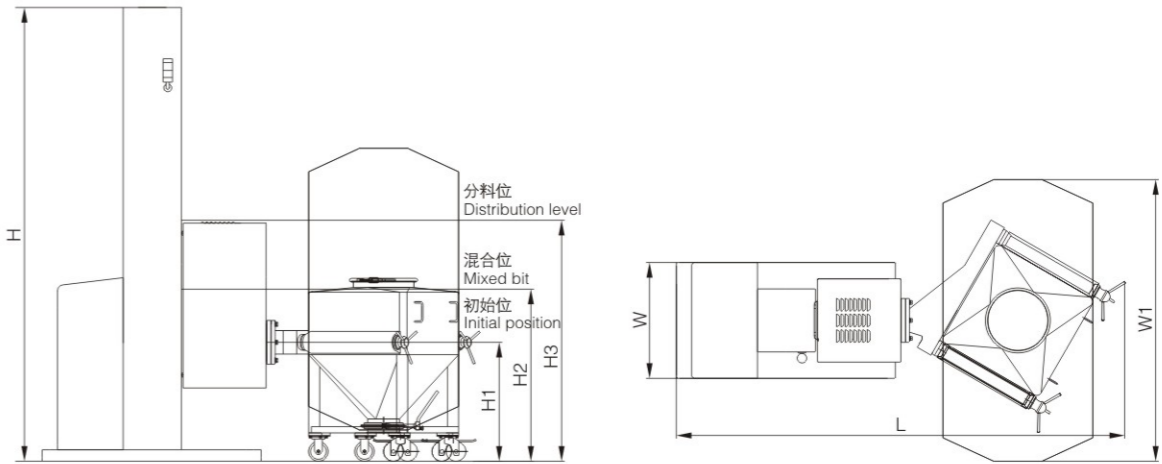

技术参数 Technical parameter

项目 Item	型号 Model	HLT-100	HLT-100A	HLT-200	HLT-200A	HLT-300	HLT-300A	HLT-400	HLT-400A	HLT-600	HLT-600A	HLT-800	HLT-800A	HLT-1000	HLT-1000A	HLT-1200	HLT-1200A
料斗容积 Bin volume(L)		100		200		300		400		600		800		1000		1200	
最大装料容积 Maximum loading volume(kg)		80		160		240		320		480		640		800		960	
最大装料重量 Maximum loading weight(kg)		50		100		150		200		300		400		500		600	
主轴转速 Spindle rotation speed(rpm)		3-20		3-20		3-20		3-15		3-15		3-15		3-12		3-10	
整机重量 Machine weight (kg)		1000		1200		1400		1600		1800		2000		2200		2400	
总功率 Total power(kw)		3.7		4.5		4.5		7		8.5		8.5		8.5		8.5	
外形尺寸 Outline dimensions (mm)	L	2550		2830		2870		3000		3330		3380		3430		3500	
	H	2525	2850	2625	2850	2725	2900	2775	2950	2825	3000	2875	3050	2925	3050	3025	3100
	H1	700		700		760		800		960		1060		1060		1160	
	H2	1040		1040		1100		1170		1400		1460		1500		1610	
	H3	1450	1900	1450	1900	1500	1960	1580	2000	1720	2160	1840	2260	1840	2260	1940	2360
	W	740		740		740		740		740		740		740	820	740	820
	W1	1480		1680		1800		1940		1340		2540		2660		2820	

注：本公司可按用户要求定制生产
Note: Our company can customize products according to user requirements.

HF 方锥混合机
Square cone blender

用途

方锥混合机是结合多种混合机的特点而研发，适用很广泛的一种混合机。它能完全保证符合国家药品GMP和其他相关行业标准。特别适用于品种相对单一且批量较大的产品的混合工艺。如：药品、食品、乳品、化工试剂等行业的固体制剂的混合。

工作原理

物料通过人工、真空上料、楼层落料或专用提升机进入混合筒内，料斗对称的轴线与回转轴轴线成一夹角，不同组分物料在密闭的料斗中进行三维空间运动，产生强烈翻转和扩散收缩作用，达到良好的混合效果。



Application

This machine is developed in combination with the characteristics of a variety of mixers and is suitable for a wide range of mixers . It fully meets GMP requirements and other relevant industry standards. It is especially suitable for the mixing process of products with relatively single varieties and large batch sizes. Such as: pharmaceutical, food, dairy, chemical reagents and other solid preparation industries.

Work principle

The materials enter the mixing barrel through manual feeding, vacuum feeding, floor material dropping or special lifting machine. the symmetrical axis of the hopper is at an angle with the rotation axis of the rotating shaft, The materials of different components will make three-dimensional movement in the closed hopper, producing strong turning, diffusing and shrinking actions and achieving the best mixing effect.

特点

- ▲整体设计新颖、结构紧凑、外形美观混合均匀度达99%，体积装料系数达0.8；
- ▲回转高度低、运转平稳，性能可靠，操作方便；
- ▲桶体内外壁均经镜面抛光，无死角、易出料、易清洗、易维修、无交叉污染；
- ▲完全符合药品生产的GMP要求。

Features

- ▲With novel design, compact structure and beautiful appearance the machine can reach mixing uniformity 99% and volume loading coefficient is 0.8.
- ▲It has such features as high rotation height, stable running, reliable performance and easy operation.
- ▲The inner and outer walls of the bins are subjected to mirror polishing ,easy discharging and cleaning , no dead corners and without cross contamination.
- ▲Meets GMP requirements.

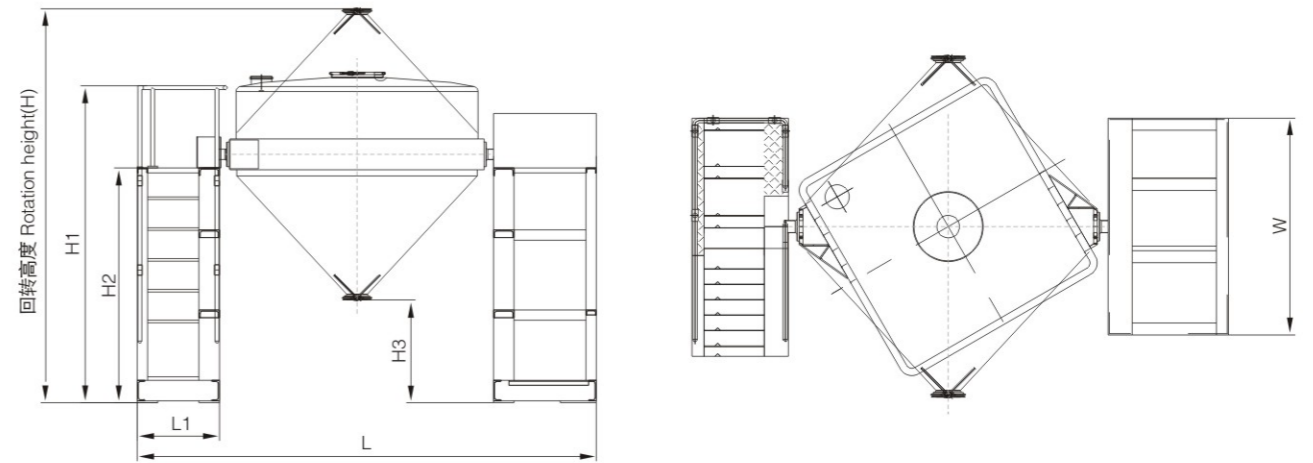

技术参数 Technical parameter

项目 Item	型号 Model	HF-600	HF-800	HF-1000	HF-1200	HF-1500	HF-2000	HF-3000	HF-4000	HF-6000
容积 Volume(L)		600	800	1000	1200	1500	2000	3000	4000	6000
净负载 Net load(kg)		300	400	500	600	750	1000	1500	1800	3000
转速 Rotation speed(rpm)		2-20	2-16	2-16	2-12	2-12	2-12	2-8	2-8	2-8
电机功率 Motor Power (KW)		3	4.0	4.0	5.5	5.5	7.5	11.0	11.0	15.0
整机重量 Machine weight(kg)		800	850	1200	1650	1650	2000	3000	3500	6000
外形尺寸 Outline dimensions	H	2194	2462	2585	2761	3027	3135	3446	4360	4851
	H1	2160	2300	2400	2345	2546	2576	2848	3813	3971
	H2	1361	1496	1563	1645	1846	1837	2048	2813	2933
	H3	700	800	800	800	900	800	900	1500	800
	L	2608	3075	3188	3479	3618	3869	4120	4470	5223
	L1	590	710	750	780	780	830	800	800	820
	W	1361	1382	1395	1500	1500	1627	1600	2200	2700

注：本公司可按用户要求定制生产
Note: Our company can customize products according to user requirements.

HLS 实验型料斗混合机
Laboratory bin blender

用途

主要适用于对不同成分干燥的粉体之间、颗粒之间或粉体和颗粒之间的混合试验。是摸索物料混合最佳工艺参数的理想机型，是先进的机电一体化实验设备。

工作原理

工作时将物料装入混合桶内，料斗一对称平面与回转轴线成一夹角，不同成分物料在密闭的料斗中运动，产生强烈翻转和扩散收缩作用，达到最佳的混合效果。

Application

It is mainly used for the tests of mixing different components of dry powders with dry powders, granules with granules, or powders with granules. It is an ideal machine for exploring the best process parameters in material mixing, and an advanced mechanically and electrically integrated experimental machine.

Work principle

When is works,put the materials into the mixing bin. As the symmetrical axis of the bin symmetry plane forms at an angle with the rotation axis, different components of materials will move in the closed hopper, producing strong turning, diffusing and shrinking actions and achieving the best mixing effect.



特点

- ▲整机设计新颖、结构紧凑、外形美观、混合均匀度达99%，体积装料系数达0.8。
- ▲回转高度低、运转平稳，性能可靠，操作方便。
- ▲桶体内外壁均经镜面抛光，无死角、易出料、易清洗，无交叉污染，符合GMP要求。

Features

- ▲With novel design, compact structure and beautiful appearance, the machine can reach mixing uniformity 99% and volume loading coefficient is 0.8.
- ▲It has such features as high rotation height, stable running, reliable performance and convenient operation.
- ▲The inner and outer walls of the bin are subject to mirror polishing with easy discharging and cleaning and without any dead corners and cross contamination. Meet GMP requirements.

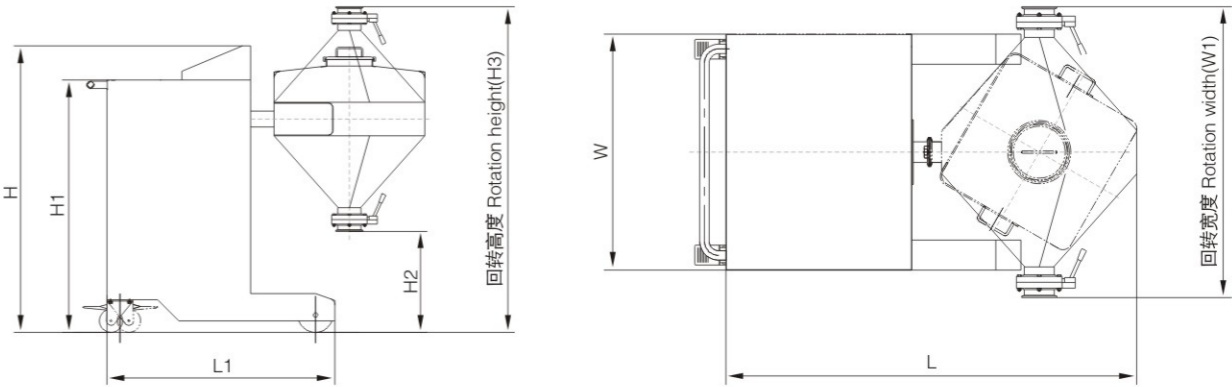

技术参数 Technical parameter

项目 Item	型号 Model	HLS-5	HLS-10	HLS-15	HLS-20	HLS-30	HLS-50	HLS-100	HLS-150
桶容积 Bin volume(L)		5	10	15	20	30	50	100	150
净负载 Net load(kg)		2.5	5	7.5	10	15	25	50	75
混合转速 Mixing rotation speed(rpm)		3-30	3-30	3-30	3-30	3-25	3-25	3-20	3-20
总功率 Total power(kW)		0.37	0.37	0.37	0.37	0.55	0.55	0.75	1.1
机器重量 Machine weight(kg)		150	160	170	180	190	200	250	280
外形尺寸 Outline dimensions	H	1200	1200	1200	1200	1200	1200	1260	1360
	H1	1030	1030	1030	1030	1030	1030	1110	1210
	H2	650	580	550	520	500	440	440	480
	H3	1050	1120	1150	1180	1200	1280	1430	1600
	L	870	1030	1040	1050	1100	1150	1400	1620
	L1	800	800	800	800	800	800	1000	1050
	W	600	600	600	600	600	600	800	800
	W1	400	600	650	700	730	820	1000	1100

注：本公司可按用户要求定制生产
Note: Our company can customize products according to user requirements.

BGB-F 新型高效包衣机+片剂翻斗加料机
High-efficiency coating machine + tablet tipping feeder



用途

新型自动包衣机是专门为各类片剂、丸剂、颗粒剂的包衣工艺解决方案而设计。该设备在生产效率提升的同时，还保障了产品物料的稳定性的。可靠的制作工艺，滚筒互换设计，在线清洗功能设计均符合GMP各项工业及可操作性要求。各种独特的功能组合缩短了批量变更的时间，能满足不同的工艺操作要求，是使用薄膜、糖衣功能和药物涂层的首选设备。

工作原理

在包衣滚筒回转作用下，素芯在滚筒内连续运动。蠕动泵将包衣介质输送到喷枪喷覆在素芯表面，在负压条件下，进风空气处理单元按设定的程序和工艺参数向片床内供给洁净的热风，对素芯进行干燥；热风通过素芯层底部经排风空气处理单元排出，使喷覆在素芯表面的包衣介质快速形成坚固、细密、光整、圆滑的表面薄膜，完成包衣。

Application

The new type auto coating machine is designed for coating process solutions for all kinds of tablets, pills, granules, which can promote the coating production efficiency and guarantee material stability. Reliable Process, interchangeable pan design, CIP design and good appearance conform to the requirements of GMP. Varieties of functions make the batch production time shorten, satisfying different process requirements. It is the best choice for film coating, sugar coating.

Work principle

Under the rotation action of the coating pan, the tablets or pills to be coated make continuous movement in the pan. The peristaltic pump conveys the coating solution to the spray gun for spraying them on the surfaces of the tablets or pills to be coated. Under negative pressure, the inlet air handling unit supplies clean hot air according to the set procedures and process parameters to dry the tablets or pills. The hot air is discharged from the outlet air handling unit, so that the coating solution sprayed on the tablets or pills rapidly form solid, dense, flat and smooth film, thus the coating process finish.



特点

- ▲正面整体开放式设计；
- ▲能高速高效的清理内部，零死角；
- ▲开阔的安装区域和锅体更换及维护空间；
- ▲独特的气囊密封结构，全密闭腔体。

Features

- ▲Overall open design on the front side.
- ▲Easy cleaning,no dead corner.
- ▲Wide install area and maintenance space,and pan replacement.
- ▲Unique airbag seal structure,fully enclosed chamber.



新型高效包衣机 High-efficient coating machine



翻斗加料 Tipping feeding

- ▲实现片剂平滑过渡到锅内；
- ▲防止高度差撞击产生碎片、磕片；
- ▲自动提升、斜式翻转，原料可均匀慢速滑入锅内。
- ▲Achieve a smooth transition of the tablet into the pan;
- ▲Prevent fragments and bracts because of the height difference colliding;
- ▲Automatic lifting and tilting, the raw material can slide into the pan evenly and slowly.

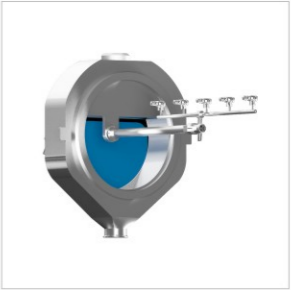

喷枪 Spray gun

- ▲独立一体式设计；
- ▲内置管路；
- ▲喷射角度和高度可调。
- ▲Independent and integrated design;
- ▲Built-in pipeline;
- ▲The spray angle and height are adjustable.



控制系统 Control system

- ▲触控屏工业电脑，多语言操作系统；
- ▲独立模组控制，独立的操作器适合不同要求操作放置；
- ▲在线流量、温度、转速、风速、负压的监控；
- ▲多组程序控制；
- ▲设备和产品信息储存量大，在线打印及输出及上传；
- ▲MES系统端口。
- ▲Touch screen industrial computer, multi-language operating system;
- ▲Independent module control, independent operator is suitable for different requirements to operate;
- ▲Monitoring of online flow, temperature, speed, wind speed and negative pressure;
- ▲Multiple groups of program control;
- ▲Large information storage, online printing and output and upload;
- ▲MES system port.

技术参数 Technical parameter

项目 Item	型号 Model	BGB-75F	BGB-150F	BGB-250F	BGB-350F	BGB-600F
生产能力 Production capacity(kg)		75-50-20	150-75-50	250-150-75	350-250-150	600-350
电机功率 Motor power(kw)		1.5	2.2	3	4	5.5
转速 Rotation speed		2-20	2-15	2-15	2-15	2-10
热风机功率 Hot air fan power(kw)		1.1	1.1	1.5	2.2	5.5
排风机功率 Exhaust fan power(kw)		4	5.5	7.5	11	15
蠕动泵功率 Peristaltic pump power(kw)		0.04(BT100L)	0.05(BT300L)	0.05(BT300L)	0.05(BT300L)	0.05(BT600L)
搅拌桶功率 Mixing barrel power(kw)		2	6	9	9	9
耗蒸汽量 Steam consumption(kg/h)		95	95	225	225	252
耗气量 Air consumption(m³/min)		1.18	1.45	2.03	2.03	2.57

注：本公司可按用户要求定制生产
Note: Our company can customize products according to user requirements.

BGB-D 高效包衣机
Auto coating machine with CIP



用途

BGB-D包衣机主要用于制药及食品行业。是片剂、丸剂、糖果等进行有机薄膜包衣、水溶性包衣滴丸包衣、糖衣包衣及巧克力、糖果包衣的一种高效、节能、安全、洁净、符合GMP要求的机电一体化包衣设备。

工作原理

在包衣滚筒回转作用下，素芯在滚筒内连续运动。蠕动泵将包衣介质输送到喷枪喷覆在素芯表面，在负压条件下，进风空气处理单元按设定的程序和工艺参数向片床内供给洁净的热风，对素芯进行干燥；热风通过素芯层底部经排风空气处理单元排出，使喷覆在素芯表面的包衣介质快速形成坚固、细密、光整、圆滑的表面薄膜，完成包衣。

Application

The BGB-D coating machine is mainly used in medicine and food industries. Meeting GMP requirements, it is a kind of mechanically and electrically integrated coating equipment with high efficiency, energy conservation, good safety and good cleanliness for organic film coating, water soluble coating, dripping pill coating, sugar coating, chocolate and candy coating .

Work principle

Under the rotation action of the coating roller, the tablets or pills to be coated make continuous movement in the roller. The peristaltic pump conveys the coating media to the spray gun for spraying them on the surfaces of the tablets or pills to be coated. Under negative pressure, the inlet air handling unit supplies clean hot air to the tablet bed according to the set procedures and process parameters to dry the tablets or pills. The hot air is discharged from the outlet air handling unit at the bottom of the layer of tablets or pills, so that the coating media sprayed on the tablets or pills rapidly form solid, dense, flat and smooth film to complete the coating operation.

特点

- ▲由PLC和HMI组成的控制系统设计合理，编程灵活，可适应各种不同的制药工艺需要，工作可靠，性能稳定，符合GMP要求；
- ▲素芯在流线型导流板搅拌器作用下，翻转流畅，交换频繁，消除了素芯从高处落下和碰撞现象，杜绝碎边和磕边，提高成品率。导流板上表面窄小，避免辅料在其表面的粘附，节约辅料，提高药品质量；
- ▲恒压变量蠕动泵，取消了回流管。滚轮的回转半径随压力变化而随时变动，输出浆料与喷浆量自动平衡，稳定了雾化效果，优化喷雾系统，防止喷枪堵塞，节约辅料，且清洗简单，无死角；
- ▲采用新式喷枪，雾化均匀，喷雾面大，方向可调，喷头不受装量多少影响，喷枪堵塞清洗机构，可使包衣连续运行，缩短包衣时间，节省包衣辅料；
- ▲技术参数实现了定量显示与控制，可编写SOP操作法，用量化指标指导操作，保证了每批药品质量的一致性，完全符合GMP要求。

Features

- ▲The control system consisting of PLC and HMI is designed reasonably with flexible programming, meeting various pharmaceutical process requirements with reliable work and stable performance, conforming to GMP requirements.
- ▲The streamlined diversion plate improve the rate of finished products, reducing broken edges. The narrow upper surface of the diversion plate design improve the adhesion of excipient, saving the excipient and improving medicine quality.
- ▲The constant pressure variable peristaltic pump is used to replace the return flow. The rotation radius of the pan changes with the change of pressure, the output solution and spray volume are automatically balanced, the spray system is optimized, the blocking of the spray gun is avoided, the excipient is saved. Easy to clean without any dead corners.
- ▲It adopts the new type spray gun with even atomizing, large spraying area, adjustable direction. The nozzle is not affected by the loading volume, the anti-blocked device can ensure continuous coating, shorten coating time and save coating excipient.
- ▲Quantitative display and control of technical parameters are realized. SOP operation can be compiled to guide the operation by using quantitative indicators and ensure the consistency of quality of each batch of medicines, fully meeting GMP requirements.

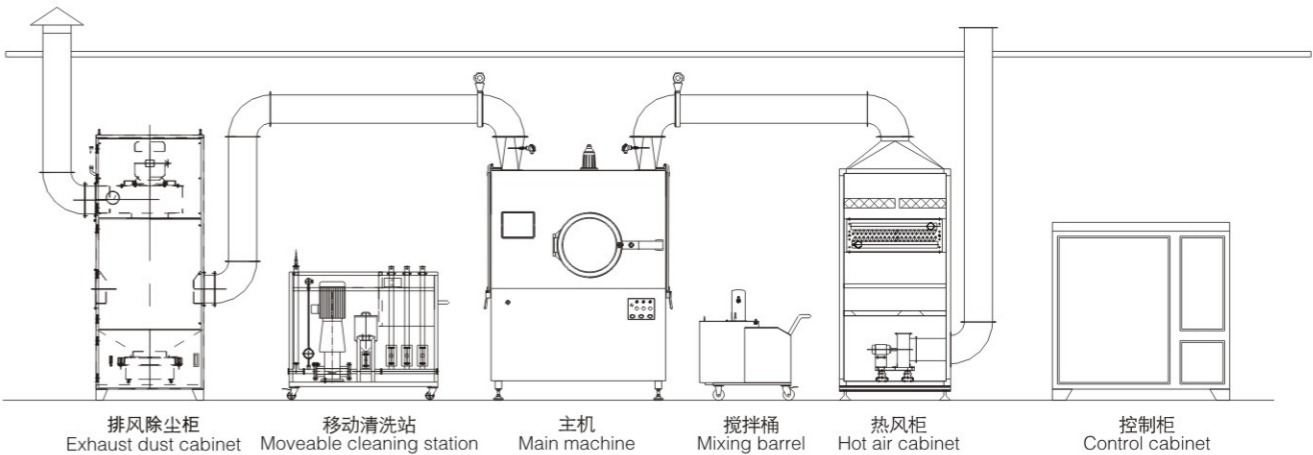

技术参数 Technical parameter

项目 Item	型号 Model	BGB-75D	BGB-150D	BGB-250D	BGB-350D	BGB-600D
生产能力 Production capacity(kg)		75	150	250	350	600
电机功率 Motor power(Kw)		1.5	2.2	3	4	5.5
转速 Rotation speed		2-17	2-15	2-15	2-15	2-6
热风机功率 Hot air fan power(Kw)		1.1	1.1	1.5	2.2	5.5
排风机功率 Exhaust fan power(Kw)		4	5.5	7.5	11	15
蠕动泵功率 Peristaltic pump power(KW)		0.04(BT100L)	0.04(BT300L)	0.05(BT300L)	0.05(BT300L)	0.05(BT600L)
搅拌桶功率 Mixing barrel power(KW)		2	6	9	9	9
电加热功率 Electric heating power(KW)		25	35	39	49	56
耗蒸气量 Steam consumption(Kg/h)		95	95	225	225	252
耗气量 Air consumption(m³/min)		1.18	1.45	2.03	2.03	2.57
主机重量 Weight of main machine(kg)		550	900	1250	1650	2000
外形尺寸 Outline dimensions(L×W×H)(mm)		1200×980×1853	1570×1250×2351	1800×1434×2458	2050×1670×2570	2050×2064×2680
清洗站 Cleaning station	功率 Power(kw)	3	3	3	4	4
	耗水量 Water consumption(T/h)	10	10	10	20	20

注：本公司可按用户要求定制生产
Note: Our company can customize products according to user requirements.

BGB-C 高效包衣机
Auto coating machine

用途

BGB-C包衣机主要用于制药及食品行业。是片剂、丸剂、糖果等进行有机薄膜包衣、水溶性包衣滴丸包衣、糖衣包衣及巧克力、糖果包衣的一种高效、节能、安全、洁净、符合GMP要求的机电一体化的包衣设备。

工作原理

在包衣滚筒回转作用下，素芯在滚筒内连续运动。蠕动泵将包衣介质输送到喷枪喷覆在素芯表面，在负压条件下，进风空气处理单元按设定的程序和工艺参数向片床内供给洁净的热风，对素芯进行干燥；热风通过素芯层底部经排风空气处理单元排出，使喷覆在素芯表面的包衣介质快速形成坚固、细密、光整、圆滑的表面薄膜，完成包衣。

Application

The BGB-C coating machine is mainly used in medicine and food industries. Meeting GMP requirements, it is a kind of mechanically and electrically integrated coating equipment with high efficiency, energy conservation, good safety and good cleanliness for organic film coating, water soluble coating, dripping pill coating, sugar coating, chocolate and candy coating.

Work principle

Under the rotation action of the coating pan, the tablets or pills to be coated make continuous movement in the pan. The peristaltic pump conveys the coating solution to the spray gun for spraying them on the surfaces of the tablets or pills to be coated. Under negative pressure, the inlet air handling unit supplies clean hot air according to the set procedures and process parameters to dry the tablets or pills. The hot air is discharged from the outlet air handling unit, so that the coating solution sprayed on the tablets or pills rapidly form solid, dense, flat and smooth film to complete the coating operation.



特点

- ▲由PLC和HMI组成的控制系统设计合理，编程灵活，可适应各种不同的制药工艺需要，工作可靠，性能稳定，符合GMP要求；
- ▲采用新式喷枪，雾化均匀，喷雾面大，方向可调，喷头不受装量多少影响，喷枪堵塞清洗机构，可使包衣连续运行，缩短包衣时间，节省包衣辅料；
- ▲技术参数实现了定量显示与控制，可编写SOP操作法，用量化指标指导操作，保证了每批药品质量的一致性，完全符合GMP要求。

Features

- ▲The control system consisting of PLC and HMI is designed reasonably with flexible programming, meeting various pharmaceutical process requirements with reliable work and stable performance and conforming to GMP requirements.
- ▲It adopts the new type spray gun with even atomizing, large spraying area, adjustable direction. The nozzle is not affected by the loading volume, the anti-blocked device can ensure continuous coating, shorten coating time and save coating excipient.
- ▲Quantitative display and control of technical parameters are realized. SOP operation can be compiled to guide the operation by using quantitative indicators and ensure the consistency of quality of each batch of medicines, fully meeting GMP requirements.

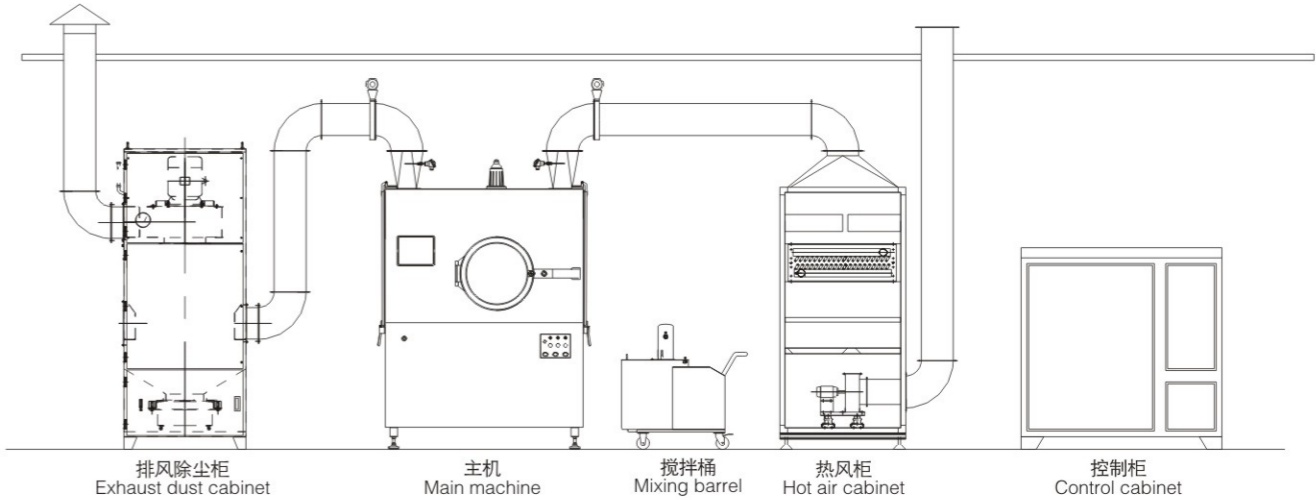

技术参数 Technical parameter

项目	型号	BGB-75C	BGB-150C	BGB-250C	BGB-350C	BGB-600C
生产能力 Production capacity(kg)		75	150	250	350	600
电机功率 Motor Power(Kw)		1.5	2.2	3	4	5.5
转速 Rotation speed		2-17	2-15	2-15	2-15	2-6
热风机功率 Hot air fan power(Kw)		1.1	1.1	1.5	2.2	5.5
排风机功率 Exhaust fan power(Kw)		4	5.5	7.5	11	15
蠕动泵功率 Peristaltic pump power(KW)		0.04(BT100L)	0.04(BT300L)	0.05(BT300L)	0.05(BT300L)	0.05(BT600L)
搅拌桶功率 Mixing barrel power(KW)		2	6	9	9	9
电加热功率 Electric heating power(KW)		25	35	39	49	56
耗蒸汽量 Steam consumption(Kg/h)		95	95	225	225	252
耗气量 Air consumption(m³/min)		1.18	1.45	2.03	2.03	2.57
主机重量 Weight of main machine(kg)		550	900	1250	1650	2000
外形尺寸 Outline dimensions(L×W×H)(mm)		1200×980×1853	1570×1250×2351	1800×1434×2458	2050×1670×2570	2050×2064×2680

注：本公司可按用户要求定制生产
Note: Our company can customize products according to user requirements.



BGB-F 实验型包衣机
Laboratory coating machine

用途

BGB-F包衣机主要用于制药及食品行业。是片剂、丸剂、糖果等进行有机薄膜包衣、水溶性包衣滴丸包衣、糖衣包衣及巧克力、糖果包衣的一种高效、节能、安全、洁净、符合GMP要求的机电一体化的包衣设备。

工作原理

在包衣滚筒回转作用下，素芯在滚筒内连续运动。蠕动泵将包衣介质输送到喷枪喷覆在素芯表面，在负压条件下，进风空气处理单元按设定的程序和工艺参数向片床内供给洁净的热风，对素芯进行干燥；热风通过素芯层底部经排风空气处理单元排出，使喷覆在素芯表面的包衣介质快速形成坚固、细密、光整、圆滑的表面薄膜，完成包衣。

Application

The BGB-F coating machine is mainly used in medicine and food industries. Meeting GMP requirements, it is a kind of mechanically and electrically integrated coating equipment with high efficiency, energy conservation, good safety and good cleanliness for organic film coating, water soluble coating, dripping pill coating, sugar coating, chocolate and candy coating.

Work principle

Under the rotation action of the coating roller, the tablets or pills to be coated make continuous movement in the roller. The peristaltic pump conveys the coating media to the spray gun for spraying them on the surfaces of the tablets or pills to be coated. Under negative pressure, the inlet air handling unit supplies clean hot air to the tablet bed according to the set procedures and process parameters to dry the tablets or pills. The hot air is discharged from the outlet air handing unit at the bottom of the layer of tablets or pills, so that the coating media sprayed on the tablets or pills rapidly form solid, dense, flat and smooth film to complete the coating operation.



特点

- ▲可以根据包衣工艺批量的多少更换适合的包衣机滚筒；
- ▲包衣机滚筒的更换方便快捷；
- ▲主机与热风系统互为一体，结构紧凑，洁净区采风。

Features

- ▲Changeable coating pans can be replaced according to the different batch size.
- ▲Easy operation to replace the coating pan.
- ▲With compact and intergrated structure, air intake at the clean area.

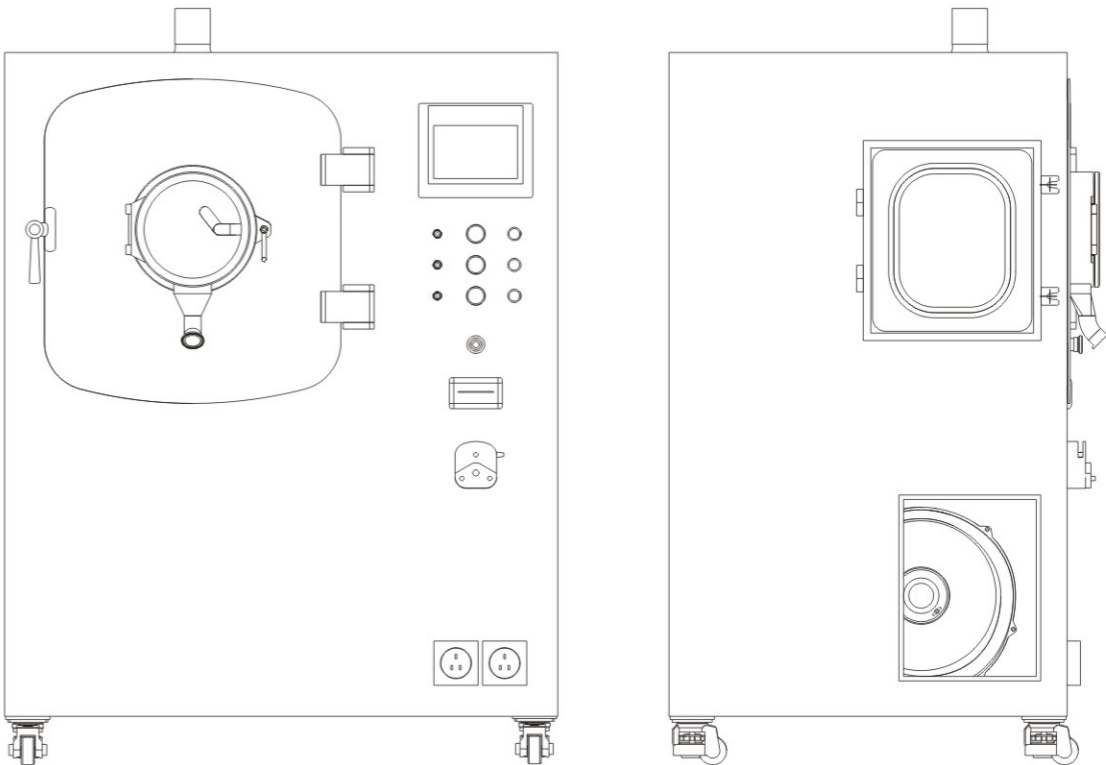

技术参数 Technical parameter

项目 Item	型号 Model	BGB-5F	BGB-10F	BGB-20F	BGB-40F
生产能力 Production capacity(kg)		1-3-5	10-5-3	5-10-20	20-40
电机功率 Motor Power(Kw)		0.37	0.55	0.55	1.10
转速 Rotation speed		2-30	2-30	2-26	2-26
热风机功率 Hot air fan power(Kw)		0.4	0.4	0.4	0.75
排风机功率 Exhaust fan power(Kw)		0.75	1.5	2.2	3
蠕动泵功率 Peristaltic pump power(KW)		0.04(BT100L)	0.04(BT100L)	0.04(BT100L)	0.04(BT100L)
搅拌桶功率 Mixing barrel power(KW)		/	1	1	2
电加热功率 Electric heating power(KW)		5	10.5	10.5	14.7
耗蒸气量 Steam consumption(Kg/h)		67	90	90	90
耗气量 Air consumption(m³/min)		0.45	0.65	0.65	0.65
主机重量 Weight of main machine(kg)		450	450	500	600

注：本公司可按用户要求定制生产
Note: Our company can customize products according to user requirements.

BGB-M 高密闭包衣机
Containment coating machine



用途

高密闭包衣机主要适用于API高活性物料的片剂包衣，严密的隔离系统保证了操作者、物料和环境的安全，同时实现多个包衣工艺步骤的进行。

工作原理

在包衣滚筒回转作用下，素芯在滚筒内连续运动。蠕动泵将包衣介质输送到喷枪喷覆在素芯表面，在负压条件下，进风空气处理单元按设定的程序和工艺参数向片床内供给洁净的热风，对素芯进行干燥；热风通过素芯层底部经排风空气处理单元排出，使喷覆在素芯表面的包衣介质快速形成坚固、细密、光整、圆滑的表面薄膜，完成包衣。

Application

The containment coating machine is mainly suitable for tablet coating of API materials. The isolation system ensures the safety of operators, materials and environment, and realizes multiple coating process.

Work principle

Under the rotation action of the coating pan, the tablets or pills to be coated make continuous movement in the pan. The peristaltic pump conveys the coating solution to the spray gun for spraying them on the surfaces of the tablets or pills to be coated. Under negative pressure, the inlet air handling unit supplies clean hot air according to the set procedures and process parameters to dry the tablets or pills. The hot air is discharged from the outlet air handling unit, so that the coating solution sprayed on the tablets or pills rapidly form solid, dense, flat and smooth film, thus the coating operation finish.



特点

- ▲PLC可编程控制器程序自动控制；
- ▲触摸式液晶屏人机对话界面，人性化设计；
- ▲三级管理员密码进入；
- ▲计算机远程通讯功能(选配)；
- ▲数据导出及打印功能；
- ▲自动运行、手动运行模式；
- ▲温湿度及压差监测功能；
- ▲失压报警功能(声光信号)；
- ▲舱内照明：照度≥3001X；
- ▲可预留尖埃粒子、浮游菌、沉降菌检测口；
- ▲预留灭菌接口；
- ▲可在线清洗；
- ▲达到OEB4标准；
- ▲除尘采用袋进袋出方式更换滤芯。

Features

- ▲PLC programmable controller, automatic control program;
- ▲HMI interface, easy operation;
- ▲Three-level administrator password;
- ▲Remote communication function (optional);
- ▲Data export and print function;
- ▲Automatic operation& manual operation mode;
- ▲Temperature and humidity and differential pressure monitoring function;
- ▲Pressure alarm function (sound and light signal);
- ▲Lighting: illuminance ≥ 3001x;
- ▲Reserve detection port of dust particle, floating bacteria and sedimentation bacteria;
- ▲Reserve port for sterilization;
- ▲CIP cleaning;
- ▲Meet the OEB4 standard;
- ▲Push-push filter for getting rid of dust.

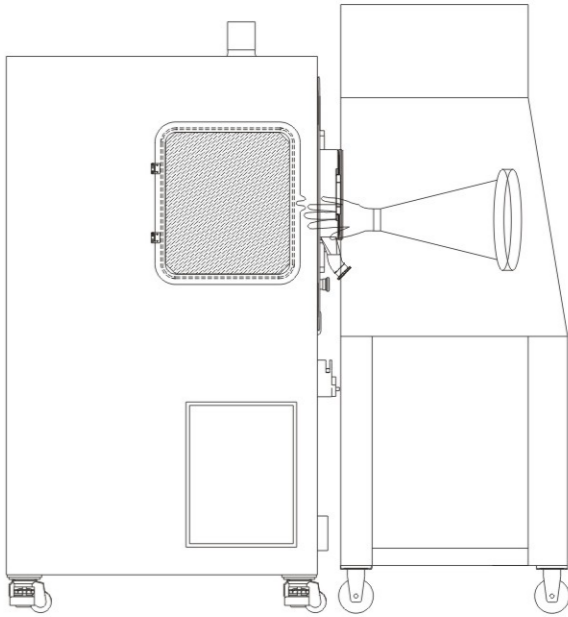
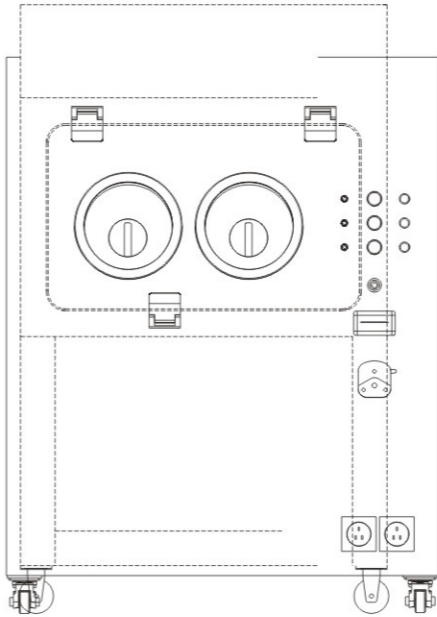

技术参数 Technical parameter

项目 Item	型号 Model	BGB-5M	BGB-10M	BGB-20M	BGB-40M
生产能力 Production capacity(kg)		1-3-5	10-5-3	5-10-20	20-40
电机功率 Motor Power(Kw)		0.37	0.55	0.55	1.10
转速 Rotation speed		2-30	2-30	2-26	2-26
热风机功率 Hot air fan power(Kw)		0.4	0.4	0.4	0.75
排风机功率 Exhaust fan power(Kw)		0.75	1.5	2.2	3
蠕动泵功率 Peristaltic pump power(KW)		0.04(BT100L)	0.04(BT100L)	0.04(BT100L)	0.04(BT100L)
搅拌桶功率 Mixing barrel power(KW)		/	1	1	2
电加热功率 Electric heating power(KW)		5	10.5	10.5	14.7
耗蒸气量 Steam consumption(Kg/h)		67	90	90	90
耗气量 Air consumption(m³/min)		0.45	0.65	0.65	0.65
主机重量 Weight of main machine(kg)		450	450	500	600

注：本公司可按用户要求定制生产
Note: Our company can customize products according to user requirements.

WH 全自动丸化包衣机

Automatic pill coating machine

用途

主要应用于丸粒化的品种需要层层包覆的加工方式，目前可以加工核心直径在0.02~10mm的各类规则或不规则的包衣加工，利用粘合剂作用将核心层层裹附包衣层的实现过程，可实现一次性投入一定量的核心产品，实现全自动的包衣过程。目前应用较多的在农业种子，食品，化工行业。

自动包衣丸化产品质量不但要满足质量标准，还要在外观、强度、裂解等指标上进一步提高。自动包衣丸化设备要实现核心一次成形。

工作原理

根据包衣的工艺特性自动上料过程，一次性投入适量的包衣核心，调整喷枪的雾化效果，以及对应的角度，开启自动包衣过程。核心原料经过高速离心后形成外圈环流，在导流片的作用下，核心翻转跌落至中环以及内环，粘合剂喷洒在跌落的抛物线上，结合添加的包衣粉剂，迅速包裹起来。离心的过程中，核心和包衣粉以及粘合剂受到离心力的作用与筒壁以及转盘的摩擦将包衣粉压实，形成一定强度的包衣裹附。无数次的循环后达成所需的成品粒径。完成包衣丸粒化过程。



Application

It is mainly used in the processing of pelletized varieties that require layer coating. At present, various types of regular or irregular coating processing with core diameters of 0.02~10mm can be processed, and the core layer is wrapped with adhesive. The realization process of the coating layer can realize a one-time input of a certain amount of core products and realize a fully automatic coating process. At present, there are more applications in the agricultural seeds, food, and chemical industries. The quality of automatic coating pill products should not only meet the quality standards, but also further improve the appearance, strength, cracking and other indicators. Automatic coating of pelletizing equipment to achieve seed formation.

Work principle

Starting the automatic coating process after adjusting the spray gun angle and flow amount. The core is subjected to high-speed centrifugation to form an outer ring circulation. Under the action of the baffle, the core is flipped and dropped to the middle ring and the inner ring. The adhesive is sprayed on the falling parabola, combined with the added coating powder, quickly wrapped. During the centrifuged process, the core and the coating powder and the binder are subjected to the centrifugal force to compact and form firm coating. The required finished particle size is achieved after numerous cycles.

特点

- ▲ 一次性投入可自动完成预期的增大丸粒化；
- ▲ 确保核心的完整性、均匀性、个体独立；
- ▲ 省核省料，降低生产成本；
- ▲ 有利于提高各项裂解及性能；
- ▲ 对于内核小且不规则的核心，经丸化处理后，可使整体体积增大，形状、大小均匀一致，有利于机械化操作。

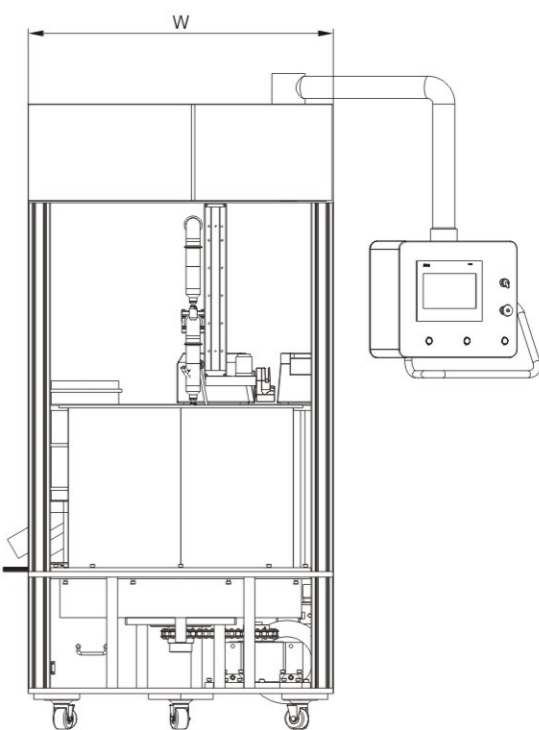
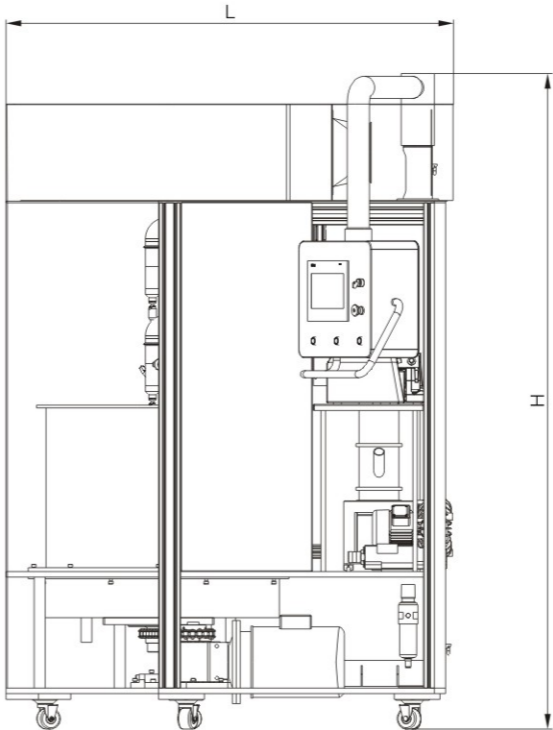

Features

- ▲ Automatically complete the expected pelleting size by one-time feed;
- ▲ Ensure core integrity, uniformity, and individual independence;
- ▲ Save core and excipient, low production costs;
- ▲ Improve the cracking and performance;
- ▲ For the mini and irregular core, the overall volume can be increased and the shape and size are uniform after the pelletization treatment, which is good to mechanized operation.

技术参数 Technical parameter

项目 Item	型号 Model	WH-5	WH-10	WH-20	WH-50
产能(核心)批次 Capacity (core) batch(kg/批batch)		0.5	1	2	5
核心规格 Core specification(mm)		0.02~10			
增量倍数 Incremental multiple		< 100		< 60	
容量 Volume(L)		240	300	400	600
喷枪 Spray gun(PC)		2	2	2	3
功率 Power(kw)		5	7	9	15
外形尺寸 Outline dimensions(mm)		900 × 600 × 2000	1100 × 700 × 2500	1200 × 800 × 2700	1500 × 900 × 2700

注：本公司可按用户要求定制生产
Note: Our company can customize products according to user requirements.



ATG 全自动提升加料机
Automatic lifting feeder

用途

此设备主要用于制药、食品、化工行业的粉状、颗粒状、片状等固体物料的输送、提升、加料，主要与混合机、压片机、包衣机、胶囊填充机、包装机等设备配套使用。

工作原理

本设备主要由固定底座，提升系统，旋转系统以及轴转系统组成，步进或伺服电机连接减速电机为驱动源，配合电机刹车实现安全高速位移以及防止跌落措施，实现快速定位。可以根据程序设定运动路线，即可实现一键式操作。



Application

This machine is mainly used for conveying, lifting and feeding of solid materials such as powder, granule and flake in pharmaceutical, food and chemical industries. It is supporting equipment for blenders, tablet presses, coating machines, capsule filling machines, packaging machines, etc.

Work principle

The equipment mainly consists of a fixed base, a lifting system, a rotating system and a shaft-turning system. The servo motor is connected to the geared motor as the driving source, and the motor brake is used to achieve high-speed safe movement and positioning, and it is equipped with anti-falling devices. One-touch operation can be realized by setting the movement route according to the program.

特点

- ▲一键式自动完成夹紧-提升-旋转-下降-放料-复位工序，传动动力为步进电机驱动，控制精准，彻底改善液压油的各种问题，更洁净，更环保，电机附带刹车装置，对突然意外断电起到保护作用，桶与提升叉臂采用气胀轴固定，操作更自动方便，全程限位装置，可以在任意位置启停，更安全；
- ▲立柱门帘改为不锈钢带，更符合FDA规范，美观耐用；
- ▲直线式导轨，抗扭矩力更大，直线运动更平稳；
- ▲采用双排链结构，提高了负载，运行更平稳；
- ▲采用先进的工业重型支撑轴承，主臂在运动过程中设备负载安全系数；
- ▲采用中封式电磁阀，实时压力检测，起到意外断气保护作用，气胀轴可持续保障加载状态；
- ▲增加叉臂旋转结构，对接更精准，亦可作为单臂混合机使用(叉臂旋转混合提升机)。

Features

- ▲Automatic completion of clamping-lifting-rotating-down-discharging-resetting process by one-touch button operation.
- ▲Driving power is driven by stepper motor instead of hydraulic oil;
- ▲The motor with brake protects in case of power failure;
- ▲The air expansion shaft is used to fix the barrel and the lifting fork arm;
- ▲start and stop freely at any position by limit position device;
- ▲Stainless steel belt is used to replace the column curtain;
- ▲Linear guide rail, more resistance to torque, smoother linear motion;
- ▲The double-row chain structure improves the load and makes the operation more stable;
- ▲Using the medium-sealed solenoid valve, real-time pressure detection, it plays the role of accidental gas-breaking protection, and the gas-up axis can guarantee the loading state;
- ▲add the fork arm rotation structure, precise docking, also be used as a single-column blender (fork-arm rotary lifting blender).

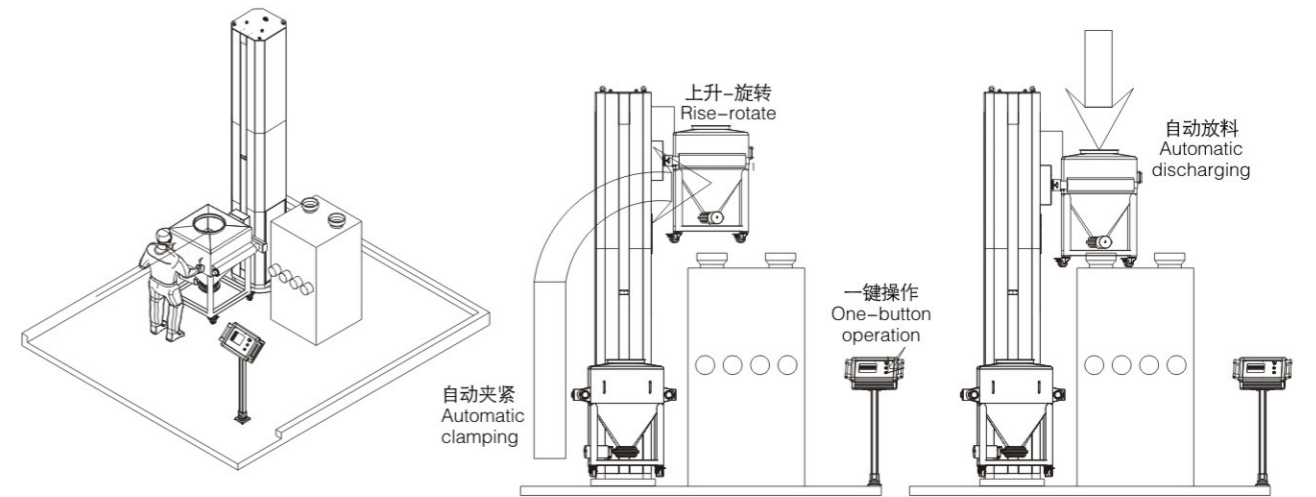

技术参数 Technical parameter

型号 Model	净负载 Net load(kg)	电机功率(KW) Motor power	驱动轴 Drive axis		外形尺寸 Outline dimensions (mm)
ATG-200	200	7	2轴(标配) 提升、主臂旋转 2-axis (standard) lift, main arm rotation	3轴(选配) 提升、主臂旋转、载臂旋转 3-axis (optional) lift, main arm rotation, arm rotation	根据用户要求设计 Designed according to user requirements
ATG-400	400	12			
ATG-600	600	18			
ATG-800	800	22			

注：本公司可按用户要求定制生产
Note: Our company can customize products according to user requirements.

YTG 固定提升机
Fixed lifting machine

用途

此设备主要应用于制药工业固体物料的输送、加料。可与混合机、压片机、胶囊充填机等设备配套使用。同时在制药、化工、食品等行业中广泛使用。

工作原理

该机主要由底盘、立柱、提升系统等部件组成。工作时，先将装有物料的料斗推入料斗提升机的提升叉架上，然后启动提升按钮，料斗做提升运动，料斗到位后转动底盘与加料的设备密闭对接，开启出料蝶阀，使物料密闭转移到下工序。



Application

The machine is mainly used for conveying and charging solid materials in the pharmaceutical industry. It can work with the mixer, tablet press, capsule filler, etc. It is also widely used in such industries as medicine, chemical industry, food, etc.

Work principle

The machine is mainly composed of chassis, column, lifting system, etc. When it works, push the hopper loaded with materials into the lifting crotch of the hopper lifter. Press the lifting button and the hopper will make lifting movement. After the hopper reaches the designated position, rotate the chassis to realize closed connection with the charging equipment. Start the discharging butterfly valve to transfer the materials to the next procedure.

特点

该机是我司广泛吸收、消化国外先进技术，结合国情研发成功的新机型。结构合理，性能稳定，操作方便，整机无死角，无外露螺钉。该机易于清洗，有效地控制粉尘与交叉污染，优化了生产工艺，完全符合药品生产的GMP要求。

Features

The machine is a new machine researched and developed successfully by our company according to China's actual conditions after absorbing and digesting internationally advanced technology. It has such features as reasonable structure, stable performance, convenient operation, no dead corners, and no exposed bolts. The machine is easy to clean, effectively controls dust pollution and cross contamination, optimizes production processes, and fully meets GMP requirements for medicine production.

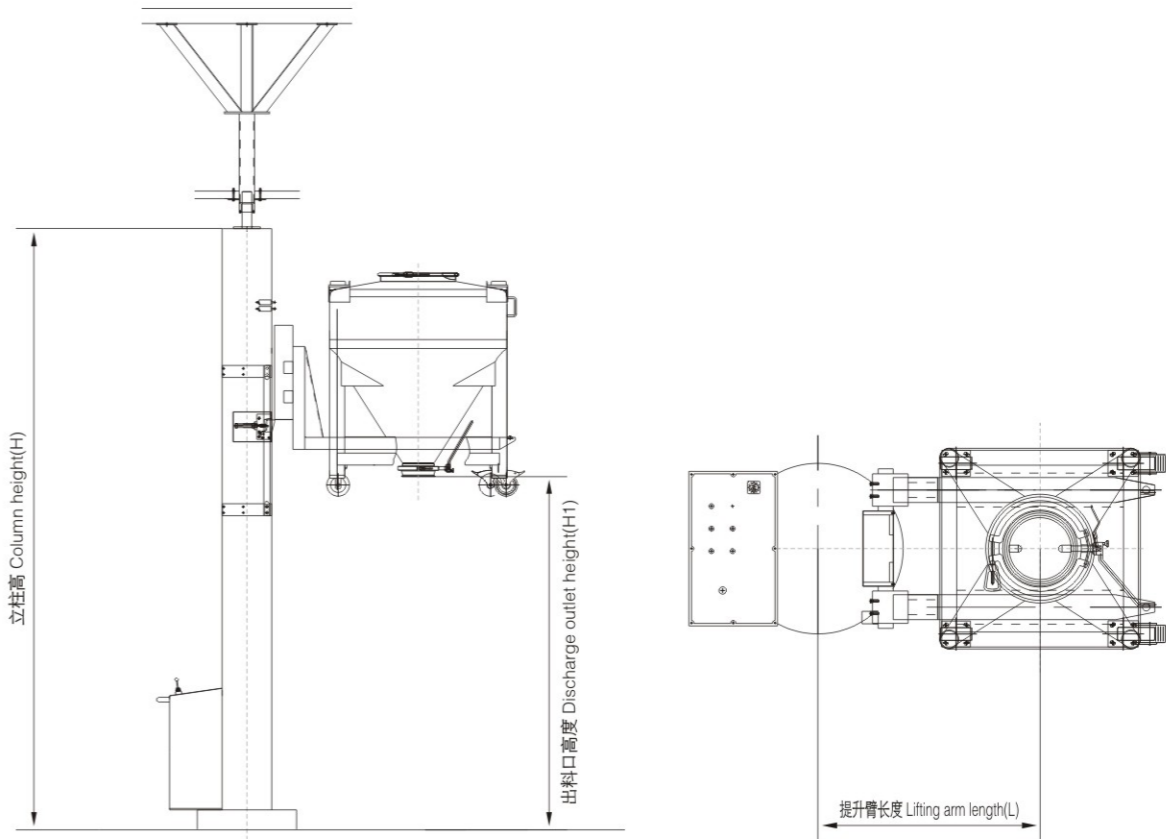

技术参数 Technical parameter

型号 Model	净负载 Net load(kg)	液压站容积 Hydraulic station volume	液压站功率 Hydraulic station power	H	H1	L
YTG-200	200	21L	2.2kw	根据用户要求设计 Designed according to user requirements		
YTG-300	300					
YTG-400	400					
YTG-500	500					
YTG-600	600	31L or 54L	3.0kw			
YTG-800	800					
YTG-1000	1000					
YTG-1200	1200					
YTG-1500	1500					

注：本公司可按用户要求定制生产
Note: Our company can customize products according to user requirements.

YTY 移动提升机

Moveable lifting machine

用途

此设备主要应用于制药工业固体物料的输送、加料。可与混合机、整粒机、压片机、包衣机、胶囊充填机等设备配套使用。同时在制药、化工、食品等行业中广泛使用。

工作原理

该机主要由底盘、立柱、提升系统等部件组成。工作时，先将装有物料的料斗推入料斗提升机的提升叉架上，然后启动提升按钮，料斗做提升运动，料斗到位后转动底盘与加料的设备密闭对接，开启出料蝶阀，使物料密闭转移到下工序。



Application

The machine is mainly used for conveying and charging solid materials in the pharmaceutical industry. It can work with the mixer, granule mill machine, tablet press, coating machine, capsule filling machine, etc. It is also widely used in medicine, chemical, food industries and so on.

Work principle

The machine is mainly composed of chassis, column, lifting system, etc. When it works, push the bin loaded with materials into the lifting fork of the lifter, start the lifting button and the bin will make lifting movement. After the bin reaching the designated position, rotate the chassis to realize closed connection with the charging equipment. Start the discharging butterfly valve to transfer the materials to the next process.

特点

采用PLC程序控制伺服电机驱动，抗过载能力强，低速运行平稳，可控性好，响应快速，灵敏度高，发热和噪音明显降低。设备简洁新型，易操作，料斗出料蝶阀易拆卸清洗，符合制药工业“GMP”；设备重量轻，载荷能力大，运行稳定性好；车轮大，滚动阻力小，容易移动；多用途、省时、省力、减少环境污染；维护要求低，维护费用少。

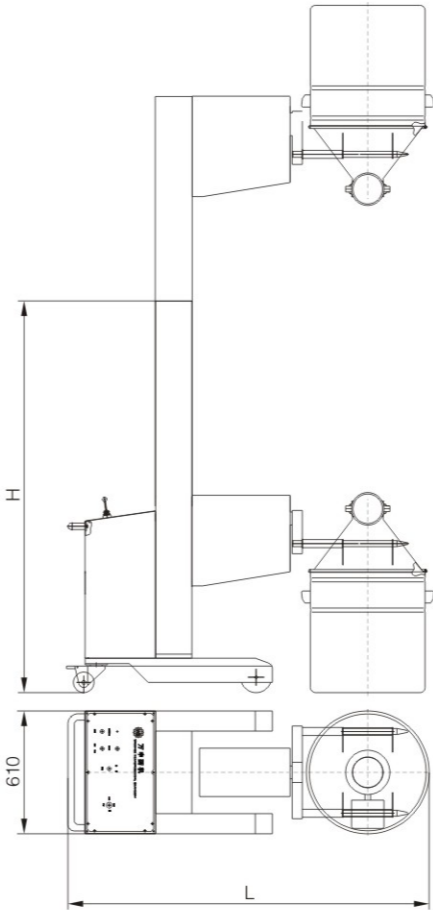

Features

The PLC program is used to control the servo motor drive, which has strong anti-overload capability, stable operation at low speed, good controllability, fast response, high sensitivity, and significantly reduces heat and noise. The new type equipment is concise and easy to operate. The bin discharging butterfly valve is easy to assemble, disassemble and clean, meeting GMP requirements in the pharmaceutical industry. The equipment has the advantages of light weight, large load and good running stability. The cart wheels are large with low rolling resistance and easy movement. It has multiple purposes, saving time, saving labor and reducing environmental pollution. It has low maintenance requirements, which can reduce the maintenance cost.



技术参数 Technical parameter

型号 Model	净负载 Net load(kg)	液压站容积(L) Hydraulic station volume	液压站功率(kw) Hydraulic station power	H	L
YTY-100	100	18	1.5	1950	根据用户要求设计 Designed according to user requirements
YTY-150	150				
型号 Model	净负载 Net load(kg)	电动功率 Electric power(kw)			
YTD-150	150	1.5			

注：本公司可按用户要求定制生产
Note: Our company can customize products according to user requirements.

CT 层间提升机

Lifting machine among floors

用途

层间提升机主要用于制药工业中固体物料(袋装、桶装)楼层间二个不同洁净区域的上下输送。该机有效地减少了粉尘的交叉污染,减轻了劳动强度,完全符合药品生产“GMP”的要求,是理想的物料输送设备,同时在化工、食品、电子等行业广泛使用。

工作原理

层间提升机,主要由立柱、提升平台系统、控制系统等组成,工作时,将物料送入提升平台,关好安全护栏,启动控制面板上的提升操作杆,将物料提升到位,锁定上限位装置,提升平台停止运动,打开安全护栏,推出物料,完成物料层间上下输送。



Application

The machine is mainly used for upward and downward conveying of solid materials (bagged, barreled) at two different clean areas among floors in the pharmaceutical industry. The machine effectively reduces cross contamination of dust, lowers labor intensity and fully meets GMP requirements for medicine production. It is an ideal material conveying machine. It is also widely used in chemical, food, electronics and so on industries.

Work principle

The lifting machine among floors is mainly composed of column, lifting platform system, control system, etc. When it works, first send the materials to the lifting platform, close the safety fence and start the lifting operation lever on the control panel to lift the materials to the designated position, lock the upper limit device, when the lifting platform stops movement, open the safety fence and push out the materials to complete upward and downward conveying of materials among floors.

特点

- ▲该机立柱结构采用坚固的钢架,特制的两根重型铲车槽钢经焊接成立体强度,外表面用亚光型不锈钢花纹板制造,方便清洁。
- ▲提升槽进行了帘布式隔离处理,符合洁净区对设备的要求。
- ▲设有楼层间安全电气联锁和上下限位装置,确保设备动作过程中的安全,完全符合药品生产的“GMP”要求。

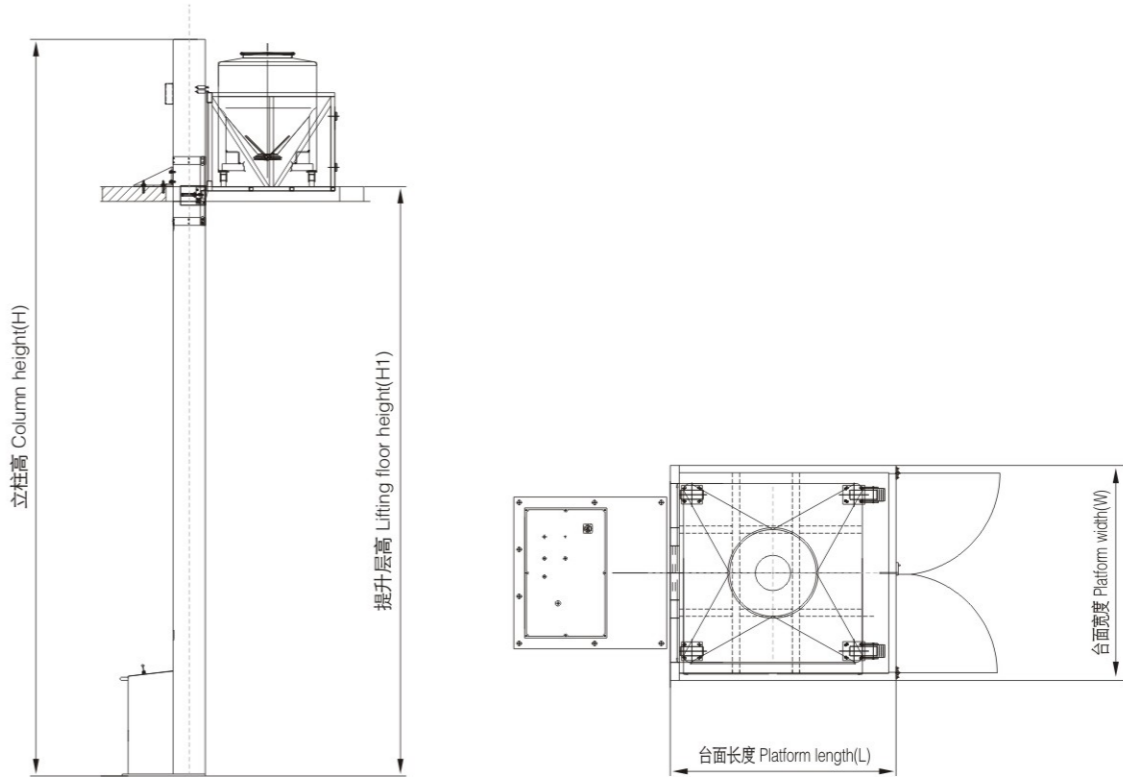

Features

- ▲The column structure of the machine is made of solid steel frame. The two pieces of special heavy forklift channel steel have high strength after welding. The exterior surfaces are made of matte stainless steel pattern plate, which is easy to clean.
- ▲The lifting groove is separated by curtain, which meets the requirement of clean area.
- ▲It is equipped with safety electric interlocking and upper and lower limit devices among floors to ensure equipment safety during the movement, fully meeting GMP requirements for medicine production.

技术参数 Technical parameter

型号 Model	净负载 Net load(kg)	液压站容积 Hydraulic station volume	液压站功率 Hydraulic station power	H	H1	W	L
CT-200	200	34L	2.2kw	根据用户要求设计 Designed according to user requirements			
CT-300	300						
CT-400	400						
CT-500	500						
CT-600	600	31L or 54L	3.0kw				
CT-800	800						
CT-1000	1000						
CT-1200	1200						
CT-1500	1500						

注: 本公司可按用户要求定制生产
Note: Our company can customize products according to user requirements.

ZLXHD 多功能料斗清洗机
Multifunctional bin cleaning machine



用途

ZLXHD系列料斗清洗机主要用于制药、化工、食品等行业的不锈钢料桶、IBC周转料斗、混合周转料斗的清洗。ZLXHD系列料斗清洗机可以有效清洗残留在料斗内、外表面的异物，从而防止生产过程中各种成份交叉污染，是制药企业必备的理想设备。同时是制药企业固体制剂药品生产过程中能否达到GMP规范要求的必要装备之一。

工作原理

将料斗推入清洗室内定好位，关好门，启动清洗机，清洗机自动按设定好的程序对料斗进行清洗、烘干、冷却，等所有程序运转完成后，打开清洗室门，把料斗推出，送至存放站保存，以备生产使用。

Application

The ZLXHD series bin cleaning machine is mainly used for cleaning stainless steel drums, IBC transfer bin and mixing transfer bins in medicine, chemical, food and so on industries. The ZLXHD series bin cleaner can effectively clean foreign matters remaining on the inner and outer surfaces of the bin to avoid cross contamination of various ingredients during the production. It is an indispensable machine in pharmaceutical enterprises. It is also one of the necessary equipment for pharmaceutical enterprises to meet the requirements of GMP in the production process of solid pharmaceutical preparations.

Work principle

Push the bin into the cleaning room and position it, close the door and start the cleaner. The cleaner will carry out cleaning, drying and cooling of the bin according to the set procedures. After all procedures are completed, open the cleaning machine door and push out the bin and send it to the storage station for future use.

特点

- ▲为容器清洗提供统一的清洗标准，易于清洗过程的追溯和认证。
- ▲提高了生产效率。
- ▲减轻了工人的劳动强度。
- ▲设备集清洗、烘干、冷却一体化功能，全程由PLC控制，自动化程度高，操作简单。
- ▲自动记录运行参数，可验证运行结果。

Features

- ▲It provides uniform cleaning standard for the cleaning of vessels and easily makes the traceability and certification of the cleaning process.
- ▲It improves production efficiency.
- ▲It reduces labor intensity of workers.
- ▲The equipment is a machine integrating cleaning, drying and cooling functions. It adopts PLC control during the whole course, which is with high degree of automation and simple operation.
- ▲The running parameters are recorded automatically to verify the running results.

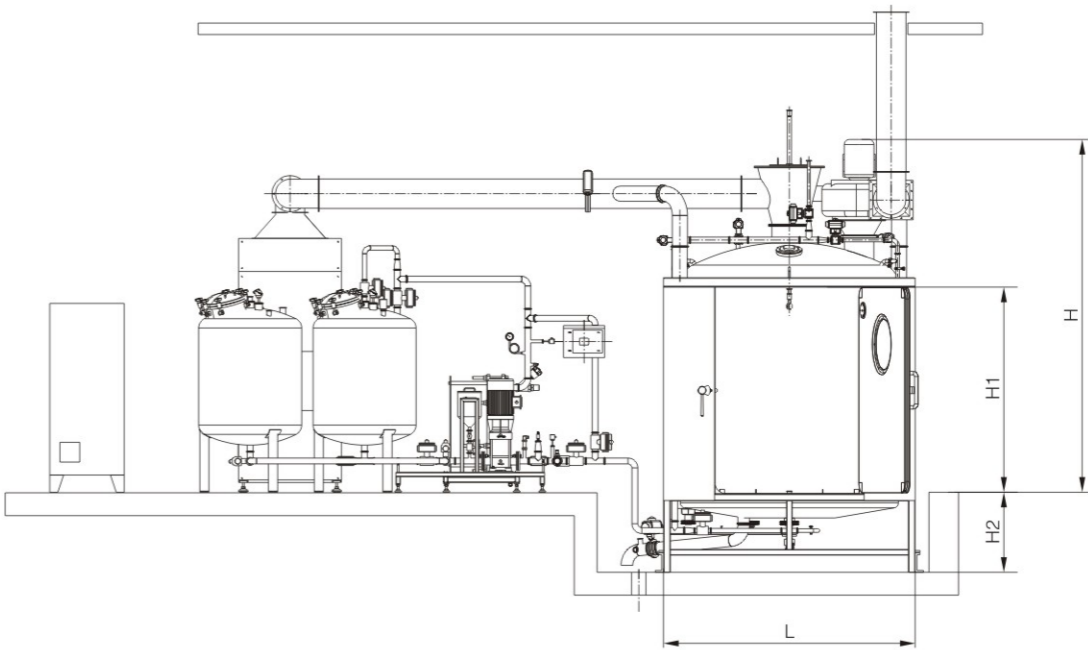

技术参数 Technical parameter

项目 Item	型号 Model	ZLXHD-600	ZLXHD-800	ZLXHD-1000	ZLXHD-1200	ZLXHD-1500	ZLXHD-2000
总功率 Total power(Kw)		12.25	12.25	12.25	12.25	12.25	12.25
水泵功率 Pump power(Kw)		4	4	4	4	4	4
水泵流量 Pump flow(t/h)		20	20	20	20	20	20
泵压力 Pump pressure(Mpa)		0.35	0.35	0.35	0.35	0.35	0.35
引风机功率 Induced draft fan power(Kw)		2.2	2.2	2.2	2.2	2.2	2.2
排风机功率 Exhaust fan power(Kw)		5.5	5.5	5.5	5.5	5.5	5.5
蒸汽压力 Steam pressure(Mpa)		0.4-0.6	0.4-0.6	0.4-0.6	0.4-0.6	0.4-0.6	0.4-0.6
蒸汽流量 Steam flow(kg/h)		1300	1300	1300	1300	1300	1300
压缩空气压力 Compressed air pressure(Mpa)		0.4-0.6	0.4-0.6	0.4-0.6	0.4-0.6	0.4-0.6	0.4-0.6
压缩空气耗量 Compressed air consumption(m³/min)		3	3	3	3	3	3
整机重量 Equipment weight(t)		4	4	4.2	4.2	4.5	4.5
外形尺寸 Outline dimensions (mm)	L	2000	2000	2200	2200	2200	2200
	H	2820	3000	3100	3240	3390	3730
	H1	1600	1770	1800	1950	2100	2445
	H2	700	700	700	700	700	700

注：本公司可按用户要求定制生产
Note: Our company can customize products according to user requirements.



ZLXHS 双腔料斗清洗机

Double chamber bin cleaning machine



用途

ZLXHS 系列双腔料斗清洗机主要用于制药、化工、食品等行业的不锈钢料桶、IBC 周转料斗、混合周转料斗的清洗。
ZLXHS 系列双腔料斗清洗机可以有效清洗残留在料斗内、外表面的异物，从而防止生产过程中各种成分交叉污染，是企业必备的理想设备。同时是制药企业固体制剂药品生产过程中能否达到 GMP 规范要求的必要装备之一。

工作原理

该机是由输送系统、清洗室、干燥室、泵站、空气处理单元、电气柜、操作箱等部分组成。料斗的输送、清洗、干燥、冷却按系统设定自动完成。工作时，人工将料斗推上输送系统，料斗经由自动输送，在第一腔体完成清洗工作，再由自动输送系统到第二腔体内进行烘干，冷却最后停在干燥室外，由人工移走，送到存放站保存，以备生产使用。

Application

The ZLXHS series double chamber bin cleaning machine is mainly used for cleaning stainless steel drums, IBC transfer bins and mixing transfer bins in medicine, chemical, food and so on industries.
The ZLXHS series double chamber bin cleaning machine can effectively clean foreign matters remaining on the inner and outer surfaces of the bin to avoid cross contamination of various ingredients during the production. It is an indispensable machine in pharmaceutical enterprises. It is also one of the necessary equipment for pharmaceutical enterprises to meet the requirements of GMP in the production process of solid pharmaceutical preparations.

Work principle

The machine is composed of conveying system, cleaning chamber, drying chamber, pumping station, air handling unit, electric cabinet, operation cabinet, etc. The conveying, cleaning, drying and cooling of bin are automatically completed according to the set system. When working, the bin is manually pushed into the conveying system and the bin is automatically conveyed to complete cleaning, drying. The cleaning is completed in the first chamber, and then the automatic conveying system is transferred to the second chamber for drying, the bin Cooling and finally stopping outside the drying room. It is manually removed and stored at the storage station for future production use.

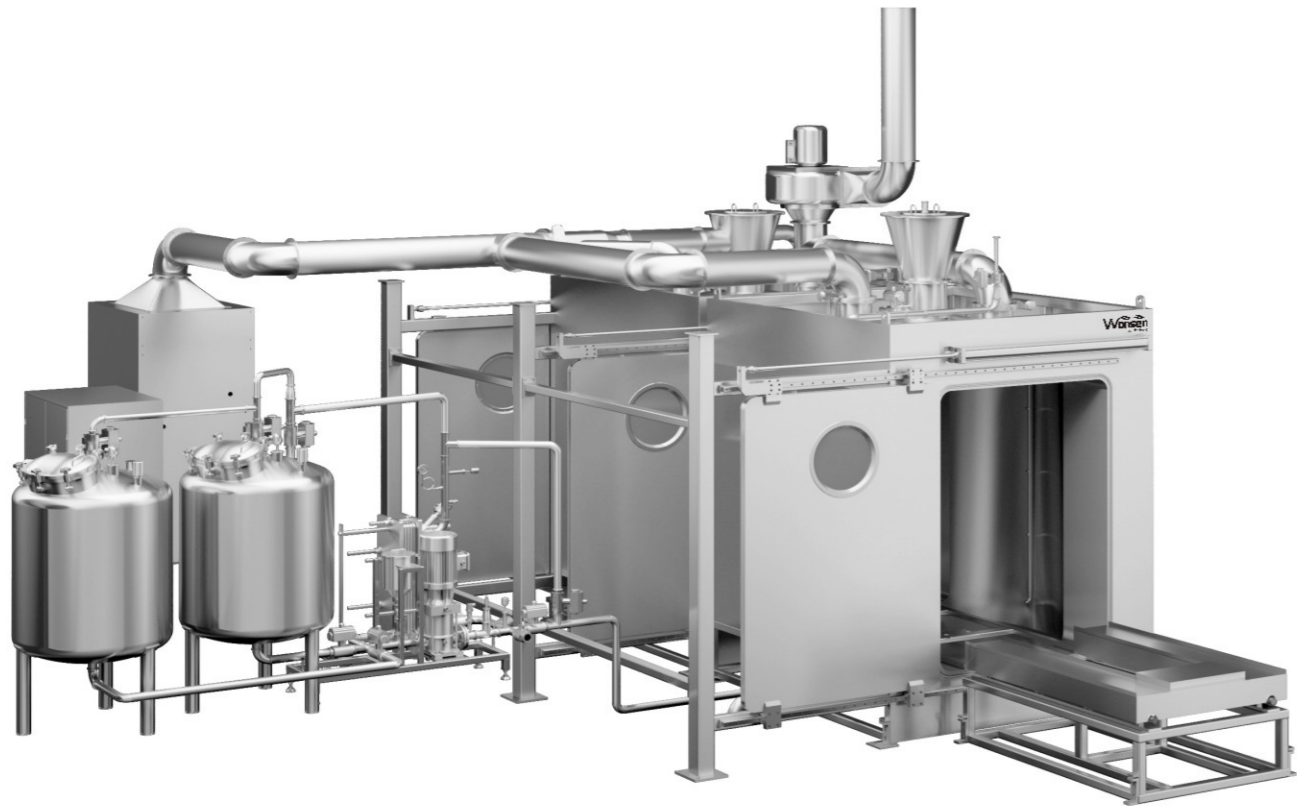

特点

- ▲ 为容器清洗提供统一的清洗标准，易于清洗过程的追溯和认证。
- ▲ 集自动输送、清洗、干燥、冷却于一体，全程由PLC控制，自动化程度高，操作简单。
- ▲ 清洗室进行清洗时，干燥室可同时进行料斗的干燥，两个腔室同时运行，提高生产效率。
- ▲ 自动记录运行参数，可验证运行结果。
- ▲ 符合药品生产的GMP要求。

Features

- ▲ It provides uniform cleaning standard for the cleaning of vessels and easily makes the traceability and certification of the cleaning process.
- ▲ It improves production efficiency.
- ▲ It reduces labor intensity of workers.
- ▲ The equipment is a machine integrating cleaning, drying and cooling functions. It adopts PLC control during the whole course, which is with high degree of automation and simple operation.
- ▲ The running parameters are recorded automatically to verify the running results.
- ▲ It fully meets GMP requirements.

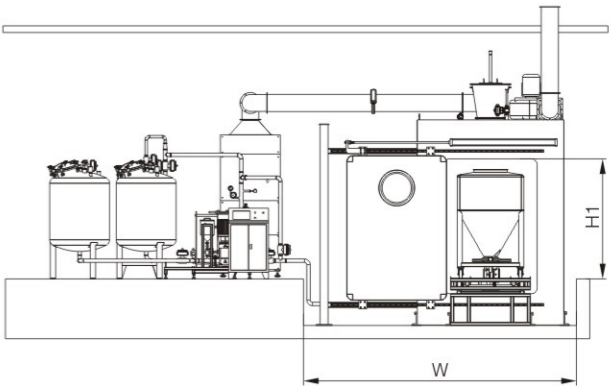
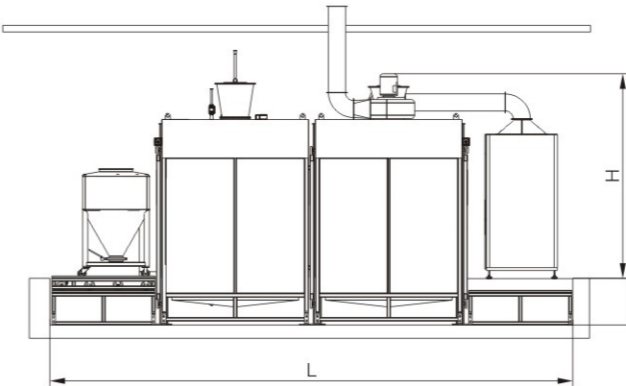

技术参数 Technical parameter

项目 Item	型号 Model	ZLXHS-600	ZLXHS-800	ZLXHS-1000	ZLXHS-1200	ZLXHS-1500	ZLXHS-2000
总功率 Total power(Kw)		14.25	14.25	14.25	14.25	14.25	14.25
水泵功率 Pump power(Kw)		4	4	4	4	4	4
水泵流量 Pump flow(t/h)		20	20	20	20	20	20
泵压力 Pump pressure(Mpa)		0.35	0.35	0.35	0.35	0.35	0.35
引风机功率 Induced draft fan power(Kw)		2.2	2.2	2.2	2.2	2.2	2.2
排风机功率 Exhaust fan power(Kw)		5.5	5.5	5.5	5.5	5.5	5.5
蒸汽压力 Steam pressure(Mpa)		0.4-0.6	0.4-0.6	0.4-0.6	0.4-0.6	0.4-0.6	0.4-0.6
蒸汽流量 Steam flow(kg/h)		1300	1300	1300	1300	1300	1300
压缩空气压力 Compressed air pressure(Mpa)		0.4-0.6	0.4-0.6	0.4-0.6	0.4-0.6	0.4-0.6	0.4-0.6
压缩空气耗量 Compressed air consumption(m³/min)		3	3	3	3	3	3
整机重量 Equipment weight(t)		6.6	6.6	7	7	7.2	7.2
外形尺寸 Outline dimensions (mm)	L	7000	7000	8100	8100	8100	8100
	H	2820	3000	3000	3240	3390	3730
	W	4100	4100	4100	4100	4600	4600
	H1	1600	1770	1800	1950	2100	2445
	H2	700	700	700	700	700	700

注：本公司可按用户要求定制生产
Note: Our company can customize products according to user requirements.

QXY 移动清洗机
Moveable cleaning machine

用途

我公司生产的移动清洗机结构紧凑，操作方便，密封性好，适用性强。适用于制药、食品、精细化工工业设备等需清洗清洁部位的清洗，是符合GMP要求设计制造的加工设备。

工作原理

借助于增压泵的压力来传送清洗液体和所需水源的混合物。通过不同的水源接口可以按需要控制不同的进水阀门进行水源接入，清洗剂由阀门调节加入量，混合后进入增压泵；在增压泵的作用下，在泵的压力范围内按泵的高度-流量性能表中的参数形成流量输出，输出的流量大小随压力的变化而变化。

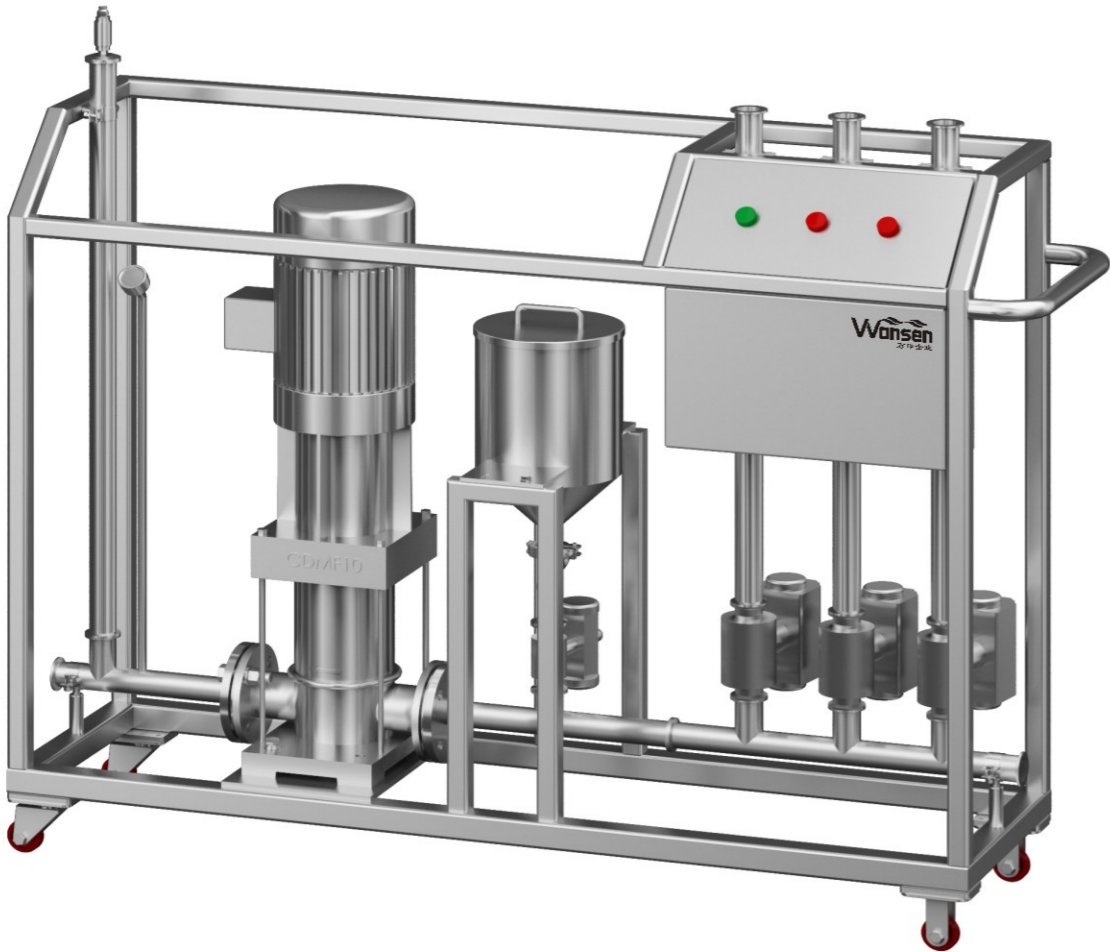

Application

With compact structure, convenient operation, good sealing performance and high adaptability, the moveable cleaning machine produced by our company is used for cleaning industrial equipment and other parts that require cleaning in medicine, food and fine chemical industries. It is a processing machine designed and manufactured in accordance with GMP requirements.

Work principle

The pressure in the boosting pump is used to convey the mixture of the cleaning liquid and the desired water source. Through different water source connections, different water inlet valves can be operated according to the needs to connect with water sources. The detergent adding volume is controlled by valve then enters to boosting pump after mixing. Under the action of the boosting pump, flow output is formed within the pressure range of the pump according to the parameters in the pump height-flow performance table. The output flow varies with the pressure.

特点

- ▲本设备可配置三路水管入口，可供用户多种选择；出水口可联接三通或四通接头，同时供几台机器使用，方便快捷。
- ▲本设备配置一个360度旋转的清洗喷头，和一把高压水枪，只要一个人操作便可完成料桶清洗流程。
- ▲本设备底部安装有脚轮，方便移动。
- ▲结构简洁，便于安装和拆卸。

Features

- ▲The machine can be equipped with three water pipe inlets for users to select. The water outlets can be connected to tees or crosses to clean several machines simultaneously, which is convenient and easy to operate.
- ▲The machine is equipped with a cleaning nozzle that can turn for 360° and a high-pressure water gun. The procedure of bin cleaning can be completed through the operation by just one person.
- ▲The machine is installed with castors at its bottom, which is easy to move.
- ▲It is featured by concise structure and easy installation and disassembly.

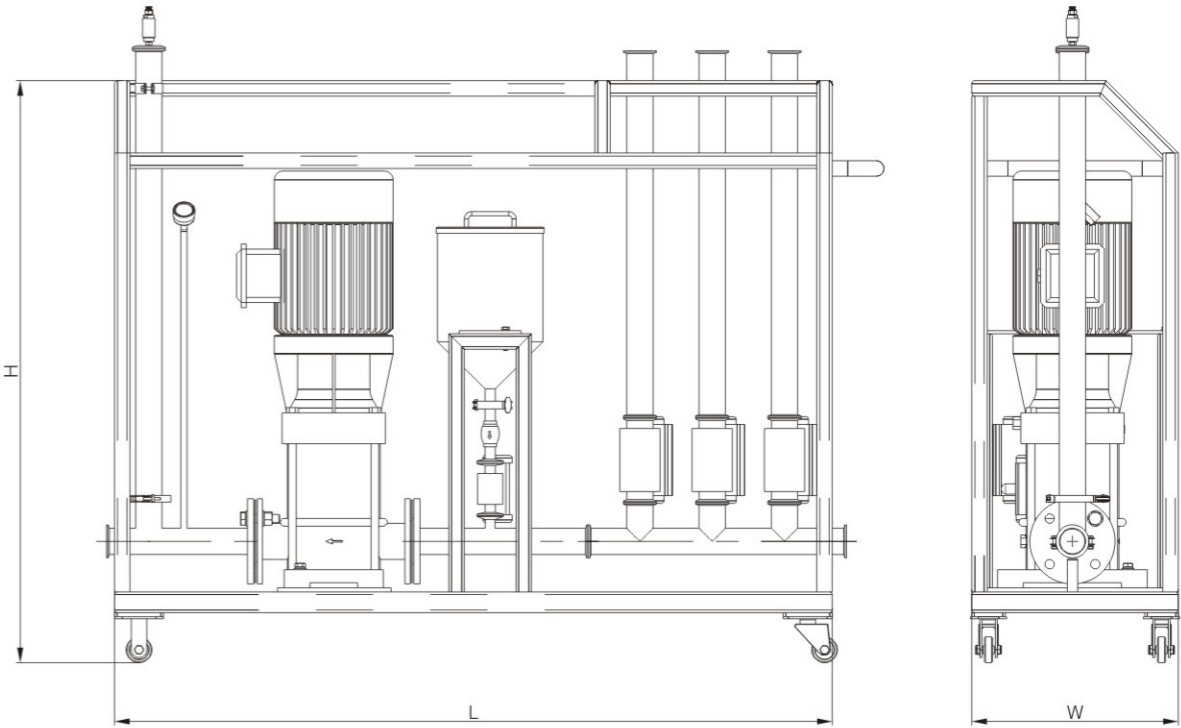

技术参数 Technical parameter

项目 Item	型号 Model	QXY-10	QXY-20
流量 Flow(T/h)		10	20
电机功率 Motor power(kw)		3.0	4.0
压力 Pressure(MPa)		0.62	0.35
设备重量 Equipment weight(kg)		100	125
外形尺寸 Outline dimensions (mm)	L	1490	1490
	W	400	400
	H	1150	1150

注：本公司可按用户要求定制生产
Note: Our company can customize products according to user requirements.

ZQX 在线清洗系统
CIP Cleaning system

用途

该机主要用于固体制剂生产过程中设备的在线清洗，与沸腾床、包衣机、湿法制粒机等设备配套使用。同时适用于制药、食品、精细化工等工业设备的清洗，是符合GMP要求设计制造的清洗设备。

工作原理

该机由增压泵、换热器、储水罐、控制系统等组成，借助于增压泵将各种水源加压后清洗设备内表面，热水水源由自来水经换热器加热后产生，清洗剂由阀门控制加入量，混合后进入增压泵。按工艺要求设定清洗程序，清洗完毕后按程序设定通入压缩空气将管道内的水吹干，清洗后的设备干燥后继续投入生产。



Application

The machine is mainly used for online cleaning of equipment in the production process of solid preparations, used together with equipment such as fluid bed machine, coating machine and wet mixing granulator. It is also suitable for the cleaning of industrial equipment such as pharmaceutical, food, fine chemicals, etc. It is a cleaning equipment designed and manufactured in accordance with GMP requirements.

Work principle

The machine is composed of booster pump, heat exchanger, water storage tank, control system and so on, and the various water source are pressurized by a booster pump to clean the inner surface of the device, Hot water source is generated by tap water heated by the heat exchanger. The cleaning agent is controlled by the valve to add the amount, entering to the booster pump after mixing. The cleaning procedure is set according to the process requirements. After the cleaning is completed, the compressed air is blown according to the program to dry the water in the pipeline, and the cleaned equipment is dried for future production.



特点

- ▲本设备选配换热器，无需用户提供热水水源。
- ▲出水口可连接多台设备，可供几台设备的在线清洗。
- ▲清洗程序，工艺等在触摸屏上设置与调用，自动化程序高，操作简单。

Features

- ▲This machine is optionally equipped with heat exchanger, if users have no hot water source.
- ▲The outlet can be connected to several devices for online cleaning.
- ▲Cleaning procedures, processes, etc. are set on the touch screen, the automation program is high, and the operation is simple.

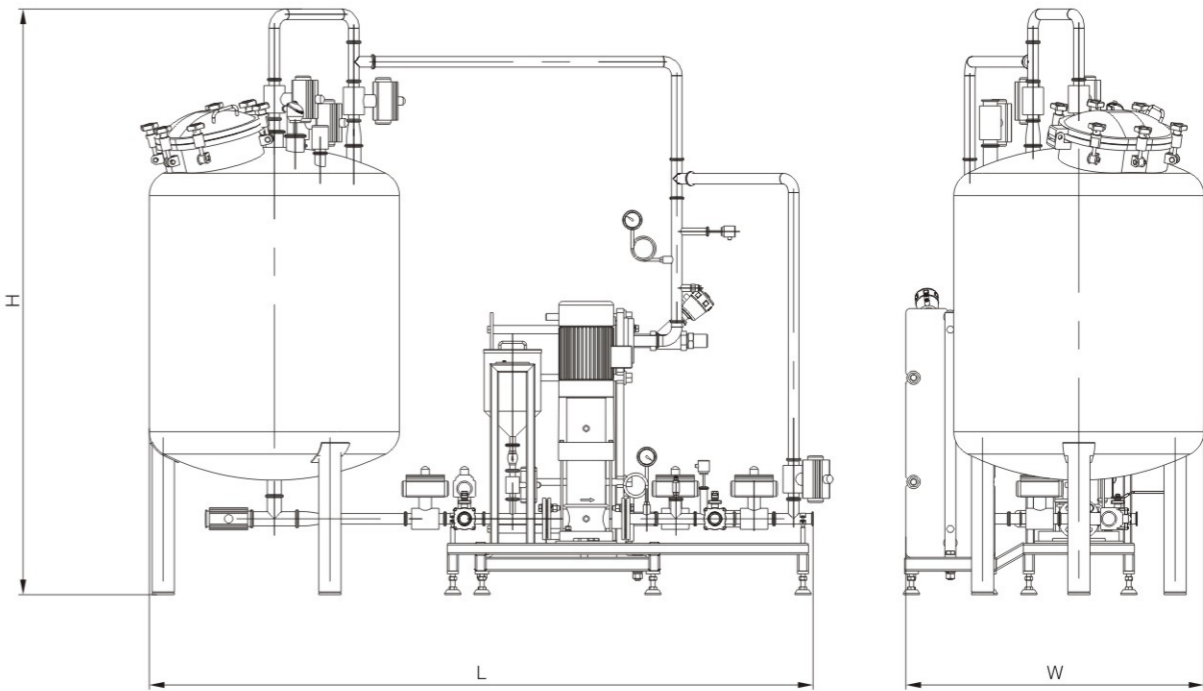

技术参数 Technical parameter

项目 Item	型号 Model	ZQX-10	ZQX-20
水泵流量 Pump flow(t/h)		10	20
水泵功率 Pump power(Kw)		3	4
泵压力 Pump pressure(Mpa)		0.62	0.35
蒸汽压力 Steam pressure(Mpa)		0.4-0.6	0.4-0.6
蒸汽流量 Steam flow(kg/h)		1300	1300
设备重量 Equipment weight(kg)		450	475
外形尺寸 Outline dimensions (mm)	L	2400	2500
	W	1075	1090
	H	2100	2100

注：本公司可按用户要求定制生产
Note: Our company can customize products according to user requirements.

周转料斗
IBC bins

HZTD单立柱混合周转料斗
SINGLE-COLUMN MIXING TRANSFER BIN

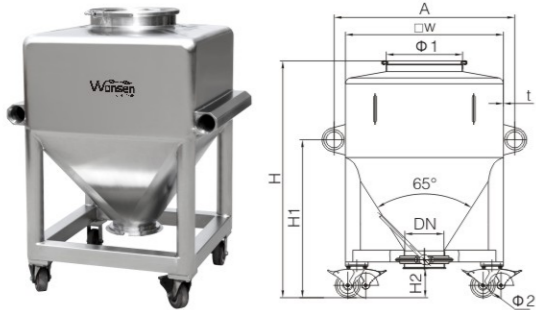

技术参数 Technical parameter

型号 Model	容积(L) Volume	W	H	H1	H2	A	t	Φ1	Φ2	DN	重量(kg) Weight
HZTD-100	100	550	920	635	180	640	2	300	100	150	155
HZTD-200	200	700	960	700	150	790	2	400	100	200	185
HZTD-300	300	720	1150	760	180	820	2.5	400	125	200	200
HZTD-400	400	800	1190	800	147	910	2.5	400	125	200	220
HZTD-600	600	1000	1300	960	161	1120	2.5	500	125	200	245
HZTD-800	800	1000	1500	960	150	1120	2.5	500	125	200	250
HZTD-1000	1000	1100	1630	1060	181	1220	3	500	125	200	265
HZTD-1200	1200	1200	1740	1160	200	1320	3	500	125	200	280

HZT全自动混合周转料斗
AUTOMATIC MIXING TRANSFER BIN

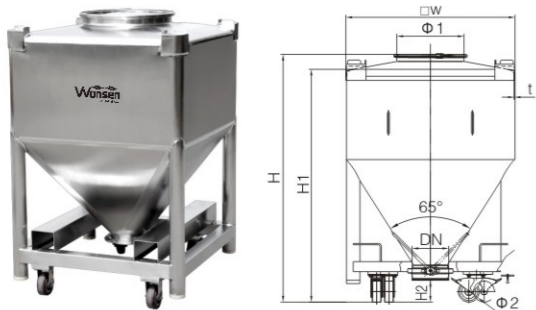

技术参数 Technical parameter

型号 Model	容积(L) Volume	W	H	H1	H2	t	Φ1	Φ2	DN	重量(kg) Weight
HZT-400	400	800	1270	1210	180	2.5	400	125	200	150
HZT-600	600	1000	1280	1210	130	2.5	400	125	200	185
HZT-800	800	1000	1480	1420	130	2.5	400	125	200	200
HZT-1000	1000	1180	1490	1430	130	3	500	150	200	245
HZT-1200	1200	1180	1640	1580	130	3	500	150	200	260
HZT-1500	1500	1180	1850	1780	130	3	500	150	200	280
HZT-2000	2000	1180	2210	2130	130	3	500	150	200	310

ZT方形周转料桶
SQUARE TRANSFER BIN

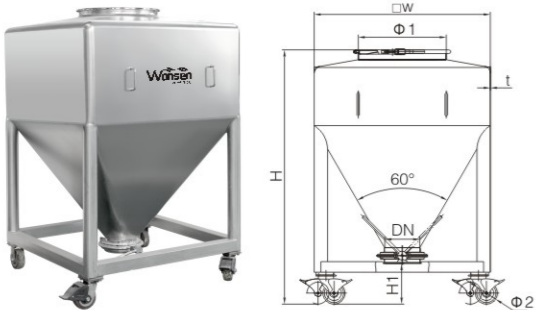

技术参数 Technical parameter

型号 Model	容积(L) Volume	W	H	H1	t	Φ1	Φ2	DN	重量(kg) Weight
ZT-200	200	600	1140	185	2	400	125	150	145
ZT-300	300	800	1180	210	2.5	400	125	200	160
ZT-400	400	800	1320	220	2.5	400	125	200	180
ZT-600	600	1000	1450	230	2.5	500	125	200	200
ZT-800	800	1000	1650	230	2.5	500	125	200	220
ZT-1000	1000	1200	1590	200	2.5	500	150	250	262
ZT-1200	1200	1200	1720	200	2.5	500	150	250	280
ZT-1500	1500	1200	1950	200	2.5	500	150	250	315
ZT-1800	1800	1200	2160	200	3	500	150	250	335
ZT-2000	2000	1200	2290	200	3	500	150	250	370

ZTY圆形周转料桶
ROUND TRANSFER BIN

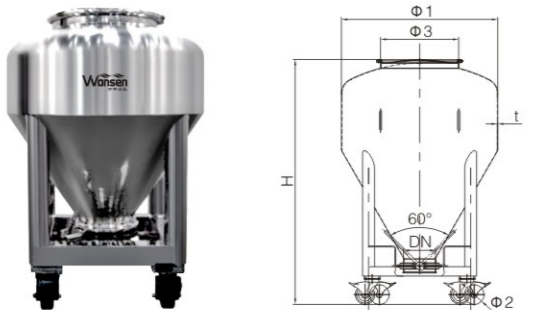

技术参数 Technical parameter

型号 Model	容积(L) Volume	H	t	Φ1	Φ2	Φ3	DN	重量(kg) Weight
ZTY-200	200	1050	2	750	125	400	200	89
ZTY-400	400	1287	2.5	850	125	400	200	126
ZTY-600	600	1457	2.5	1000	125	500	200	178
ZTY-800	800	1530	2.5	1100	125	500	200	190
ZTY-1000	1000	1615	2.5	1250	150	500	250	262

配件
Accessories



KGT料桶卡箍
DRUM CLAMP



料桶用卡箍
Clamp for drum



技术参数 Technical parameter

型号 Model	DN
KGT-500	500

KGF蝶阀卡箍
BUTTERFLY VALVE CLAMP



蝶阀用卡箍
Clamp for butterfly valve

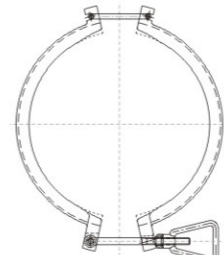

技术参数 Technical parameter

型号 Model	DN
KGF-150	150
KGF-200	200
KGF-250	250

KGD料斗卡箍
BIN CLAMP



料斗用卡箍
Clamp for bin



技术参数 Technical parameter

型号 Model	DN
KGD-400	400
KGD-500	500

KGG 管道卡箍
PIPE CLAMP



管道用卡箍
For pipeline connection

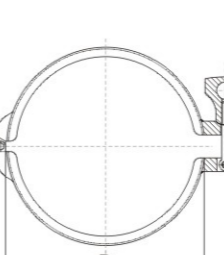

技术参数 Technical parameter

型号 Model	D
KGG-4	119
KGG-6	167
KGG-8	218
KGG-10	269
KGG-12	319

配件
Accessories

LT 不锈钢料桶
STAINLESS STEEL DRUM

配提升加料机及物料周转
For pharma lifter and material transferring



技术参数 Technical parameter

型号 Model	主要结构尺寸 Main structural dimensions	
	Φ D	h
LT-50	400	400
LT-100	500	500
LT-150	585	600

ZCQ 真空出料器
VACUUM DISCHARGER

料斗，容器真空出料
For bin/container vacuum discharging



技术参数 Technical parameter

型号 Model	主要结构尺寸 Main structural dimensions		
	Φ D	Φ D1	Φ D2
ZCQ-150-38	150	38	230
ZCQ-150-50	150	50	230
ZCQ-200-38	200	38	280
ZCQ-200-50	200	50	280
ZCQ-200-63	200	63	280
ZCQ-250-50	250	50	330
ZCQ-250-63	250	63	330

LTC 十字小车
CROSS CART

料桶搬运
For drum conveying

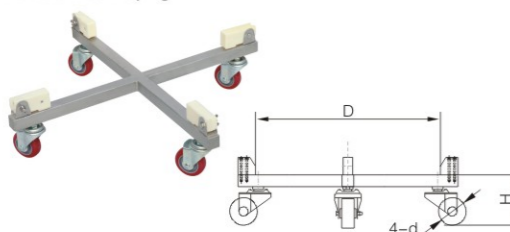

技术参数 Technical parameter

型号 Model	主要结构尺寸 Main structural dimensions		
	Φ D	H	Φ d
LTC-50	500	160	75
LTC-100	600	160	75

YXG Y型管
Y TYPE PIPE

配浆、制浆、保温、压片机等加料
Charging for paste preparing & pulping,
heat insulation tank, tablet press



技术参数 Technical parameter

型号 Model	主要结构尺寸 Main structural dimensions				
	Φ D1	Φ D2	Φ D3	L	H
YXG-150	150	219	100	829	510
YXG-200	200	269	150	829	645
YXG-250	250	269	200	795	480

DJL 硅胶接管
SILICONE CONNECTION PIPE

联接料斗加料
Connecting with bin to charge material



技术参数 Technical parameter

型号 Model	主要结构尺寸 Main structural dimensions		
	Φ D	Φ D1	H
DJL-150	175	145	170
DJL-150	225	195	170
DJL-250	275	245	170

α-β 阀门
VALVE

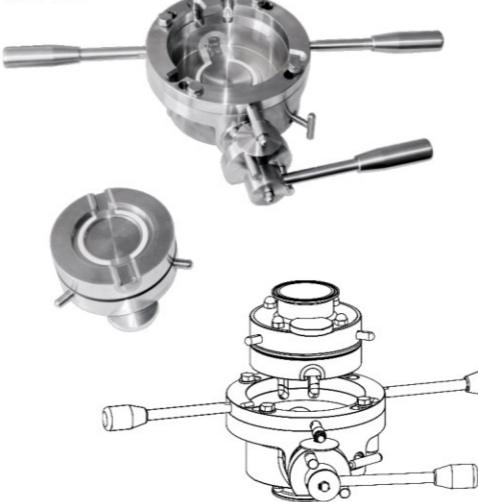

技术参数 Technical parameter

接口尺寸 Interface size		2.0"、2.5"、3.0"、4.0"、6.0"、8.0"
接口标准 Interface standard		Tri-clamp、PN6/PN10法兰
材质 Material	阀体材质 Valve material	316L(与介质接触部件Material contact parts) 304(不与介质接触部件Remaining parts)
	密封材质 Sealing material	白色氟化橡胶(标配)，符合FDA要求 White fluorinated rubber(Standard), Meet FDA requirements 三元乙丙橡胶、硅橡胶、全氟橡胶(选配) Ethylene-Propylene-Diene Monomer, Silicone rubber, Perfluoro rubber(Optional)
操作方式 Operating mode		手动、自动 Manual, Automatic
密封等级 Seal grade		OEB 4级 Level 4(OEL ≤ 10 μg/m³)
压力等级 Pressure rating		-0.1~+0.5Mpa
灭菌方式 Sterilization method		SIP
防爆等级 Anti-explosion level		ATEX II2 GD T4
选配附件 Optional accessories		主动压力塞、主动保护塞、主动清洗部件、被动压力盖、被动保护盖、被清洗部件 Active pressure plug, Active protection plug, Active cleaning unit, Passive pressure cap, Passive protective cover,leaned part
表面处理 Surface treatment		Ra < 0.4, 标配Standard(与介质接触部件Material contact parts) Ra < 0.8(不与介质接触部件Remaining parts)

DF 蝶阀
BUTTERFLY VALVE

输送，控制，配料斗
Used with bin to discharge and control material

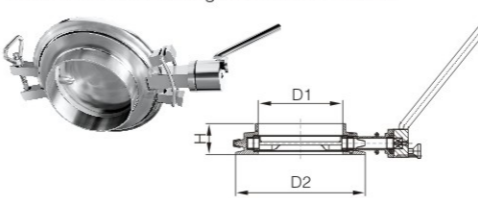

技术参数 Technical parameter

型号 Model	主要结构尺寸 Main structural dimensions		
	Φ D1	Φ D2	H
DF-150	150	230	55
DF-200	200	280	55
DF-250	250	330	60

FLG 分料盖
SUB-FEEDING BIN COVER

配料斗分料
Used with bin to sub-feed material



技术参数 Technical parameter

型号 Model	主要结构尺寸 Main structural dimensions		
	Φ D	Φ D1	Φ d
FLG-400-150	150	400	38
FLG-400-200	200	400	38
FLG-400-250	250	400	38
FLG-500-150	150	500	38
FLG-500-200	200	500	38
FLG-500-250	250	500	38